

**LG ■ The Energy Service Company**

The Lawrenceburg Gas Company  
230 West High Street  
Lawrenceburg, Indiana 47025-1910

RECEIVED

NOV 3 1994

IDEM - OER  
STATE CLEANUP

November 1, 1994

Indiana Department of Environmental Management  
Office of Environmental Response  
100 North Senate Avenue  
Room N-1255  
P.O. Box 6015  
Indianapolis, IN 46206-6015

Attention: Carla J. Gill  
Program Remediation Director  
Voluntary Remediation

Dear Ms. Gill

RE: VOLUNTARY CLEANUP APPLICATION  
LAWRENCEBURG GAS PLANT SITE

Enclosed please find a completed application for entry into the Voluntary Cleanup Program for our Lawrenceburg Gas Plant Site in Lawrenceburg, Indiana.

Also enclosed is a check for \$1,000.00 for the application fee.

If you have any questions on this application, please contact Jim Stieritz at (513) 287-2269.

Very truly yours,

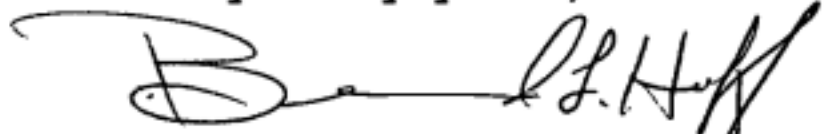

BERNARD L. HUFF, Director  
Environmental Division  
Licensing and Environmental  
Affairs Department

JJS:lp

Enclosures

cc: Robert Glennon, Indiana UCC  
Michael Gahimer, Indiana UCC



111A



INDIANA DEPARTMENT OF ENVIRONMENTAL MANAGEMENT  
OFFICE OF ENVIRONMENTAL RESPONSE  
100 NORTH SENATE AVENUE, RM N-1255  
P. O. BOX 8016  
INDIANAPOLIS, INDIANA 46208-8016  
317/233-6362

# INDIANA VOLUNTARY REMEDIATION

## APPLICATION

### PART 1 - SITE LOCATION AND INSPECTION INFORMATION

Account Number 2880 110000
ID NUMBER (IDEM USE ONLY) 6941101

<b>I. SITE NAME AND LOCATION</b>					
01 SITE NAME (Legal, common, or descriptive name of area) Lawrenceburg Gas Company			02 STREET, ROUTE NO., OR SPECIFIC LOCATION IDENTIFIER 336 Second Street		
03 CITY Lawrenceburg	04 STATE IN	05 ZIP CODE 47025	06 COUNTY Dearborn		
07 TOWNSHIP, RANGE, AND SECTION AND UNIVERSAL TRANSVERSE MERCATOR T 5 N. R 1 W. Section 15. 06 85.22, 43 29.20			08 EPA IDENTIFICATION NO. IN0000596031		
<b>II. INSPECTION INFORMATION</b>					
01 DATE OF INSPECTION 06 / 08 / 94		02 SITE STATUS <input type="checkbox"/> ACTIVE <input checked="" type="checkbox"/> INACTIVE		03 YEARS OF OPERATION *possibly earlier 1885* BEGINNING YEAR      ENDING YEAR      UNKNOWN	
<b>III. OWNER/OPERATOR IDENTIFICATION</b>					
01 OWNER Lawrenceburg Gas Company			07 OPERATOR Lawrenceburg Gas Company		
02 OWNER ADDRESS Rm. 552-A, P.O. Box 960			08 OPERATOR ADDRESS Rm. 552-A, P.O. Box 960		
03 CITY Cincinnati			09 CITY Cincinnati		
04 STATE OH	05 ZIP CODE 45201	06 TELEPHONE 613) 287-2269	10 STATE OH	11 ZIP CODE 45201	12 TELEPHONE 613) 287-2269
<b>IV. SITE DESCRIPTION AND OPERATIONAL HISTORY</b>					
01 BRIEF DESCRIPTION AND OPERATIONAL HISTORY OF SITE Coal gas was manufactured on the site from 1885, and possibly earlier, to 1938. Gas was produced by the destructive distillation of coal in sealed retorts. Butane air gas was produced following the cessation of coal gas manufacturing until sometime prior to 1956. The site is currently used as a construction and maintenance facility for Lawrenceburg Gas Company.					
02 EXTENT OF IDEM SERVICE DESIRED (CHECK ALL THAT APPLY) <input type="checkbox"/> INVESTIGATION OVERSIGHT <input checked="" type="checkbox"/> REMEDIATION OVERSIGHT <input checked="" type="checkbox"/> CERTIFICATE OF COMPLETION <input checked="" type="checkbox"/> COVENANT NOT TO SUE					
03 SITE INVESTIGATION <input type="checkbox"/> NONE <input type="checkbox"/> ONGOING <input checked="" type="checkbox"/> COMPLETE			04 SITE REMEDIATION <input checked="" type="checkbox"/> NONE <input type="checkbox"/> ONGOING <input type="checkbox"/> COMPLETE		
<b>V. CONTACT INFORMATION</b>					
01 AGENCY/ORGANIZATION Lawrenceburg Gas Company					
02 CONTACT James J. Stieritz					
03 ADDRESS Rm. 552-A, P.O. Box 960, Cincinnati, OH 45201					
04 TELEPHONE 613) 287-2269					

## PART 2 - WASTE INFORMATION

### I. HAZARDOUS SUBSTANCES/PETROLEUM - QUANTITIES & CHARACTERISTICS

<p><b>01 PHYSICAL STATES</b> (Check all that apply)</p> <p><input checked="" type="checkbox"/> A. SOLID                      <input type="checkbox"/> E. SLURRY</p> <p><input type="checkbox"/> B. POWDER, FINES           <input type="checkbox"/> F. LIQUID</p> <p><input checked="" type="checkbox"/> C. SLUDGE                   <input type="checkbox"/> G. GAS</p> <p><input type="checkbox"/> D. OTHER _____ (Specify)</p>	<p><b>02 WASTE/PETROLEUM QUANTITY AT SITE</b> (Measure of waste quantities must be independent)</p> <p>TONS <u>5100</u></p> <p>CUBIC YARDS _____</p> <p>NO. OF DRUMS _____</p>	<p><b>03 UNUSUAL SITE HAZARDS</b> (check if any apply)</p> <p><input type="checkbox"/> A. Radioactive Material                      <input type="checkbox"/> D. Explosive Material</p> <p><input type="checkbox"/> B. Infectious Material                          <input type="checkbox"/> E. Reactive Material</p> <p><input type="checkbox"/> C. Confined Areas with Potential for Gas Accumulation                      <input type="checkbox"/> F. Other Unusual Hazards _____</p> <p>EXPLAIN HAZARDS IN SUMMARY (Part 6)</p>
---	--	--

## II. HAZARDOUS SUBSTANCES/PETROLEUM TYPE (Check all that apply)

CATEGORY	SUBSTANCE NAME	01 GROSS AMOUNT	02 UNIT OF MEASURE	03 COMMENTS
SLU	SLUDGE	40	TN	
OLW	ONLY WASTE			
SOL	SOLVENTS			
PST	PESTICIDES			
OCC	OTHER ORGANIC CHEMICALS	5060	TN	PAH and CN contaminated soil
IOC	INORGANIC CHEMICALS			
ACD	ACIDS			
BAS	BASES			
MES	HEAVY METALS			
PET	GASOLINE			
	FUEL OIL			
	OTHER PET. SUB. (Specify)			

### III. HAZARDOUS CONSTITUENTS/PETROLEUM TYPE

[illegible]

\*earthen structure, below ground

## PART 3 - PERMIT/CONDITION AND DESCRIPTIVE INFORMATION

I.D. NUMBER (USE ONLY)

## I. PERMIT/CONDITION INFORMATION

ARE YOU REQUIRED TO INVESTIGATE OR REMEDIATE THIS SITE BY ANY PERMIT CONDITION, ENFORCEMENT ACTION, COMMISSIONER'S ORDER, OR CONDITION OF ANY OTHER RULE? ☐ YES ☒ NO IF YES, PROVIDE INFORMATION REQUESTED BELOW

DOES YOUR FACILITY HAVE NOW OR EVER HAD A RCRA PERMIT OR RCRA INTERIM STATUS? ☐ YES ☒ NO IF YES, PROVIDE INFORMATION REQUESTED BELOW

01 TYPE OF PERMIT/CONDITION	02 PERMIT/CONDITION IDENTIFICATION	03 DATE ISSUED	04 EXPIRATION DATE	05 COMMENTS

## II. SITE DESCRIPTION

01 STORAGE/ DISPOSAL (check all that apply) <input type="checkbox"/> A. SURFACE IMPOUNDMENT <input type="checkbox"/> B. PILES <input type="checkbox"/> C. DRUMS ABOVE GROUND <input type="checkbox"/> D. TANK ABOVE GROUND <input type="checkbox"/> E. TANK BELOW GROUND <input type="checkbox"/> F. LANDFILL <input type="checkbox"/> G. LANDFARM <input type="checkbox"/> H. OPEN DUMP <input checked="" type="checkbox"/> I. OTHER <u>see comment</u> <small>(specify)</small>	02 AMOUNT          	03 UNIT OF MEASURE          	04 TREATMENT (check all that apply) <input type="checkbox"/> A. INCINERATION <input type="checkbox"/> B. UNDERGROUND INJECTION <input type="checkbox"/> C. CHEMICAL PHYSICAL <input type="checkbox"/> D. BIOLOGICAL <input type="checkbox"/> E. WASTE OIL PROCESSING <input type="checkbox"/> F. SOLVENT RECOVERY <input type="checkbox"/> G. OTHER RECYCLING/RECOVERY <input type="checkbox"/> H. OTHER _____ <small>(specify)</small>	05 OTHER <input checked="" type="checkbox"/> A. BUILDINGS ON SITE          
06 AREA OF SITE          				06 COMMENTS          

## 07 COMMENTS

Earthen Structure 40 TN  
 Contaminated Soil 5060 TN

Material of concern is primarily shallow soil which has been contaminated as a result of historical activities. Some material (40 tons) is contained in an earthen structure which remains from historical operations (i.e., prior to 1938).

## III. CONTAINMENT

01 CONTAINMENT OF WASTES /PETROLEUM (check area)

☐ A. ADEQUATE SECURE ☒ B. MODERATE ☐ C. INADEQUATE POOR ☐ D. INSECURE, UNSOUND, DANGEROUS

02 DESCRIPTION OF DRUMS, DIKING, LINERS, BARRIERS, ETC.

See Comment 07 above

## IV. ACCESSIBILITY

01 WASTE/PETROLEUM EASILY ACCESSIBLE: ☒ YES ☐ NO

## 02 COMMENTS

The wastes are fairly easily accessible, at relatively shallow depths below ground surface. The building located on the site may be a limiting factor during remediation.

## V. ENFORCEMENT INFORMATION

01 PAST REGULATORY/ENFORCEMENT ACTION ☐ YES ☒ NO

02 DESCRIPTION OF FEDERAL, STATE, LOCAL REGULATORY/ENFORCEMENT ACTION

None

## PART 4 - DESCRIPTION OF CONDITIONS AND INCIDENTS

I.D. NUMBER (OPTIONAL)

CONDITIONS AND INCIDENTS		
01 GROUND WATER CONTAMINATION NARRATIVE DESCRIPTION  None	OBSERVED (DATE: ___/___/___)	<input type="checkbox"/> POTENTIAL
02 SURFACE WATER CONTAMINATION NARRATIVE DESCRIPTION  None	OBSERVED (DATE: ___/___/___)	<input type="checkbox"/> POTENTIAL
03 DRINKING WATER CONTAMINATION NARRATIVE DESCRIPTION  None	OBSERVED (DATE: ___/___/___)	<input type="checkbox"/> POTENTIAL
04 CONTAMINATION OF AIR NARRATIVE DESCRIPTION  None	OBSERVED (DATE: ___/___/___)	<input type="checkbox"/> POTENTIAL
05 CONTAMINATION OF SOIL NARRATIVE DESCRIPTION Contractors working for the Lawrenceburg Gas Company exposed a tar-like substance during the process of building a parking area on the site. A tar-like substance came to the surface when heavy equipment was grading the area. Approximately 40 cubic yards may have been affected.	OBSERVED (DATE: 02/11/94)	<input type="checkbox"/> POTENTIAL
06 DIRECT CONTACT NARRATIVE DESCRIPTION  None	OBSERVED (DATE: ___/___/___)	<input type="checkbox"/> POTENTIAL
07 FIRE/EXPLOSIVE CONDITIONS NARRATIVE DESCRIPTION  None	OBSERVED (DATE: ___/___/___)	<input type="checkbox"/> POTENTIAL
08 IMPACT TO OFF-SITE PROPERTY NARRATIVE DESCRIPTION  None	OBSERVED (DATE: ___/___/___)	<input type="checkbox"/> POTENTIAL
09 CONTAMINATION OF SEWERS STORM DRAINS, WWTP NARRATIVE DESCRIPTION  None	OBSERVED (DATE: ___/___/___)	<input type="checkbox"/> POTENTIAL
10. UNAUTHORIZED DISPOSAL/STORAGE NARRATIVE DESCRIPTION  None	OBSERVED (DATE: ___/___/___)	<input type="checkbox"/> POTENTIAL



## PART 5 - WATER, DEMOGRAPHIC, AND ENVIRONMENTAL DATA

LD NUMBER (USE ONLY)

## I. DRINKING WATER SUPPLY

01 TYPE OF DRINKING SUPPLY  
(Check as applicable)

	SURFACE	WELL
MUNICIPAL	A. <input type="checkbox"/>	B. <input checked="" type="checkbox"/>
PRIVATE	C. <input type="checkbox"/>	D. <input type="checkbox"/>

02 TOTAL POPULATION WITHIN  
ONE (1) MILE OF SITE

6,000

No. of Persons

03 DISTANCE TO SITE

A. \_\_\_\_\_ (mi)

B. 0.25 (mi)

## II. GROUND WATER

01 GROUND WATER USE IN VICINITY (Check one)

- ☐ A. ONLY SOURCE FOR DRINKING
- ☐ B. DRINKING  
(Other sources available)
- ☒ C. COMMERCIAL, INDUSTRIAL, IRRIGATION  
(Other sources available)
- ☐ D. COMMERCIAL, INDUSTRIAL, IRRIGATION  
(No other water sources available)
- ☐ E. NOT USED, UNUSEABLE

02 POPULATION SERVED BY GROUND WATER 5,000

03 DISTANCE TO NEAREST DRINKING WATER WELL 0.25 (mi)

04 DEPTH TO GROUND WATER

31 to 34 (ft)

05 DIRECTION OF GROUND WATER FLOW  
(Indicate if regional or local)

NNE, Regional

06 DEPTH TO AQUIFER  
OF CONCERN

28 to 34 (ft)

07 POTENTIAL YIELD  
OF AQUIFER

5,000,000 (gpd)

08 SOLE SOURCE  
AQUIFER☒ YES ☐ NO

09 DESCRIPTION OF WELLS (Including usage, depth, and location relative to population and buildings)

Specific locations for 14 of the 25 wells in the site vicinity were available. Eleven of the fourteen wells are within one mile of the site. The wells are located throughout the city of Lawrenceburg and in the municipal well field north of Lawrenceburg. Twelve of the 25 wells have industrial uses. The purpose of two of the wells is for a geothermal HVAC system. One of the wells is a dewatering well. Public supply wells make up four of the 25 wells in the site vicinity. The usages are not indicated on six of the wells records. The depths of the wells vary from 47 feet to 149 feet.

## III. SURFACE WATER

01 SURFACE WATER USE (Check one)

- ☒ A. RESERVOIR, RECREATION  
DRINKING WATER SOURCE
- ☐ B. IRRIGATION, ECONOMICALLY  
IMPORTANT RESOURCES
- ☐ C. COMMERCIAL, INDUSTRIAL
- ☐ D. NOT CURRENTLY USED

02 AFFECTED/POTENTIALLY AFFECTED BODIES OF WATER

NAME:

AFFECTED

DISTANCE TO SITE

Tanners Creek

☐

0.11 (mi)

Ohio River

☐

0.52 (mi)

☐

(mi)



PART 6 - SUMMARY AND/OR CONCLUSIONS

I. Do the conditions regarding hazardous substances or petroleum, as described in this application, constitute an imminent or substantial threat to human health or the environment? ☐ YES ☒ NO (explain in summary below)

II. SUMMARY AND/OR CONCLUSIONS (See instructions, limit to 150 words)

A field investigation was conducted at the site in June and July, 1994. Surface and subsurface soil samples and groundwater samples were collected and analyzed for MGP constituents. The site is not seriously contaminated; at several locations constituent levels exceeded the Residential Tier II Cleanup Goals and at two locations parameters were above the Non-Residential Tier II Cleanup Goals. The contaminants detected above cleanup goals included benzo(a)anthracene, benzo(a)pyrene, and cyanide. No groundwater contamination was detected above the Residential or Non-Residential Cleanup Goals. The tar-like substance would be classified as a hazardous waste. The potential for human exposure to contamination at the site is low and access to the site is restricted by a fence. The north and south boundaries of contamination are clearly defined.

III. SOURCE OF INFORMATION (attach additional page(s) if necessary)

Site Investigation Report, Lawrenceburg MGP Site, Lawrenceburg, Indiana, by Atlantic Environmental Services, Inc., September 1994.

Lawrenceburg Municipal Utilities, Scott Stern, Water Superintendent.

PART 7 - GENERAL SITE INFORMATION

I.D. NUMBER (ITEM USE ONLY)

I. SITE SKETCH:

(Show all pertinent features; indicate sources and closest targets)

II. LEGAL DESCRIPTION:

PART 8 - STATEMENT OF CERTIFICATION

George H. Stinson

I, President-Cincinnati Gas & Electric, do hereby attest and  
(Print or Type Name)

certify that the information included herein is, to the best of  
my knowledge and belief, accurate and complete.

G. H. Stinson

Signature

10/31/94

Date

(Attach additional site information & photographs)

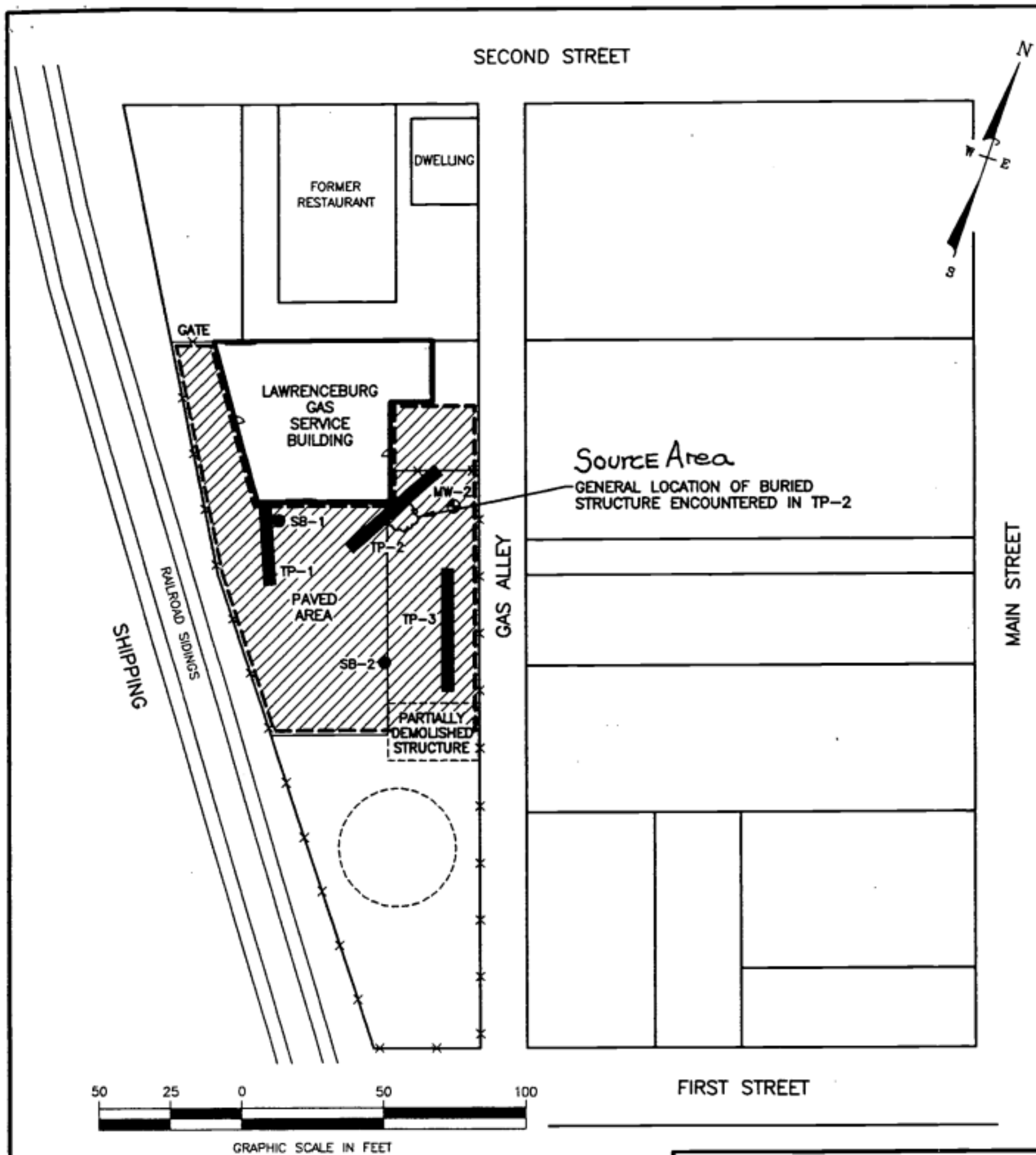

LEGEND	
	APPROXIMATE LIMITS OF SUBSURFACE SOIL CONTAMINATION (6-14 FEET)
	TP-1 TEST PIT LOCATION
	SB-1 SOIL BORING LOCATION
	MW-1 MONITORING WELL LOCATION
	CHAIN LINK FENCE

ATLANTIC ENVIRONMENTAL SERVICES, INC.	
SUBSURFACE SOIL CONTAMINATION LAWRENCEBURG MGP SITE LAWRENCEBURG, INDIANA	
LAWRENCEBURG GAS COMPANY PROJECT NO. 2018-01-03	
SCALE: 1"=50'	DRN BY: ROK
DATE: SEPT 94	CHK BY:
FIGURE 7-3	