

From: [Goodman, Stephanie](#)
To: [IDEM OLO Solid Waste Permits Submittals](#)
Cc: [Waninger, Scott E](#); [Goodman, Stephanie](#)
Subject: United Refuse 02-03 Probe Exceedance 7 day notice and Remediation Plan
Date: Tuesday, June 25, 2024 2:30:20 PM
Attachments: [URL Gas Probe 7 day letter 6 25 24 Final.pdf](#)

**** This is an EXTERNAL email. Exercise caution. DO NOT open attachments or click links from unknown senders or unexpected email. ****

Attached is the 7 day notification and remediation plan for the probe exceedance at United Refuse Landfill 02-03 in Fort Wayne, IN.

Stephanie Goodman

Environmental Manager

National Servall Landfill and United Refuse Landfill, Fort Wayne, IN
Williams County Landfill, Bryan, OH
Celina Landfill, Celina, OH

6231 MacBeth Road
Fort Wayne, IN 46809

e sgoodman@republicservices.com

o 260-442-3239

c 260-450-3043

w RepublicServices.com



Sustainability in Action



Sustainability in Action

June 25, 2024

Mr. Scott Waninger
Indiana Department of Environmental Management
Office of Land Quality
100 North Senate Avenue
Indianapolis, Indiana 46204

Re: Gas Probe Exceedance Seven Day Submittal
United Refuse Landfill, Allen County
SW Program ID 02-03

Dear Mr. Waninger:

On June 18, 2024, the United Refuse Landfill discovered explosive gas concentrations above the LEL action level at gas monitoring probes GP102 and GP104 during the routine 2nd quarter monitoring event. On June 18, 2024, IDEM was notified via email of these exceedances in accordance with Section 7 of the Site's approved Methane Monitoring Plan (MMP). This letter has been prepared to act as the seven (7) day documentation of the exceedance and steps to protect human health and the environment. This submittal will also serve as the proposed remediation plan that is required to be submitted within 60 days after the detection.

The two gas probes in question are located on the east side of the landfill near the outside edge of the perimeter road approximately 30 to 40 feet from the waste limit. In accordance with Section 8 of the MMP (Remedy Proposal), on June 24, 2024, SCS Field Services performed one punch bar test at each probe approximately ten (10) feet east towards the perimeter boundary from the two (2) gas probes in question to determine the extent of the gas plume. Explosive gas concentrations at the two (2) punch bar locations were found to be 0.0% and 0.0% at three and a half (3 ½) feet in depth. Additionally, the explosive gas concentrations at the gas probe GP103 (1.1%) located between GP102 and GP104 and the probe south of GP104 (GP105 (0.2%)) did not report explosive



Sustainability in Action

gas exceedances. Therefore, the gas plume appears to be contained within the facility property.

Evaluation of the source of gas appears to be related to a change in environmental conditions. The gas probes are located within 30 to 40 feet of the waste limits, so migration can be detected quickly due to close proximity. The spring months recorded record rainfalls of 13 inches plus. The month of June has been much drier. The change in environmental conditions (increase and reduction of liquids) potentially blocks pathways and then opens pathways allowing gas to migrate to the probes periodically.

The proposed/completed remediation plan consists of the following action items:

1. Increase vacuum on gas wells on the east side of the landfill.
2. Perform weekly gas probe readings until the explosive gas levels drop below the 5% regulatory threshold.
3. Once four (4) consecutive weekly readings in the gas probes all show explosive gas readings below the 5% threshold, we propose to perform monthly readings until the next scheduled quarterly event and then continue on the standard quarterly schedule from that point on per the MMP.
4. If the explosive gas readings continue to exceed regulatory limits for two (2) consecutive quarters of monitoring after the above plan has been implemented, the Site will evaluate the existing gas extraction system to determine if modifications are necessary to correct the issue.

If you have any questions or need additional information, please contact me at (260) 450-3043.

Sincerely,
REPUBLIC SERVICES OF INDIANA, LP



Sustainability in Action

Stephanie Goodman

Stephanie Goodman
Environmental Manager

Encl: Punch Bar Testing Results
Site Environmental Map

cc: Sean Conklin, Landfill Operations Manager (email)
Kira Wren, IDEM Solid Waste Permit Manager (email)

ENVIRONMENTAL MANAGEMENT PLAN

UNITED REFUSE LANDFILL

JANUARY 2024

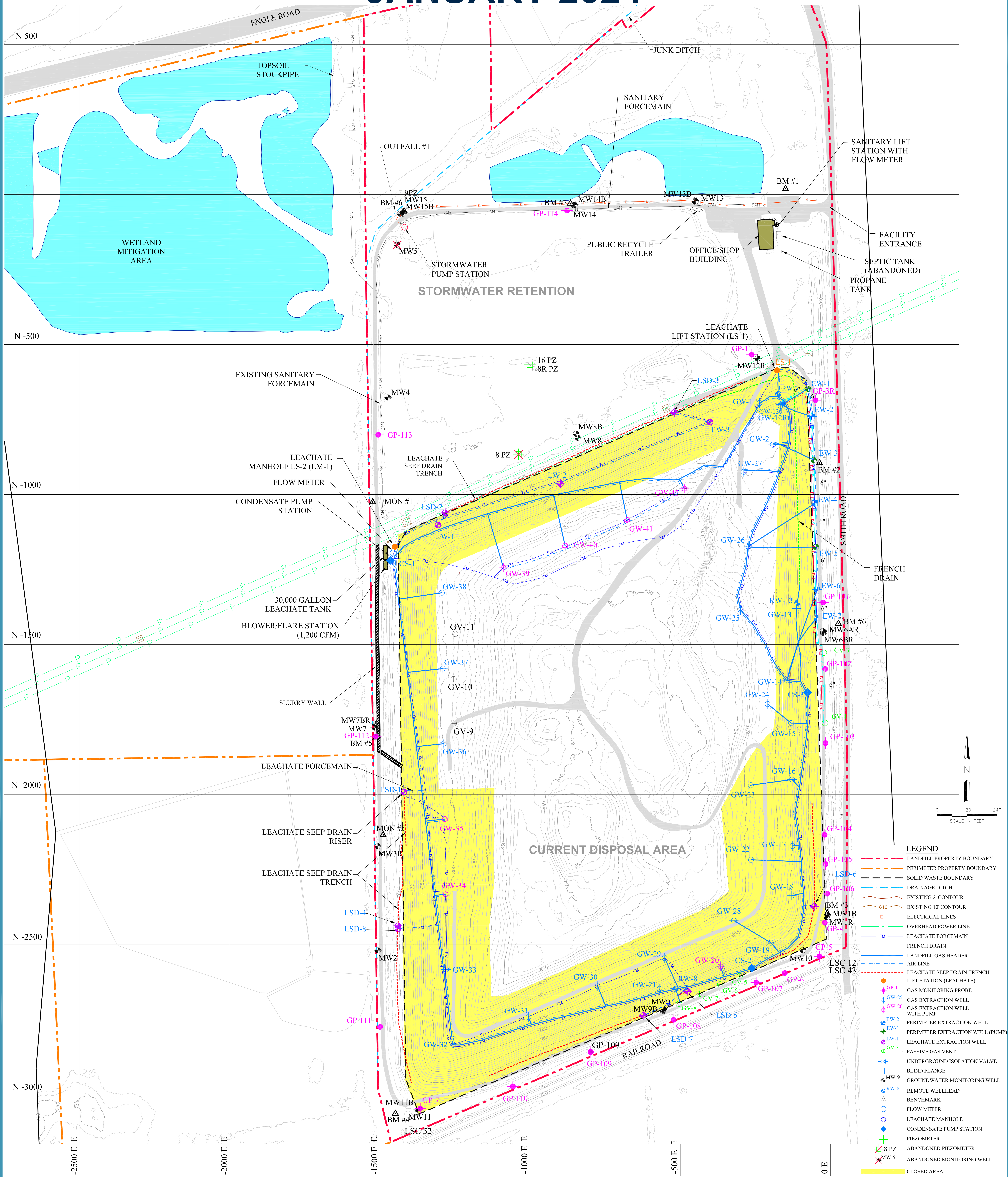

Device ID	Date/Time	CH4	CO2	O2	Balance	%LEL	Init. Static Press.	Adj. Static Press.	Init. Diff. Press.	Adj. Diff. Press.	Baro. Press.	Sys. Press.
GEM™5000;		%	%	%	%	%	inches H2O	inches H2O	inches H2O	inches H2O	inches Hg	inches H2O
URLFCAL1	6/24/2024 7:33	14.9	15	0	70.1	>>>>	N/A	N/A	N/A	N/A	N/A	N/A
URLFCAL2	6/24/2024 7:36	0	0.1	4	95.9	0	N/A	N/A	N/A	N/A	N/A	N/A
URGP0102	6/24/2024 8:12	66.2	31.2	0	2.6	>>>>	N/A	N/A	N/A	N/A	29.08	N/A
Punchbar102	6/24/2024 8:22	0	0.4	20.5	79.1	0	-0.05	-0.06	0.01	0.009	29.1	-0.06
URGP0104	6/24/2024 8:26	14	8.8	16	61.2	>>>>	N/A	N/A	N/A	N/A	29.12	N/A
Punchbar104	6/24/2024 8:32	0	0.2	20.9	78.9	0	-0.07	-0.07	0.018	0.015	29.12	-0.07