

ADDITIONAL INFORMATION



089-47394-00490

Indiana Sugars, Inc.
911 Virginia Street
Gary, IN 46401

219.886.9151
Fax 219.886.5124
www.sugars.com

August 23, 2019

IDEM Permits Administration and
Support Section, Office of Air Quality
100 North Senate Avenue
MC 61-35, Room 1003
Indianapolis, IN 46204

RE: Air Permit Renewal
Indiana Sugars, Inc.
Gary, Indiana
MSOP MO89-34016-00490

Received
State of Indiana
JAN 16 2024
Dept of Environmental Mgmt
Office of Air Quality

Dear Permit Writer:

Indiana Sugars, Inc. is operating under a Minor Source Permit (MSOP) for its facility in Gary, Indiana (Operation Permit No. MO89-34016-00490) Indiana Sugar is requesting a renewal of this permit. Indiana Sugars is requesting that the Authorized Individual/Responsible Official be changed to Jeremy Renteria. There has been no change in equipment or manufacturing process as of the previous permit modifications (089-41863-00490).

If you or your staff have any questions or need any additional information please contact me at (219) 886-9151 or by email at rexa@buysugars.com

Sincerely,

Rex Anderson
Maintenance Manager

cc: Jeremy Renteria, jeremyr@buysugars.com



AIR PERMIT APPLICATION COVER SHEET
 State Form 50639 (R4 / 1-10)
 INDIANA DEPARTMENT OF ENVIRONMENTAL MANAGEMENT

IDEM – Office of Air Quality – Permits Branch
 100 N. Senate Avenue, MC 61-53 Room 1003
 Indianapolis, IN 46204-2251
 Telephone: (317) 233-0178 or
 Toll Free: 1-800-451-6027 x30178 (within Indiana)
 Facsimile Number: (317) 232-6749
www.IN.gov/idem

NOTES:

- The purpose of this cover sheet is to obtain the core information needed to process the air permit application. This cover sheet is required for all air permit applications submitted to IDEM, OAQ. Place this cover sheet on top of all subsequent forms and attachments that encompass your air permit application packet.
- Submit the completed air permit application packet, including all forms and attachments, to **IDEM Air Permits Administration** using the address in the upper right hand corner of this page.
- IDEM will send a bill to collect the filing fee and any other applicable fees.
- Detailed instructions for this form are available on the Air Permit Application Forms website.

FOR OFFICE USE ONLY	
PERMIT NUMBER:	
DATE APPLICATION WAS RECEIVED:	

1. Tax ID Number: [REDACTED]

PART A: Purpose of Application		
Part A identifies the purpose of this air permit application. For the purposes of this form, the term "source" refers to the plant site as a whole and NOT to individual emissions units.		
2. Source / Company Name:	Indiana Sugars, Inc.	3. Plant ID: 089 – 0490
4. Billing Address:	911 Virginia Street	
City:	Gary	State: IN ZIP Code: 46402 – 2705
5. Permit Level:	<input type="checkbox"/> Exemption <input type="checkbox"/> Registration <input type="checkbox"/> SSOA <input checked="" type="checkbox"/> MSOP <input type="checkbox"/> FESOP <input type="checkbox"/> TVOP <input type="checkbox"/> PBR	
6. Application Summary:	Check all that apply. Multiple permit numbers may be assigned as needed based on the choices selected below.	
<input type="checkbox"/> Initial Permit <input checked="" type="checkbox"/> Renewal of Operating Permit <input type="checkbox"/> Asphalt General Permit <input type="checkbox"/> Review Request <input type="checkbox"/> Revocation of Operating Permit <input type="checkbox"/> Alternate Emission Factor Request <input type="checkbox"/> Interim Approval <input type="checkbox"/> Relocation of Portable Source <input type="checkbox"/> Acid Deposition (Phase II) <input type="checkbox"/> Site Closure <input type="checkbox"/> Emission Reduction Credit Registry		
<input type="checkbox"/> Transition (between permit levels) From: To:		
<input checked="" type="checkbox"/> Administrative Amendment: <input type="checkbox"/> Company Name Change <input checked="" type="checkbox"/> Change of Responsible Official <input type="checkbox"/> Correction to Non-Technical Information <input type="checkbox"/> Notice Only Change <input type="checkbox"/> Other (specify):		
<input type="checkbox"/> Modification: <input type="checkbox"/> New Emission Unit or Control Device <input type="checkbox"/> Modified Emission Unit or Control Device <input type="checkbox"/> New Applicable Permit Requirement <input type="checkbox"/> Change to Applicability of a Permit Requirement <input type="checkbox"/> Prevention of Significant Deterioration <input type="checkbox"/> Emission Offset <input type="checkbox"/> MACT Preconstruction Review <input type="checkbox"/> Minor Source Modification <input type="checkbox"/> Significant Source Modification <input type="checkbox"/> Minor Permit Modification <input type="checkbox"/> Significant Permit Modification <input type="checkbox"/> Other (specify):		
7. Is this an application for an initial construction and/or operating permit for a "Greenfield" Source?	<input type="checkbox"/> Yes <input checked="" type="checkbox"/> No	
8. Is this an application for construction of a new emissions unit at an Existing Source?	<input type="checkbox"/> Yes <input checked="" type="checkbox"/> No	

PART B: Pre-Application Meeting

Part B specifies whether a meeting was held or is being requested to discuss the permit application.

9. Was a meeting held between the company and IDEM prior to submitting this application to discuss the details of the project?

No Yes: Date:

10. Would you like to schedule a meeting with IDEM management and your permit writer to discuss the details of this project?

No Yes: Proposed Date for Meeting:

PART C: Confidential Business Information

Part C identifies permit applications that require special care to ensure that confidential business information is kept separate from the public file.

Claims of confidentiality must be made at the time the information is submitted to IDEM, and must follow the requirements set out in the Indiana Administrative Code (IAC). To ensure that your information remains confidential, refer to the IDEM, OAQ information regarding submittal of confidential business information. For more information on confidentiality for certain types of business information, please review IDEM's Nonrule Policy Document Air-031-NPD regarding Emission Data.

11. Is any of the information contained within this application being claimed as **Confidential Business Information**?

No Yes

PART D: Certification Of Truth, Accuracy, and Completeness

Part D is the official certification that the information contained within the air permit application packet is truthful, accurate, and complete. Any air permit application packet that we receive without a signed certification will be deemed incomplete and may result in denial of the permit.

For a Part 70 Operating Permit (TVOP) or a Source Specific Operating Agreement (SSOA), a "responsible official" as defined in 326 IAC 2-7-1(34) must certify the air permit application. For all other applicants, this person is an "authorized Individual" as defined in 326 IAC 2-1.1-1(1).

I certify under penalty of law that, based on information and belief formed after reasonable inquiry, the statements and information contained in this application are true, accurate, and complete.

Jeremy Renteria

Name (typed)

Director of Midwest Region Operations

Title

Signature

Jeremy Renteria

1/5/2024

Date



OAQ GENERAL SOURCE DATA APPLICATION
GSD-01: Basic Source Level Information
 State Form 50640 (R5 / 1-10)
 INDIANA DEPARTMENT OF ENVIRONMENTAL MANAGEMENT

IDEM – Office of Air Quality – Permits Branch
 100 N. Senate Avenue, MC 61-53 Room 1003
 Indianapolis, IN 46204-2251
 Telephone: (317) 233-0178 or
 Toll Free: 1-800-451-6027 x30178 (within Indiana)
 Facsimile Number: (317) 232-6749
www.IN.gov/idem

- NOTES:**
- The purpose of GSD-01 is to provide essential information about the entire source of air pollutant emissions. GSD-01 is a required form.
 - Detailed instructions for this form are available on the Air Permit Application Forms website.
 - All information submitted to IDEM will be made available to the public unless it is submitted under a claim of confidentiality. Claims of confidentiality must be made at the time the information is submitted to IDEM, and must follow the requirements set out in 326 IAC 17.1-4-1. Failure to follow these requirements exactly will result in your information becoming a public record, available for public inspection.

PART A: Source / Company Location Information

1. Source / Company Name: Indiana Sugars, Inc.		2. Plant ID: 089 – 0490	
3. Location Address: 911 Virginia			
City: Gary	State: IN	ZIP Code: 46402 – 2705	
4. County Name: Lake		5. Township Name:	
6. Geographic Coordinates:			
Latitude: 41.6002396		Longitude: -87.3314166	
7. Universal Transferred Mercator Coordinates (if known):			
Zone:	Horizontal:	Vertical:	
8. Adjacent States: Is the source located within 50 miles of an adjacent state?			
<input type="checkbox"/> No <input checked="" type="checkbox"/> Yes – Indicate Adjacent State(s): <input checked="" type="checkbox"/> Illinois (IL) <input checked="" type="checkbox"/> Michigan (MI) <input type="checkbox"/> Ohio (OH) <input type="checkbox"/> Kentucky (KY)			
9. Attainment Area Designation: Is the source located within a non-attainment area for any of the criteria air pollutants?			
<input checked="" type="checkbox"/> No <input type="checkbox"/> Yes – Indicate Nonattainment Pollutant(s): <input type="checkbox"/> CO <input type="checkbox"/> Pb <input type="checkbox"/> NO _x <input type="checkbox"/> O ₃ <input type="checkbox"/> PM <input type="checkbox"/> PM ₁₀ <input type="checkbox"/> PM _{2.5} <input type="checkbox"/> SO ₂			
10. Portable / Stationary: Is this a portable or stationary source?			
		<input type="checkbox"/> Portable	<input checked="" type="checkbox"/> Stationary

PART B: Source Summary

11. Company Internet Address (optional):	
12. Company Name History: Has this source operated under any other name(s)?	
<input checked="" type="checkbox"/> No <input type="checkbox"/> Yes – Provide information regarding past company names in Part I, Company Name History.	
13. Portable Source Location History: Will the location of the portable source be changing in the near future?	
<input checked="" type="checkbox"/> Not Applicable <input type="checkbox"/> No <input type="checkbox"/> Yes – Complete Part J, Portable Source Location History, and Part K, Request to Change Location of Portable Source.	
14. Existing Approvals: Have any exemptions, registrations, or permits been issued to this source?	
<input type="checkbox"/> No <input checked="" type="checkbox"/> Yes – List these permits and their corresponding emissions units in Part M, Existing Approvals.	
15. Unpermitted Emissions Units: Does this source have any unpermitted emissions units?	
<input checked="" type="checkbox"/> No <input type="checkbox"/> Yes – List all unpermitted emissions units in Part N, Unpermitted Emissions Units.	
16. New Source Review: Is this source proposing to construct or modify any emissions units?	
<input checked="" type="checkbox"/> No <input type="checkbox"/> Yes – List all proposed new construction in Part O, New or Modified Emissions Units.	
17. Risk Management Plan: Has this source submitted a Risk Management Plan?	
<input type="checkbox"/> Not Required <input checked="" type="checkbox"/> No <input type="checkbox"/> Yes → Date submitted: _____ EPA Facility Identifier: – –	

PART C: Source Contact Information

IDEM will send the original, signed permit decision to the person identified in this section. This person MUST be an employee of the permitted source.

18. Name of Source Contact Person: Rex Anderson		
19. Title (optional): Maintenance Manager		
20. Mailing Address: 911 Virginia Street		
City: Gary	State: IN	ZIP Code: 46402 - 2705
21. Electronic Mail Address (optional): rexa@buysugars.com		
22. Telephone Number: (219) 886 - 9151	23. Facsimile Number (optional): () -	

PART D: Authorized Individual/Responsible Official Information

IDEM will send a copy of the permit decision to the person indicated in this section, if the Authorized Individual or Responsible Official is different from the Source Contact specified in Part C.

24. Name of Authorized Individual or Responsible Official: Jeremy Renteria		
25. Title: Manager of Midwest Region Operations		
26. Mailing Address: 911 Virginia Street		
City: Gary	State: IN	ZIP Code: 46402 - 2705
27. Telephone Number: (219) 886 - 9151	28. Facsimile Number (optional): () -	
29. Request to Change the Authorized Individual or Responsible Official: Is the source officially requesting to change the person designated as the Authorized Individual or Responsible Official in the official documents issued by IDEM, OAQ? The permit may list the title of the Authorized Individual or Responsible Official in lieu of a specific name. <input type="checkbox"/> No <input checked="" type="checkbox"/> Yes - Change Responsible Official to:		

PART E: Owner Information

30. Company Name of Owner: Ron Yonover		
31. Name of Owner Contact Person:		
32. Mailing Address: 911 Virginia Street		
City: Gary	State: IN	ZIP Code: 46402 - 2705
33. Telephone Number: (219) 886 - 9151	34. Facsimile Number (optional): () -	
34. Operator: Does the "Owner" company also operate the source to which this application applies? <input type="checkbox"/> No - Proceed to Part F below. <input checked="" type="checkbox"/> Yes - Enter "SAME AS OWNER" on line 35 and proceed to Part G below.		

PART F: Operator Information

35. Company Name of Operator:		
36. Name of Operator Contact Person:		
37. Mailing Address:		
City:	State:	ZIP Code: -
38. Telephone Number: () -	39. Facsimile Number (optional): () -	

PART G: Agent Information		
40. Company Name of Agent:		
41. Type of Agent: <input type="checkbox"/> Environmental Consultant <input type="checkbox"/> Attorney <input type="checkbox"/> Other (specify):		
42. Name of Agent Contact Person:		
43. Mailing Address:		
City:	State:	ZIP Code: -
44. Electronic Mail Address (optional):		
45. Telephone Number: () -		46. Facsimile Number (optional): () -
47. Request for Follow-up: Does the "Agent" wish to receive a copy of the preliminary findings during the public notice period (if applicable) and a copy of the final determination? <input type="checkbox"/> No <input type="checkbox"/> Yes		

PART H: Local Library Information		
48. Date application packet was filed with the local library: 1/10/2024		
49. Name of Library: Gary Public Library		
50. Name of Librarian (optional):		
51. Mailing Address: 220 W. 5th AVE.		
City: GARY	State: IN	ZIP Code: 46402 -
52. Internet Address (optional):		
53. Electronic Mail Address (optional):		
54. Telephone Number: (219) 886 - 2484		55. Facsimile Number (optional): () -

PART I: Company Name History (if applicable)	
Complete this section only if the source has previously operated under a legal name that is different from the name listed above in Section A.	
56. Legal Name of Company	57. Dates of Use
	to
	to
	to
	to
	to
	to
	to
	to
	to
	to
58. Company Name Change Request: Is the source officially requesting to change the legal name that will be printed on all official documents issued by IDEM, OAQ? <input type="checkbox"/> No <input type="checkbox"/> Yes - Change Company Name to:	

PART J: Portable Source Location History (if applicable)

Complete this section only if the source is portable and the location has changed since the previous permit was issued. The current location of the source should be listed in Section A.

59. Plant ID	60. Location of the Portable Source	61. Dates at this Location
-		to
-		to
-		to
-		to
-		to
-		to
-		to
-		to
-		to
-		to
-		to
-		to
-		to
-		to
-		to
-		to
-		to
-		to
-		to
-		to
-		to
-		to
-		to
-		to

PART K: Request to Change Location of Portable Source (if applicable)

Complete this section to request a change of location for a portable source.

62. Current Location:

Address:

City:

State:

ZIP Code:

-

County Name:

63. New Location:

Address:

City:

State:

ZIP Code:

-

County Name:

PART L: Source Process Description			
Complete this section to summarize the main processes at the source.			
64. Process Description	65. Products	66. SIC Code	67. NAICS Code
Cane Sugar Refining	Confectioner's Sugar, Color Sugar, Brown sugar, Liquid sugar	2062	311314
Beet Sugar Refining	Confectioner's Sugar, Color Sugar, Brown Sugar, Liquid Sugar	2063	311313

PART M: Existing Approvals (if applicable)		
Complete this section to summarize the approvals issued to the source since issuance of the main operating permit.		
68. Permit ID	69. Emissions Unit IDs	70. Expiration Date
M089-41863-00490	Unit 1, Unit 1A Unit 2, Unit 2A, Unit 5, Unit 6, Unit 7, Unit 8, Unit 9, Unit 10, Unit 11, Unit 12, Unit 13	May,7, 2024
M089-34016-00490	Unit 1, Unit 1A, Unit 2, Unit 2A, Unit 5, Unit 6, Unit 7, Unit 8, Unit 9, Unit 10, Unit 11, Unit 12	May,7, 2024
M089-27251-00490	Unit 1, Unit 1A, Unit 2, Unit 2A, Unit 5, Unit 6, Unit 7, Unit 8, Unit 9, Unit 10, Unit 11, Unit 12	May,19, 2014

PART N: Unpermitted Emissions Units (if applicable)				
Complete this section only if the source has emission units that are not listed in any permit issued by IDEM, OAQ.				
71. Emissions Unit ID	72. Type of Emissions Unit	73. Actual Dates		
		Began Construction	Completed Construction	Began Operation

PART O: New or Modified Emissions Units (if applicable)						
Complete this section only if the source is proposing to add new emission units or modify existing emission units.						
74. Emissions Unit ID	75. NEW	76. MOD	77. Type of Emissions Unit	78. Estimated Dates		
				Begin Construction	Complete Construction	Begin Operation



OAQ GENERAL SOURCE DATA APPLICATION
GSD-02: Plant Layout Diagram
 State Form 51605 (R3 / 1-10)
 INDIANA DEPARTMENT OF ENVIRONMENTAL MANAGEMENT

IDEM – Office of Air Quality – Permits Branch
 100 N. Senate Avenue, MC 61-53 Room 1003
 Indianapolis, IN 46204-2251
 Telephone: (317) 233-0178 or
 Toll Free: 1-800-451-6027 x30178 (within Indiana)
 Facsimile Number: (317) 232-6749
www.IN.gov/idem

NOTES:

- The purpose of GSD-02 is to provide a diagram of the entire plant site. This form and a Plant Layout diagram are required for all air permit applications. If you do not provide the necessary information, applicable to your source, the application process may be stopped.
- IDEM, OAQ has provided detailed instructions for this form and an example of a basic plant layout diagram on the Air Permit Application Forms website.
- All information submitted to IDEM will be made available to the public unless it is submitted under a claim of confidentiality. Claims of confidentiality must be made at the time the information is submitted to IDEM, and must follow the requirements set out in 326 IAC 17.1-4-1. Failure to follow these requirements exactly will result in your information becoming a public record, available for public inspection.

Part A: Basic Plant Layout

Part A provides IDEM, OAQ with the appropriate information about all buildings and access-limiting features in and around the plant site. **Please use this table as a checklist.** You must provide scaled drawings, with the actual scale shown. All dimensions and units must be clearly indicated with a brief explanation of what is being shown. Include the following (*All measurements should be given in feet.*):

1. <input checked="" type="checkbox"/> Building Location and Dimensions		
2. <input checked="" type="checkbox"/> Property Lines and Access-Limiting Features		
3. <input checked="" type="checkbox"/> Surrounding Building Location and Dimensions		
4. <input checked="" type="checkbox"/> Distances to Property Lines and Access-Limiting Features		
5. <input checked="" type="checkbox"/> UTM Location Coordinates	6. <input checked="" type="checkbox"/> Compass (pointing North)	7. <input checked="" type="checkbox"/> Scale

Part B: Stack Information

Part B provides IDEM, OAQ with the appropriate information about all stacks, roof monitors, control devices, and process vents at the plant site. **Please use this table as a checklist.** You must show the location of all applicable emission points and include all relevant stack and emissions unit identification numbers for each. In addition, you will need to identify each of these emission points under "Stack Identification" on form GSD-04, Stack/Vent Information. Include the following (*All measurements should be in feet.*):

8. <input checked="" type="checkbox"/> Exhaust Stacks		
9. <input checked="" type="checkbox"/> Process Vents		
10. <input type="checkbox"/> Roof Monitors	<input type="checkbox"/> No Roof Monitors	
11. <input type="checkbox"/> Control Devices	<input type="checkbox"/> No Control Devices	
12. <input type="checkbox"/> Interior Vents	<input type="checkbox"/> No Interior Vents	<input type="checkbox"/> Doors and Windows (<i>for processes vented inside a building</i>)

Part C: Roadway Information

Part C provides IDEM, OAQ with the appropriate information about the roadways in and around the plant site. **Please use this table as a checklist.** Include the following (*All measurements should be in feet.*):

13. <input type="checkbox"/> Adjacent Roadways		<input type="checkbox"/> Interior Roadways
14. <input type="checkbox"/> Roadway Surface Description (gravel, dirt, paved, etc.)		
15. <input type="checkbox"/> Number of Lanes		

Part D: Source Building Information

This table provides detailed information about each building at the plant site that is part of the source. If additional space is needed, you may make a copy of this table. (All measurements should be given in feet.)

16. Building ID	17. Building Description	18. Building Dimensions			19. Distance & direction to the nearest property line or access limiting feature (feet & compass coordinate)	20. Distance & direction to the nearest residence (feet & compass coordinate)
		Length (feet)	Width (feet)	Height (feet)		
A	Warehouse	819.6	60	20	0' North	245' North
B	Plant 1	299.9	70.2	20	72' South	475' North
C	Warehouse B & C	262.1	60	20	72' South	475' North
D	Garage	200	50	20	119' North	338' North
E	Plant 2&3	300	100	20	38' North	180' North

Part E: Surrounding Building / Residence Information						
This table provides detailed information about each building or residence surrounding the plant site. If additional space is needed, you may make a copy of this table. <i>(All measurements should be given in feet.)</i>						
21. Surrounding Building / Residence Description	22. Surrounding Building / Residence Property Dimensions			23. Distance & direction to the nearest property line or access limiting feature (feet & compass coordinate)	24. Building ID of nearest building on the plant site	25. Distance & direction to the nearest building on the plant site (feet & compass coordinate)
	Length (feet)	Width (feet)	Height (feet)			
Single Home dwellings	30'	20'	15'	245' North	A	245' North

Part F: Plant Layout Diagram

This space provides a place for a hand drawn plant layout diagram. It is **optional** to use this space to create your plant layout, but you must include the diagram with your application. If you choose to submit the plant layout in a different format, state "plant layout attached" in the space provided, and submit the information with your completed application. IDEM, OAQ has provided an example of a basic plant layout diagram on the Air Permit Applications Forms website.

PLANT LAYOUT ATTACHED.

North

Full Scale

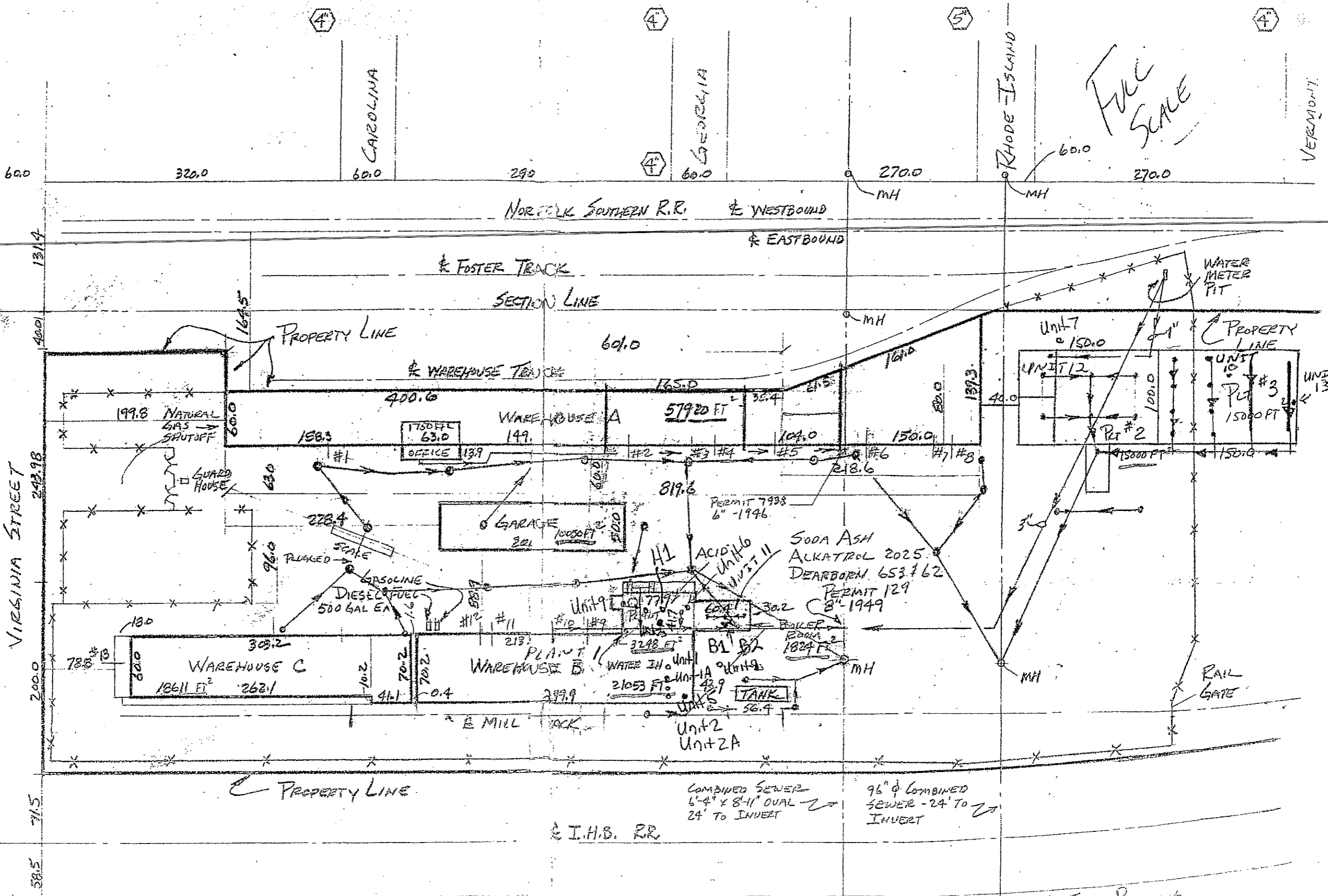

○ Sewer Aerial
 ⊙ Storm Sewer
 □ Gas

INDIANA SUGAR CO.
 11-15-37

TOTAL BUILDINGS
 AREA = 127706 FT²
 15900 - RT #3
 142706



OAQ GENERAL SOURCE DATA APPLICATION
GSD-03: Process Flow Diagram
 State Form 51599 (R3 / 1-10)
INDIANA DEPARTMENT OF ENVIRONMENTAL MANAGEMENT

IDEM – Office of Air Quality – Permits Branch
 100 N. Senate Avenue, MC 61-53 Room 1003
 Indianapolis, IN 46204-2251
 Telephone: (317) 233-0178 or
 Toll Free: 1-800-451-6027 x30178 (within Indiana)
 Facsimile Number: (317) 232-6749
www.IN.gov/idem

- NOTES:**
- The purpose of GSD-03 is to provide a checklist for identifying the information to be included on each Process Flow diagram.
 - Complete this form and submit a process flow diagram for each process included in your air permit application.
 - IDEM, OAQ has provided detailed instructions for this form and an example of a basic process flow diagram on the Air Permit Application Forms website.
 - All information submitted to IDEM will be made available to the public unless it is submitted under a claim of confidentiality. Claims of confidentiality must be made at the time the information is submitted to IDEM, and must follow the requirements set out in 326 IAC 17.1-4-1. Failure to follow these requirements exactly will result in your information becoming a public record, available for public inspection.

Part A: Process Flow Diagram

Part A provides basic information to understanding the nature of the process. Please use this table as a checklist to indicate that you have included the following items on your process flow diagram (*All throughputs should be given in pounds per hour.*):

1. **Process Description:**
2. **Process Equipment** 3. **Raw Material Input** 4. **Process Throughput**
5. **Additions** **Deletions** **Modifications**

Use the space below to briefly explain the impacts of the additional equipment, the reason for removing any equipment, and/or the reason for the proposed modification. (*If additional space is needed, please attach a separate sheet with the information and indicate in the space below that additional information is attached.*)

Part B: Process Operation Schedule

Part B indicates the actual (or estimated actual) hours of operation for the process.

6. **Process Operation Schedule** 24 Hours per Day 7 Days per Week 52 Weeks Per Year

7. **Scheduled Downtime:** Use the space below to include as much information as is known about scheduled periods of downtime for this process. (*If additional space is needed, please attach a separate sheet with the information and indicate in the space below that additional information is attached.*)
 Routine downtime for scheduled maintenance an preventative maintenance.

Part C: Emissions Point Information

Part C provides information about each potential outlet of air pollutant emissions to the atmosphere. Please use this table as a checklist to indicate that you have included the following items on your process flow diagram (*All throughputs should be given in pounds per hour.*):

8. **Stack / Vent Information**
9. **Pollutants Emitted**
10. **Air Pollution Control**

Part D: Process Flow Diagram

This space provides a place for a hand drawn process flow diagram. It is **optional** to use this space to create your process flow diagram, but you must include the diagram with your application. If you choose to submit the process flow diagram in a different format, state "process flow diagram attached" in the space provided, and submit the information with your completed application. IDEM, OAQ has provided an example of a basic process flow diagram on the Air Permit Applications Forms website.

Process flow diagram attached.

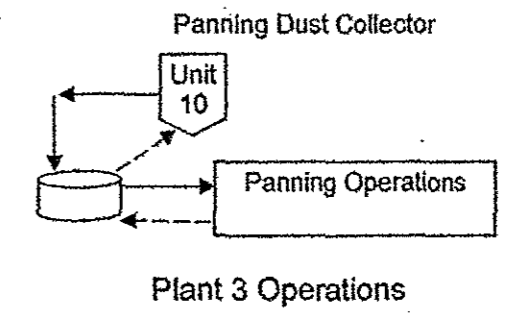
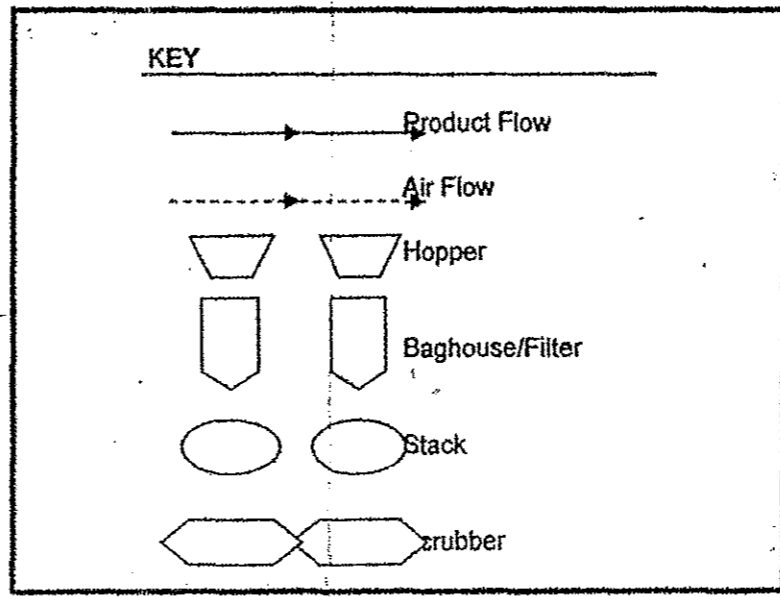
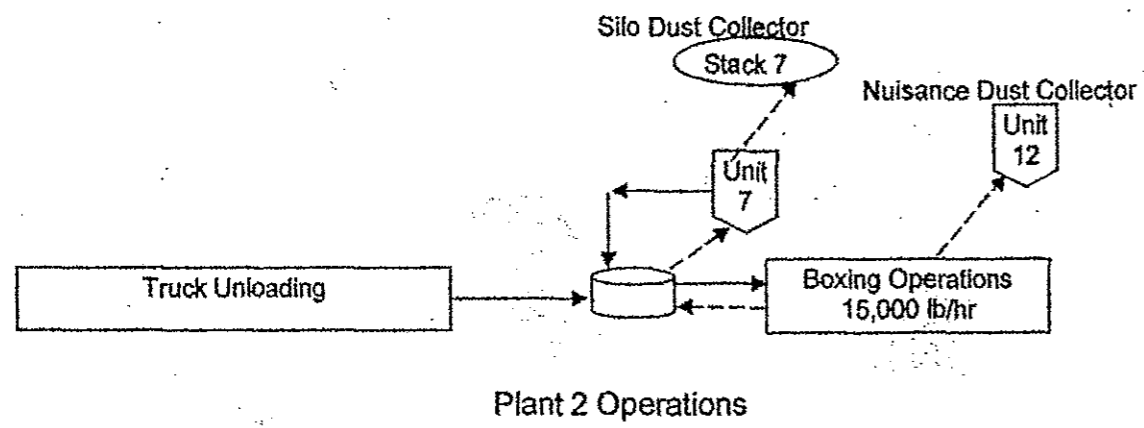
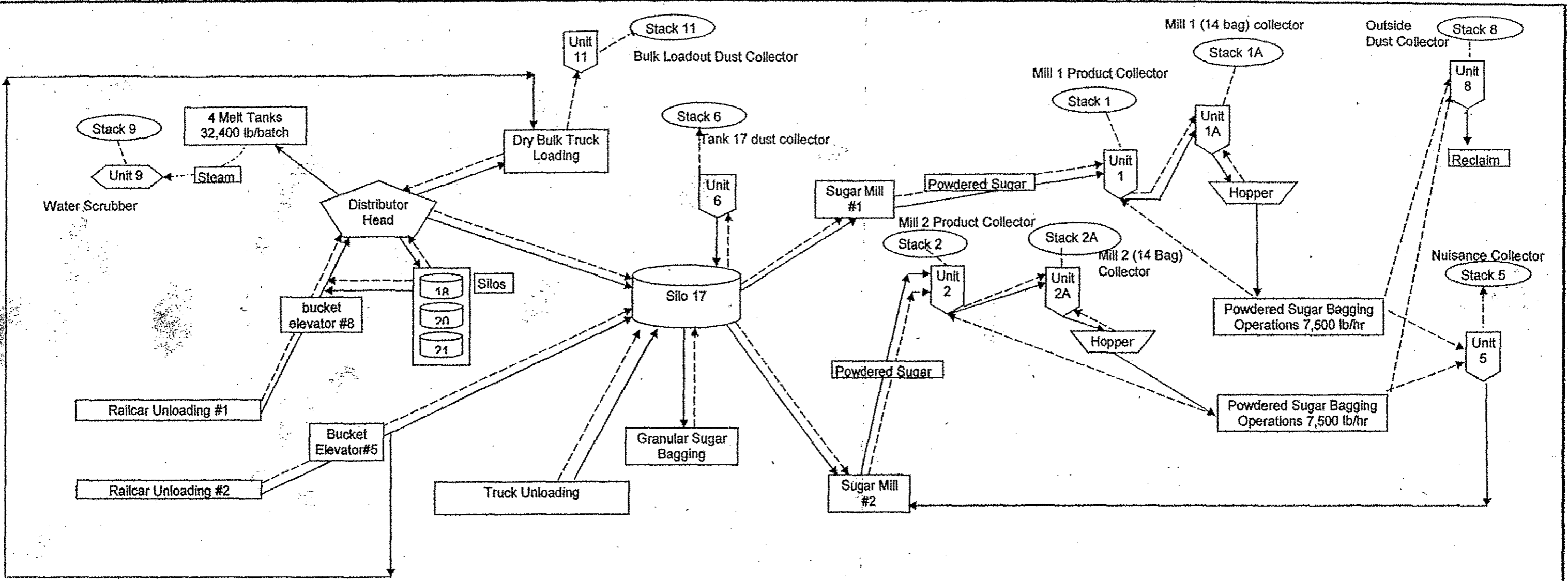

BROWN SUGAR OPERATION
1000 lb/hr

Source ID: 089-00490
Air Permit Flow Diagram
6/1/2013



OAQ GENERAL SOURCE DATA APPLICATION
GSD-04: Stack / Vent Information
 State Form 51606 (R3 / 1-10)
 INDIANA DEPARTMENT OF ENVIRONMENTAL MANAGEMENT

IDEM – Office of Air Quality – Permits Branch
 100 N. Senate Avenue, MC 61-53 Room 1003
 Indianapolis, IN 46204-2251
 Telephone: (317) 233-0178 or
 Toll Free: 1-800-451-6027 x30178 (within Indiana)
 Facsimile Number: (317) 232-6749
www.IN.gov/idem

NOTES:

- The purpose of this form is to provide basic information about each stack or vent that has the potential to emit air pollutants. If you do not provide enough information to adequately describe each process vent and/or stack, the application process may be stopped. This form is required for all air permit applications.
- Detailed instructions for this form are available online on the Air Permit Application Forms website.
- All information submitted to IDEM will be made available to the public unless it is submitted under a claim of confidentiality. Claims of confidentiality must be made at the time the information is submitted to IDEM, and must follow the requirements set out in 326 IAC 17.1-4-1. Failure to follow these requirements exactly will result in your information becoming a public record, available for public inspection.

Stack / Vent Information							
This table provides detailed information about each stack or vent through which air pollutants could be released into the atmosphere. If an air stream is vented inside a building, the vent does not need to be listed on this form. If additional space is needed, you may make a copy of this form.							
1. Stack / Vent ID	2. Type (V H W O)	3. Shape (C R O)	4. Outlet Dimensions (feet)	5. Height (feet)	6. Maximum Outlet Flow Rate (acfm)	7. Outlet Gas Temperature (Degrees F)	8. Related Stacks / Vents (B P O)
Stack 1	V	C	.8	38	4500	158	Stack 2 (P)
Stack 1A	W	C	.33	5	380	145	Stack 2A (P)
Stack 2	V	C	.8	38	3500	134	Stack 1 (P)
Stack 2A	W	C	.33	5	380	145	Stack 1A (P)
Stack 5	W	C	.75 X 1.17	20	2112	100	
Stack 6	W	C	.33	64	1000	95	
Stack 7	H	R	.33	64	1000	95	
Stack 8	V	R	1.5 X 2.25	8	15000	95	
Stack 9	V	C	.92	47	3200	90	
Stack 11	V	C	.67	30	1000	94	
Stack B1	V	C	1.16	20	4500	450	Stack B2 (P)
Stack B2	V	C	1.16	20	4500	450	Stack B1 (P)



OAQ GENERAL SOURCE DATA APPLICATION
GSD-05: Emissions Unit Information
 State Form 51610 (R3 / 1-10)
 INDIANA DEPARTMENT OF ENVIRONMENTAL MANAGEMENT

IDEM – Office of Air Quality – Permits Branch
 100 N. Senate Avenue, MC 61-53 Room 1003
 Indianapolis, IN 46204-2251
 Telephone: (317) 233-0178 or
 Toll Free: 1-800-451-6027 x30178 (within Indiana)
 Facsimile Number: (317) 232-6749
www.IN.gov/idem

NOTES:

- The purpose of this form is to provide basic information about each emissions unit that has the potential to emit air pollutants. This form is required for all air permit applications.
- Detailed instructions for this form are available online on the Air Permit Application Forms website.
- All information submitted to IDEM will be made available to the public unless it is submitted under a claim of confidentiality. Claims of confidentiality must be made at the time the information is submitted to IDEM, and must follow the requirements set out in 326 IAC 17.1-4-1. Failure to follow these requirements exactly will result in your information becoming a public record, available for public inspection.

Emissions Unit Information							
This table provides detailed information about each emissions unit that has the potential to emit air pollutants to the atmosphere. Accurate information is needed to determine the total potential to emit. If you do not provide enough information to adequately describe each emissions unit, the application process may be stopped. If additional space is needed, you may make a copy of this form.							
1. Unit ID	2. Model Number	3. Serial Number	4. Description	5. Manufacturer	6. Installation Date	7. Maximum Capacity	8. Stack / Vent ID
1	144-TRW-8		#1 SUGAR MILL	MIKRO-PULSAIRE	1982	7,500 lb/hr	1
1A	58AV14		#1 BULK TRANSPORT	SCHICK	1982	7,500 lb/hr	1A
2	42-6-1000	810 45H1	#2 SUGAR MILL	MIKRO-PULSAIRE	1982	7,500 lb/hr	2
2A	58AV14		#2 BULK TRANSPORT	SCHICK	1982	7,500 lb/hr	2A
5	85-6-50	80 H5304	Bagging Nuisance	MICRO-PULSAIRE	1992	15,000 lb/hr	5
6	72AVSC36:60S		Granulated Sugar Operation	USS BIN VENT	2002	40,000 lb/hr	6
7	84-BF-016-C	6051	Truck Unload	C.P.E FILTERS INC.	2004	50,000 lb/hr	7
8	144LST144 STY III	134260-001-1	Bagging and Reclaim	MAC	2009	15,000 lb/hr	8
9	CAT		Melt Tanks	AT INDUSTRIAL PRODUCTS	2009	32,400 lb/batch	9
10	MP-10	62287	Panning Dust collector	SCIENTIFIC	2004	15,000 lb/hr	
11	TD 486	3071077	Bulk Loadout	DONALDSON TORIT	2008	50,000 lb/hr	11
12	SPJ-30-X4B8	62814	Boxing Nuisance	SCIENTIFIC	2004	15,000 lb/hr	
B1	H3S-100-G	R 4194	Boiler 1	KEWANEE	1982	4135 MBH/hr	B1
B2	H3S-100-G	R 4192	Boiler 2	KEWANEE	1982	4135 MBH/hr	B2



OAQ GENERAL SOURCE DATA APPLICATION
GSD-06: Particulate Emissions Summary
 State Form 51612 (R3 / 1-10)
 INDIANA DEPARTMENT OF ENVIRONMENTAL MANAGEMENT

IDEM – Office of Air Quality – Permits Branch
 100 N. Senate Avenue, MC 61-53 Room 1003
 Indianapolis, IN 46204-2251
 Telephone: (317) 233-0178 or
 Toll Free: 1-800-451-6027 x30178 (within Indiana)
 Facsimile Number: (317) 232-6749
www.IN.gov/idem

- NOTES:**
- The purpose of this form is to provide basic information about each source of particulate emissions. This form is required for all air permit applications.
 - Detailed instructions for this form are available on the Air Permit Application Forms website.
 - All information submitted to IDEM will be made available to the public unless it is submitted under a claim of confidentiality. Claims of confidentiality must be made at the time the information is submitted to IDEM, and must follow the requirements set out in 326 IAC 17.1-4-1. Failure to follow these requirements exactly will result in your information becoming a public record, available for public inspection.

Part A: Particulate Matter Emissions

Part A provides a summary of the type and amount of particulate emissions at the source. The state rules on particulate emissions are found in Title 326 of the Indiana Administrative Code, Article 6, Particulate Rules. If you do not provide enough information to adequately describe each source of particulate emissions, the application process may be stopped. If additional space is needed, you may make a copy of this table.

Emissions Point		Potential To Emit (tons per year)						
1. ID	2. Description	3. PM	4. PM-10	5. PM-2.5	6. TSP	7. Fugitive Dust	8. Fugitive PM	9. HAP PM
UNIT 1	SUGAR MILL	337.9	337.9	337.9				
UNIT 1A	POWDER SUGAR TRANSPORT	28.5	28.5	28.5				
UNIT 2	SUGAR MILL	262.8	262.8	262.8				
UNIT 2A	POWDER SUGAR TRANSPORT	28.5	28.5	28.5				
UNIT 5	BAGGING NUISANCE COLLECTION	158.6	158.6	158.6				
UNIT 6	SUGAR TRANSPORT	75.1	75.1	75.1				
UNIT 7	SILO FILL	52.6	52.6	52.6				
UNIT 8	RECLAIM FROM POWDER BAGGERS	469.3	469.3	469.3				
UNIT 9	SUGAR MELT TANKS	30.3	30.3	30.3				
UNIT 10	COLOR SUGAR PANNING	12.3	12.3	12.3				
UNIT 11	DRY BULK TRUCK LOADING	75.1	75.1	75.1				
UNIT12	BOXING NUISANCE COLLECTION	158.6	158.6	158.6				
B 1	BOILER	.027	.113	.113				.027
B2	BOILER	.027	.113	.113				.027
H1	HEAT EXCHANGER	.027	.113	.113				.027

Part B: Control of Particulate Emissions

Part C gathers information about how each source of particulate emissions is controlled. If you do not provide enough information to adequately describe how each source of particulate emissions is controlled, the application process may be stopped. If additional space is needed, you may make a copy of this table.

10. Emissions Point ID	11. Control Measure	12. Control Measure Description	13. Control Plan
UNIT 9	<input type="checkbox"/> No Control <input checked="" type="checkbox"/> Dust Suppression <input type="checkbox"/> Other: _____	FABRIC FILTER DUST COLLECTOR	<input type="checkbox"/> Yes <input type="checkbox"/> No Date Submitted: _____
UNIT 10	<input type="checkbox"/> No Control <input checked="" type="checkbox"/> Dust Suppression <input type="checkbox"/> Other: _____	FABRIC FILTER DUST COLLECTOR	<input type="checkbox"/> Yes <input type="checkbox"/> No Date Submitted: _____
UNIT 11	<input type="checkbox"/> No Control <input checked="" type="checkbox"/> Dust Suppression <input type="checkbox"/> Other: _____	FABRIC FILTER DUST COLLECTOR	<input type="checkbox"/> Yes <input type="checkbox"/> No Date Submitted: _____
UNIT 12	<input type="checkbox"/> No Control <input checked="" type="checkbox"/> Dust Suppression <input type="checkbox"/> Other: _____	FABRIC FILTER DUST COLLECTOR	<input type="checkbox"/> Yes <input type="checkbox"/> No Date Submitted: _____
	<input type="checkbox"/> No Control <input type="checkbox"/> Dust Suppression <input type="checkbox"/> Other: _____		<input type="checkbox"/> Yes <input type="checkbox"/> No Date Submitted: _____
	<input type="checkbox"/> No Control <input type="checkbox"/> Dust Suppression <input type="checkbox"/> Other: _____		<input type="checkbox"/> Yes <input type="checkbox"/> No Date Submitted: _____
	<input type="checkbox"/> No Control <input type="checkbox"/> Dust Suppression <input type="checkbox"/> Other: _____		<input type="checkbox"/> Yes <input type="checkbox"/> No Date Submitted: _____
	<input type="checkbox"/> No Control <input type="checkbox"/> Dust Suppression <input type="checkbox"/> Other: _____		<input type="checkbox"/> Yes <input type="checkbox"/> No Date Submitted: _____



OAQ GENERAL SOURCE DATA APPLICATION
GSD-07: Criteria Pollutant Emissions Summary
 State Form 51602 (R3 / 1-10)
 INDIANA DEPARTMENT OF ENVIRONMENTAL MANAGEMENT

IDEM – Office of Air Quality – Permits Branch
 100 N. Senate Avenue, MC 61-53 Room 1003
 Indianapolis, IN 46204-2251
 Telephone: (317) 233-0178 or
 Toll Free: 1-800-451-6027 x30178 (within Indiana)
 Facsimile Number: (317) 232-6749
www.IN.gov/idem

NOTES:

- The purpose of this form is to provide the actual and potential emissions of each criteria pollutant emitted from the source. This form is required for all air permit applications.
- Detailed instructions for this form are available on the Air Permit Application Forms website.
- All information submitted to IDEM will be made available to the public unless it is submitted under a claim of confidentiality. Claims of confidentiality must be made at the time the information is submitted to IDEM, and must follow the requirements set out in 326 IAC 17.1-4-1. Failure to follow these requirements exactly will result in your information becoming a public record, available for public inspection.

Part A: Unit Emissions Summary						
Part A provides the actual and potential emissions of each criteria pollutant emitted from each emissions unit. If you do not provide enough information to adequately describe the emissions from each emissions unit, the application process may be stopped.						
1. Unit ID	2. Stack / Vent ID	3. Criteria Pollutant	4. Actual Emissions		5. Potential To Emit	
			Standard Units	Tons Per Year	Standard Units	Tons Per Year
B1	B1	CO2	lb/MMCF	.01	lb/MMCF	.01
B1	B1	NOx	lb/MMCF	1.48	lb/MMCF	1.48
B1	B1	VOC	lb/MMCF	.08	lb/MMCF	.08
B1	B1	CO2e	lb/MMCF	1,790	lb/MMCF	1,790
B1	B1	HAP	lb/MMCF	.027	lb/MMCF	.027
B2	B2	CO2	lb/MMCF	.01	lb/MMCF	.01
B2	B2	NOx	lb/MMCF	1.48	lb/MMCF	1.48
B2	B2	VOC	lb/MMCF	.08	lb/MMCF	.08
B2	B2	CO2e	lb/MMCF	1,790	lb/MMCF	1,790
B2	B2	HAP	lb/MMCF	.027	lb/MMCF	.027
H1	H1	CO2	lb/MMCF	.01	lb/MMCF	.01
H1	H1	NOx	lb/MMCF	1.48	lb/MMCF	1.48
H1	H1	VOC	lb/MMCF	.08	lb/MMCF	.08
H1	H1	CO2e	lb/MMCF	1,790	lb/MMCF	1,790
H1	H1	HAP	lb/MMCF	.027	lb/MMCF	.027

Part B: Pollutant Emissions Summary

Part B provides the total actual and potential emissions of each criteria pollutant emitted from the source (including all emissions units and fugitive emissions at the source). If you do not provide enough information to adequately describe the total source emissions, the application process may be stopped.

6. Criteria Pollutant	7. Actual Emissions		8. Potential To Emit	
	Standard Units	Tons Per Year	Standard Units	Tons Per Year
Carbon Monoxide (CO)	lb/MMCF	11.22	lb/MMCF	11.22
Lead (Pb)	lb/MMCF	5.00E-04	lb/MMCF	5.00E-04
Nitrogen Oxides (NO _x)	lb/MMCF	13.35	lb/MMCF	13.35
Particulate Matter (PM)	lb/MMCF	.24	lb/MMCF	.24
Particulate Matter less than 10µm (PM ₁₀)	lb/MMCF	1.02	lb/MMCF	1.02
Particulate Matter less than 2.5µm (PM _{2.5})	lb/MMCF	1.02	lb/MMCF	1.02
Sulfur Dioxide (SO ₂)	lb/MMCF	.09	lb/MMCF	.09
Volatile Organic Compounds (VOC)	lb/MMCF	.72	lb/MMCF	.72
Other (specify):				

Part C: Fugitive VOC Emissions (if applicable)

Part C summarizes the sources of fugitive VOC emissions at the source and estimates VOC emissions from these emission points. Complete this table if you are required to provide fugitive emissions data pursuant to 326 IAC 2-2 or 326 IAC 2-3.

9. Fugitive Emissions Source	10. Emission Factor (lb/hr)	11. Number Leaking	12. Uncontrolled Potential To Emit	
			Pounds Per Hour	Tons Per Year
Compressor Seals				
Flanges				
Open-Ended Lines				
Pressure Relief Seals				
Pump Seals				
Sampling Connections				
Valves				
Other (specify):				



OAQ GENERAL SOURCE DATA APPLICATION
GSD-10: Insignificant Activities
 State Form 51596 (R4 / 1-10)
INDIANA DEPARTMENT OF ENVIRONMENTAL MANAGEMENT

IDEM – Office of Air Quality – Permits Branch
 100 N. Senate Avenue, MC 61-53 Room 1003
 Indianapolis, IN 46204-2251
 Telephone: (317) 233-0178 or
 Toll Free: 1-800-451-6027 x30178 (within Indiana)
 Facsimile Number: (317) 232-6749
www.IN.gov/idem

NOTES:

- The purpose of this form is to identify all trivial and insignificant activities in operation at the source. This form is required for all air permit applications.
- Detailed instructions for this form are available on the Air Permit Application Forms website.
- All information submitted to IDEM will be made available to the public unless it is submitted under a claim of confidentiality. Claims of confidentiality must be made at the time the information is submitted to IDEM, and must follow the requirements set out in 326 IAC 17.1-4-1. Failure to follow these requirements exactly will result in your information becoming a public record, available for public inspection.

Part A: Trivial Activities (Optional)

Part A identifies all trivial activities in operation at the source as defined in 326 IAC 2-7-1(40). **Please use this table as a checklist.** Check each item and sub-item that applies. If applicable, provide the Emissions Unit Identification number that corresponds to the Plant Layout and Process Flow diagrams.

Unit ID	Description of Trivial Activity	Citation (326 IAC)
	1. Any activity or emission unit:	2-7-1(40)(A)
	<input type="checkbox"/> not regulated by a NESHAP, with potential uncontrolled emissions are equal to or less than one (1) pound per day on an emission unit basis for any single HAP or combination of HAPs; and	
	<input type="checkbox"/> for which the potential uncontrolled emissions meet the exemption levels specified in the following:	
	<input type="checkbox"/> For lead and lead compounds measured as elemental lead (Pb), potential uncontrolled emissions that are equal to or less than one (1) pound per day	
	<input type="checkbox"/> For carbon monoxide (CO), potential uncontrolled emissions that are equal to or less than one (1) pound per day	
	<input type="checkbox"/> For sulfur dioxide (SO ₂), potential uncontrolled emissions that are equal to or less than one (1) pound per day	
	<input type="checkbox"/> For volatile organic compounds (VOC), potential uncontrolled emissions that are equal to or less than one (1) pound per day	
	<input type="checkbox"/> For nitrogen oxides (NO _x), potential uncontrolled emissions that are equal to or less than one (1) pound per day	
	<input type="checkbox"/> For particulate matter with an aerodynamic diameter less than or equal to ten (10) micrometers (PM ₁₀), potential uncontrolled emissions that are equal to or less than one (1) pound per day	
	2. Water related activities including:	2-7-1(40)(B)
	<input type="checkbox"/> Production of hot water for on-site personal use not related to any industrial or production process	
	<input type="checkbox"/> Water treatment activities used to provide potable and process water for the plant, excluding any activities associated with wastewater treatment	
	<input checked="" type="checkbox"/> Steam traps, vents, leaks and safety relief valves	
	<input type="checkbox"/> Cooling ponds	
	<input type="checkbox"/> Laundry operations using only water solutions of bleach or detergents	
	<input type="checkbox"/> Demineralized water tanks and demineralizer vents	
	<input checked="" type="checkbox"/> Boiler water treatment operations, not including cooling towers	
	<input type="checkbox"/> Oxygen scavenging (de-aeration) of water	
	<input type="checkbox"/> Steam cleaning operations and steam sterilizers	
	<input type="checkbox"/> Pressure washing of equipment	
	<input type="checkbox"/> Water jet cutting operations	

Part A: Trivial Activities (continued)

Part A identifies all trivial activities in operation at the source as defined in 326 IAC 2-7-1(40). Please use this table as a checklist. Check each item and sub-item that applies. If applicable, provide the Emissions Unit Identification number that corresponds to the Plant Layout and Process Flow diagrams.

Unit ID	Description of Trivial Activity	Citation (326 IAC)
	3. Combustion activities including the following:	2-7-1(40)(C)
	<input type="checkbox"/> Portable electrical generators that can be moved by hand from one location to another. "Moved by hand" means that it can be moved without the assistance of any motorized or non-motorized vehicle, conveyance, or device	
	<input type="checkbox"/> Combustion emissions from propulsion of mobile sources	
	<input type="checkbox"/> Fuel use related to food preparation for on-site consumption	
	<input type="checkbox"/> Tobacco smoking rooms and areas	
	<input type="checkbox"/> Blacksmith forges	
	<input type="checkbox"/> Indoor and outdoor kerosene heaters	
	4. Activities related to ventilation, venting equipment and refrigeration, including the following:	2-7-1(40)(D)
	<input type="checkbox"/> Ventilation exhaust, central chiller water systems, refrigeration and air conditioning equipment, not related to any industrial or production process, including natural draft hoods or ventilating systems that do not remove air pollutants	
	<input type="checkbox"/> Stack and vents from plumbing traps used to prevent the discharge of sewer gases, handling domestic sewage only, excluding those at wastewater treatment plants or those handling any industrial waste	
	<input type="checkbox"/> Vents from continuous emissions monitors and other analyzers	
	<input type="checkbox"/> Natural gas pressure regulator vents, excluding venting at oil and gas production facilities	
	<input type="checkbox"/> Air vents from air compressors	
	<input type="checkbox"/> Vents for air cooling of electric motors provided the air does not commingle with regulated air pollutants	
	<input type="checkbox"/> Vents from equipment used to air blow water from cooled plastics strands or sheets	
	5. Activities related to routine fabrication, maintenance and repair of buildings, structures, equipment or vehicles at the source where air emissions from those activities would not be associated with any commercial production process including the following:	2-7-1(40)(E)
	<input checked="" type="checkbox"/> Activities associated with the repair and maintenance of paved and unpaved roads, including paving or sealing, or both, of parking lots and roadways	
	<input checked="" type="checkbox"/> Painting, including interior and exterior painting of buildings, and solvent use, excluding degreasing operations utilizing halogenated organic solvents	
	<input checked="" type="checkbox"/> Brazing, soldering, or welding operations and associated equipment	
	<input type="checkbox"/> Portable blast-cleaning equipment with enclosures	
	<input type="checkbox"/> Blast-cleaning equipment using water as the suspension agent and associated equipment	
	<input type="checkbox"/> Batteries and battery charging stations, except at battery manufacturing plants	
	<input checked="" type="checkbox"/> Lubrication, including hand-held spray can lubrication, dipping metal parts into lubricating oil, and manual or automated addition of cutting oil in machining operations	
	<input type="checkbox"/> Non-asbestos insulation installation or removal	
	<input type="checkbox"/> Tarring, retarring and repair of building roofs	
	<input type="checkbox"/> Bead blasting of heater tubes	
	<input type="checkbox"/> Instrument air dryer and filter maintenance	
	<input type="checkbox"/> Manual tank gauging	
	<input type="checkbox"/> Open tumblers associated with deburring operations in maintenance shops	

Part A: Trivial Activities (continued)

Part A is intended to identify all trivial activities in operation at the source as defined in 326 IAC 2-7-1(40). **Please use this table as a checklist.** Check each item and sub-item that applies. If applicable, provide the Emissions Unit Identification number that corresponds to the Plant Layout and Process Flow diagrams.

Unit ID	Description of Trivial Activity	Citation (326 IAC)
	6. Activities performed using hand-held equipment including the following:	2-7-1(40)(F)
	<input type="checkbox"/> Application of hot melt adhesives with no VOC in the adhesive formulation <input type="checkbox"/> Cutting, excluding cutting torches <input type="checkbox"/> Buffing <input checked="" type="checkbox"/> Grinding <input type="checkbox"/> Sanding <input type="checkbox"/> Machining wood, metal, or plastic <input type="checkbox"/> Carving <input type="checkbox"/> Polishing <input checked="" type="checkbox"/> Sawing <input type="checkbox"/> Turning wood, metal, or plastic <input checked="" type="checkbox"/> Drilling <input type="checkbox"/> Routing <input checked="" type="checkbox"/> Surface grinding	
	7. Housekeeping and janitorial activities and supplies including the following:	2-7-1(40)(G)
	<input type="checkbox"/> Vacuum cleaning systems used exclusively for housekeeping or custodial activities, or both	
	<input type="checkbox"/> Steam cleaning activities	
	<input checked="" type="checkbox"/> Rest rooms and associated cleanup operations and supplies	
	<input type="checkbox"/> Alkaline or phosphate cleaners and associated equipment	
	<input checked="" type="checkbox"/> Mobile floor sweepers and floor scrubbers	
	<input type="checkbox"/> Pest control fumigation	
	8. Office related activities including the following:	2-7-1(40)(H)
	<input checked="" type="checkbox"/> Office supplies and equipment	
	<input checked="" type="checkbox"/> Photocopying equipment and associated supplies	
	<input checked="" type="checkbox"/> Paper shredding	
	<input type="checkbox"/> Blueprint machines, photographic equipment, and associated supplies	
	9. Lawn care and landscape maintenance activities and equipment, including the storage, spraying or application of insecticides, pesticides and herbicides	2-7-1(40)(I)
	10. Storage equipment and activities including:	2-7-1(40)(J)
	<input type="checkbox"/> Pressurized storage tanks and associated piping for the following:	
	<input type="checkbox"/> Acetylene <input type="checkbox"/> Inorganic compounds <input type="checkbox"/> Natural gas	
	<input type="checkbox"/> Anhydrous ammonia <input type="checkbox"/> Liquid petroleum gas (LPG) <input type="checkbox"/> Nitrogen dioxide	
	<input type="checkbox"/> Carbon Monoxide <input type="checkbox"/> Liquid natural gas (LNG) (propane) <input type="checkbox"/> Sulfur dioxide	
	<input type="checkbox"/> Chlorine	
	<input checked="" type="checkbox"/> Storage tanks, vessels, and containers holding or storing liquid substances that do not contain any VOC or HAP	
	<input checked="" type="checkbox"/> Storage tanks, reservoirs, and pumping and handling equipment of any size containing soap, wax, vegetable oil, grease, animal fat, and nonvolatile aqueous salt solutions, provided appropriate lids and covers are utilized	
	<input type="checkbox"/> Storage of drums containing maintenance raw materials	
	<input type="checkbox"/> Storage of the following:	
	<input type="checkbox"/> Castings	
	<input type="checkbox"/> Lance rods	
	<input type="checkbox"/> Any non-HAP containing material in solid form stored in a sealed or covered container	
	<input type="checkbox"/> Portable containers used for the collection, storage, or disposal of materials provided the container capacity is equal to or less than forty-six hundredths (0.46) cubic meters and the container is closed except when the material is added or removed	

Part A: Trivial Activities (continued)

Part A identifies to identify all trivial activities in operation at the source as defined in 326 IAC 2-7-1(40). **Please use this table as a checklist.** Check each item and sub-item that applies. If applicable, provide the Emissions Unit Identification number that corresponds to the Plant Layout and Process Flow diagrams.

Unit ID	Description of Trivial Activity	Citation (326 IAC)
	11. Emergency and standby equipment including:	2-7-1(40)(K)
	<input type="checkbox"/> Emergency (backup) electrical generators at residential locations, such as dormitories, prisons and hospitals.	
	<input type="checkbox"/> Safety and emergency equipment, except engine driven fire pumps, including fire suppression systems and emergency road flares.	
	<input checked="" type="checkbox"/> Process safety relief devices installed solely for the purpose of minimizing injury to persons or damage to equipment which could result from abnormal process operating conditions, including the following:	
	<input checked="" type="checkbox"/> Explosion relief vents, diaphragms or panels <input checked="" type="checkbox"/> Rupture discs <input checked="" type="checkbox"/> Safety relief valves	
	<input type="checkbox"/> Activities and equipment associated with on-site medical care not otherwise specifically regulated	
	<input type="checkbox"/> Vacuum producing devices for the purpose of removing potential accidental releases	
	12. Sampling and testing equipment and activities including the following:	2-7-1(40)(L)
	<input type="checkbox"/> Equipment used for quality control/assurance or inspection purposes, including sampling equipment used to withdraw materials for analysis	
	<input type="checkbox"/> Hydraulic and hydrostatic testing equipment	
	<input type="checkbox"/> Ground water monitoring wells and associated sample collection equipment	
	<input type="checkbox"/> Environmental chambers not using hazardous air pollutant (HAP) gases	
	<input type="checkbox"/> Shock chambers	
	<input type="checkbox"/> Humidity chambers	
	<input type="checkbox"/> Solar simulators	
	<input type="checkbox"/> Sampling activities including	
	<input type="checkbox"/> Sampling of waste <input type="checkbox"/> Glove box sampling, charging, and packaging	
	<input type="checkbox"/> Instrument air dryers and distribution	
	13. Use of consumer products and equipment where the product or equipment is used at a source in the same manner as normal consumer use and is not associated with any production process	2-7-1(40)(M)
	14. Equipment and activities related to the handling, treating, and processing of animals including:	2-7-1(40)(N)
	<input type="checkbox"/> Equipment used exclusively to slaughter animals, but not including the following: Rendering cookers, Boilers, Heating plants, Incinerators, and/or Electrical power generating equipment	
	<input type="checkbox"/> Veterinary operating rooms	
	15. Activities generating limited amounts of fugitive dust including:	2-7-1(40)(O)
	<input type="checkbox"/> Fugitive emissions related to movement of passenger vehicles, provided the emissions are not counted for applicability purposes under 326 IAC 2-7-1(22)(B), and any required fugitive dust control plan or its equivalent is submitted	
	<input type="checkbox"/> Soil boring	
	<input type="checkbox"/> Road salting and sanding	

Part A: Trivial Activities (continued)

Part A identifies all trivial activities in operation at the source as defined in 326 IAC 2-7-1(40). **Please use this table as a checklist.** Check each item and sub-item that applies. If applicable, provide the Emissions Unit Identification number that corresponds to the Plant Layout and Process Flow diagrams.

Unit ID	Description of Trivial Activity	Citation (326 IAC)
	16. Activities associated with production including the following:	2-7-1(40)(P)
	<input type="checkbox"/> Closed, non-vented, tumblers used for cleaning or deburring metal products without abrasive blasting	
	<input type="checkbox"/> Electrical resistance welding	
	<input type="checkbox"/> CO ₂ lasers, used only on metals and other materials which do not emit HAPs in the process	
	<input type="checkbox"/> Laser trimmers which do not produce fugitive emissions and are equipped with dust collection devices such as bag filter, cyclone, or equivalent device	
	<input type="checkbox"/> Application equipment for hot melt adhesives with no VOC in the adhesive formulation	
	<input type="checkbox"/> Drop hammers or hydraulic presses for forging or metalworking	
	<input checked="" type="checkbox"/> Air compressors and pneumatically operated equipment, including hand tools	
	<input type="checkbox"/> Compressor or pump lubrication and seal oil systems	
	<input type="checkbox"/> Equipment used to mix and package soaps, vegetable oil, grease, animal fat, and nonvolatile aqueous salt solutions, provided appropriate lids and covers are utilized	
	<input type="checkbox"/> Equipment for washing or drying fabricated glass or metal products, if no VOCs or HAPs are used in the process, and no gas, oil or solid fuel is burned	
	<input type="checkbox"/> Handling of solid steel, including coils and slabs, excluding scrap burning, scarfing, and charging into steel making furnaces and vessels	
	17. Miscellaneous equipment, but not emissions associated with the process for which the equipment is used, and activities including the following:	2-7-1(40)(Q)
	<input type="checkbox"/> Equipment used for surface coating, painting, dipping or spraying operation, except those that will emit VOCs or HAPs	
	<input type="checkbox"/> Condensate drains for natural gas and landfill gas	
	<input type="checkbox"/> Electric or steam heated drying ovens and autoclaves, including only the heating emissions and not any associated process emissions	
	<input type="checkbox"/> Salt baths using nonvolatile salts including caustic solutions that do not result in emissions of any regulated air pollutants	
	<input type="checkbox"/> Ozone generators	
	<input type="checkbox"/> Portable dust collectors	
	<input type="checkbox"/> Scrubber systems circulating water based solutions of inorganic salts or bases which are installed to be available for response to emergency situations	
	<input type="checkbox"/> Soil borrow pits	
	<input type="checkbox"/> Manual loading and unloading operations	
	<input type="checkbox"/> Purging of refrigeration devices using a combination of nitrogen and CFC-22 (R-22) as pressure test media	
	<input type="checkbox"/> Construction and demolition operations	
	<input type="checkbox"/> Mechanical equipment gear boxes and vents which are isolated from process materials	
	<input type="checkbox"/> Non-volatile mold release waxes and agents	

Part B: Insignificant Activities

Part B identifies all insignificant activities in operation at the source as defined in 326 IAC 2-7-1(21)(G). **Please use this table as a checklist.** Indicate which activities are present by checking the appropriate box. If applicable, provide the Emissions Unit Identification number that corresponds to the Plant Layout and Process Flow diagrams.

Unit ID	Description of Insignificant Activity	Citation (326 IAC)
	18. Combustion related activities, including the following:	2-7-1(21)(G)(i)
	<input type="checkbox"/> Space heaters, process heaters, or boilers using the following fuels	
	<input type="checkbox"/> Natural gas-fired combustion sources with heat input equal to or less than ten million (10,000,000) Btu per hour	
	<input type="checkbox"/> Propane or liquified petroleum gas, or butane-fired combustion sources with heat input equal to or less than six million (6,000,000) Btu per hour	
	<input type="checkbox"/> Fuel oil-fired combustion sources with heat input equal to or less than two million (2,000,000) Btu per hour and firing fuel containing less than five-tenths percent (0.5%) sulfur by weight	
	<input type="checkbox"/> Wood-fired combustion sources with heat input equal to or less than one million (1,000,000) Btu per hour and not burning wood refuse, treated wood or chemically contaminated wood	
	<input type="checkbox"/> Equipment powered by diesel fuel fired or natural gas fired internal combustion engines of capacity equal to or less than five hundred thousand (500,000) Btu/hour, except where total capacity of equipment operated by one stationary source exceeds two million (2,000,000) Btu/hour	
	<input type="checkbox"/> Combustion source flame safety purging on startup	
	19. Fuel dispensing activities, including the following:	2-7-1(21)(G)(ii)
	<input type="checkbox"/> A gasoline fuel transfer dispensing operation handling less than or equal to one thousand three hundred (1,300) gallons per day and filling storage tanks having a capacity equal to or less than ten thousand five hundred (10,500) gallons. Such storage tanks may be in a fixed location or on mobile equipment	
	<input type="checkbox"/> A petroleum fuel, other than gasoline, dispensing facility, having a storage tank capacity less than or equal to ten thousand five hundred (10,500) gallons, and dispensing three thousand five hundred (3,500) gallons per day or less	
	20. The following VOC and HAP storage containers:	2-7-1(21)(G)(iii)
	<input type="checkbox"/> Storage tanks with capacity less than or equal to one thousand (1,000) gallons and annual throughputs less than twelve thousand (12,000) gallons	
	<input type="checkbox"/> Vessels storing the following:	
	<input type="checkbox"/> Hydraulic oils <input type="checkbox"/> Lubricating oils <input type="checkbox"/> Machining oils <input type="checkbox"/> Machining fluids	
	21. Refractory storage not requiring air pollution control equipment	2-7-1(21)(G)(iv)
	22. Equipment used exclusively for the following	2-7-1(21)(G)(v)
	<input type="checkbox"/> Packaging the following: <input type="checkbox"/> Greases <input type="checkbox"/> Lubricants	
	<input type="checkbox"/> Filling drums, pails or other packaging containers with the following:	
	<input type="checkbox"/> Greases <input type="checkbox"/> Lubricating oils <input type="checkbox"/> Waxes	

This space is intentionally left blank.

Part B: Insignificant Activities (continued)

Part B identifies all insignificant activities in operation at the source as defined in 326 IAC 2-7-1(21)(G). **Please use this table as a checklist.** Indicate which activities are present by checking the appropriate box. If applicable, provide the Emissions Unit Identification number that corresponds to the Plant Layout and Process Flow diagrams.

Unit ID	Description of Insignificant Activity	Citation (326 IAC)
	23. Production related activities, including the following:	2-7-1(21)(G)(vi)
	<input type="checkbox"/> Application of the following as temporary protective coatings:	
	<input type="checkbox"/> Greases <input type="checkbox"/> Lubricants <input type="checkbox"/> Nonvolatile materials <input type="checkbox"/> Oils	
	<input type="checkbox"/> Machining where an aqueous cutting coolant continuously floods the machining interface	
	<input type="checkbox"/> Degreasing operations that do not exceed one hundred forty-five (145) gallons per twelve (12) months, except if subject to 326 IAC 20-6	
	<input type="checkbox"/> Cleaners and solvents characterized as follows where the use of which, for all cleaners and solvents combined, does not exceed one hundred forty-five (145) gallons per twelve (12) months	
	<input type="checkbox"/> Having a vapor pressure equal to or less than two kilo Pascals (2.0 kPa) (fifteen millimeters of mercury (15 mm Hg) or three-tenths pound per square inch (0.3 psi)) measured at thirty-eight degrees Centigrade (38°C) (one hundred degrees Fahrenheit (100°F))	
	<input type="checkbox"/> Having a vapor pressure equal to or less than seven-tenths kilo Pascals (0.7 kPa) (five millimeters of mercury (5 mm Hg) or one-tenth pound per square inch (0.1 psi)) measured at twenty degrees Centigrade (20°C) (sixty-eight degrees Fahrenheit (68°F))	
	<input type="checkbox"/> The following equipment related to manufacturing activities not resulting in the emission of HAPs:	
	<input type="checkbox"/> Brazing equipment <input type="checkbox"/> Cutting torches <input type="checkbox"/> Soldering equipment <input type="checkbox"/> Welding equipment	
	<input type="checkbox"/> Closed loop heating and cooling systems	
	<input type="checkbox"/> Infrared cure equipment	
	<input type="checkbox"/> Exposure chambers (towers or columns) for curing of ultraviolet inks and ultra-violet coatings where heat is the intended discharge	
	<input type="checkbox"/> Any of the following structural steel and bridge fabrication activities:	
	<input type="checkbox"/> Cutting two hundred thousand (200,000) linear feet or less of one (1) inch plate or equivalent	
	<input type="checkbox"/> Using eighty (80) tons or less of welding consumables	
	24. Activities associated with the following recovery systems:	2-7-1(21)(G)(vii)
	<input type="checkbox"/> Rolling oil recovery systems	
	<input type="checkbox"/> Groundwater oil recovery wells	
	25. Solvent recycling systems with batch capacity less than or equal to one hundred (100) gallons	2-7-1(21)(G)(viii)

This space is intentionally left blank.

Part B: Insignificant Activities (continued)

Part B is intended to identify all insignificant activities in operation at the source as defined in 326 IAC 2-7-1(21)(G). **Please use this table as a checklist.** Indicate which activities are present by checking the appropriate box. If applicable, provide the Emissions Unit Identification number that corresponds to the Plant Layout and Process Flow diagrams.

Unit ID	Description of Insignificant Activity	Citation (326 IAC)
	26. Water-based activities, including the following:	2-7-1(21)(G)(ix)
	<input type="checkbox"/> Activities associated with the treatment of wastewater streams with an oil and grease content less than or equal to one percent (1%) by volume	
	<input type="checkbox"/> Water runoff ponds for petroleum coke-cutting and coke storage piles	
	<input type="checkbox"/> Activities associated with the transportation and treatment of sanitary sewage, provided discharge to the treatment plant is under the control of the owner/operator, that is, an on-site sewage treatment facility	
	<input type="checkbox"/> Any operation using aqueous solutions containing less than one percent (1%) by weight of VOCs excluding HAPs	
	<input type="checkbox"/> Water based adhesives that are less than or equal to five percent (5%) by volume of VOCs excluding HAPs	
	<input type="checkbox"/> Noncontact cooling tower systems with either of the following:	
	<input type="checkbox"/> Natural draft cooling towers not regulated under a NESHAP	
	<input type="checkbox"/> Forced and induced draft cooling tower systems not regulated under a NESHAP	
	<input type="checkbox"/> Quenching operations used with heat treating processes	
	27. Repair activities, including the following:	2-7-1(21)(G)(x)
	<input type="checkbox"/> Replacement or repair of electrostatic precipitators, bags in baghouses and filters in other air filtration equipment	
	<input type="checkbox"/> Heat exchanger cleaning and repair	
	<input type="checkbox"/> Process vessel degassing and cleaning to prepare for internal repairs	
	28. Trimmers that do not produce fugitive emissions and that are equipped with a dust collection or trim material recovery device, such as a bag filter or cyclone	2-7-1(21)(G)(xi)
	29. Stockpiled soils from soil remediation activities that are covered and waiting transport for disposal	2-7-1(21)(G)(xii)
	30. Paved and unpaved roads and parking lots with public access	2-7-1(21)(G)(xiii)
	31. Conveyors as follows:	2-7-1(21)(G)(xiv)
	<input type="checkbox"/> Covered conveyors for solid raw material, including the following:	
	<input type="checkbox"/> Coal or coke conveying of less than or equal to three hundred sixty (360) tons per day	
	<input type="checkbox"/> Limestone conveying of less than or equal to seven thousand two hundred (7,200) tons per day for sources other than mineral processing plants constructed after August 31, 1983	
	<input type="checkbox"/> Uncovered coal or coke conveying of less than or equal to one hundred twenty (120) tons per day	
	<input type="checkbox"/> Underground conveyors	
	<input type="checkbox"/> Enclosed systems for conveying plastic raw materials and plastic finished goods	
	32. Coal bunker and coal scale exhausts and associated dust collector vents	2-7-1(21)(G)(xv)
	33. Asbestos abatement projects regulated by 326 IAC 14-10	2-7-1(21)(G)(xvi)

This space is intentionally left blank.

Part B: Insignificant Activities (continued)

Part B is intended to identify all insignificant activities in operation at the source as defined in 326 IAC 2-7-1(21)(G). **Please use this table as a checklist.** Indicate which activities are present by checking the appropriate box. If applicable, provide the Emissions Unit Identification number that corresponds to the Plant Layout and Process Flow diagrams.

Unit ID	Description of Insignificant Activity	Citation (326 IAC)
	34. Routine maintenance and repair of buildings, structures, or vehicles at the source where air emissions from those activities would not be associated with any production process, including the following: <input type="checkbox"/> Purging of gas lines <input type="checkbox"/> Purging of vessels	2-7-1(21)(G)(xvii)
	35. Flue gas conditioning systems and associated chemicals such as the following: <input type="checkbox"/> Sodium sulfate <input type="checkbox"/> Ammonia <input type="checkbox"/> Sulfur trioxide.	2-7-1(21)(G)(xviii)
	36. Equipment used to collect any material that might be released during a malfunction, process upset, or spill cleanup, including the following: <input type="checkbox"/> Catch tanks <input type="checkbox"/> Temporary liquid separators <input type="checkbox"/> Tanks <input type="checkbox"/> Fluid handling equipment	2-7-1(21)(G)(xix)
	37. Blowdown for the following: <input type="checkbox"/> Sight glass <input type="checkbox"/> Boiler <input type="checkbox"/> Compressors <input type="checkbox"/> Pumps <input type="checkbox"/> Cooling tower	2-7-1(21)(G)(xx)
	38. Furnaces used for melting metals other than beryllium with a brim full capacity of less than or equal to four hundred fifty (450) cubic inches by volume	2-7-1(21)(G)(xxi)
	39. Activities associated with emergencies, including the following: <input type="checkbox"/> On-site fire training approved by the IDEM <input type="checkbox"/> Emergency generators as follows: <input type="checkbox"/> Gasoline generators not exceeding one hundred ten (110) horsepower <input type="checkbox"/> Diesel generators not exceeding one thousand six hundred (1,600) horsepower <input type="checkbox"/> Natural gas turbines or reciprocating engines not exceeding sixteen thousand (16,000) horsepower <input type="checkbox"/> Stationary fire pump engines	2-7-1(21)(G)(xxii)
	40. Grinding and machining operations controlled with fabric filters, scrubbers, mist collectors, wet collectors and electrostatic precipitators with a design grain loading of less than or equal to three one-hundredths grains per actual cubic foot (0.03 gr/acf) and a gas flow rate less than or equal to four thousand actual cubic feet per minute (4,000 acf/min), including the following: <input type="checkbox"/> Deburring <input type="checkbox"/> Polishing <input type="checkbox"/> Pneumatic conveying <input type="checkbox"/> Buffing <input type="checkbox"/> Abrasive blasting <input type="checkbox"/> Woodworking operations	2-7-1(21)(G)(xxiii)
	41. Purge double block and bleed valves	2-7-1(21)(G)(xxiv)
	42. Filter or coalescer media changeout	2-7-1(21)(G)(xxv)
	43. Vents from ash transport systems not operated at positive pressure	2-7-1(21)(G)(xxvi)
	44. Mold release agents using low volatile products (vapor pressure less than or equal to two kilo Pascals (2kPa) measured at thirty-eight degrees Centigrade (38°C)	2-7-1(21)(G)(xxvii)
	45. Farm operations	2-7-1(21)(G)(xxviii)

This space is intentionally left blank.

Part B: Insignificant Activities (continued)

Part B identifies all insignificant activities in operation at the source as defined in 326 IAC 2-7-1(21)(G). **Please use this table as a checklist.** Indicate which activities are present by checking the appropriate box. If applicable, provide the Emissions Unit Identification number that corresponds to the Plant Layout and Process Flow diagrams.

Unit ID	Description of Insignificant Activity	Citation (326 IAC)
	46. Woodworking equipment controlled by a baghouse provided that the following criteria are met:	2-7-1(21)(G)(xxix)
	<input type="checkbox"/> The baghouse does not exhaust to the atmosphere greater than one hundred twenty-five thousand (125,000) cubic feet per minute	
	<input type="checkbox"/> The baghouse does not emit particulate matter with a diameter less than ten (10) microns in excess of three-thousandths grains per dry standard cubic feet (0.003 gr/dscf) of outlet air	
	<input type="checkbox"/> Opacity from the baghouse does not exceed ten percent (10%)	
	<input type="checkbox"/> The baghouse is in operation at all times the woodworking equipment is in use	
	<input type="checkbox"/> Visible emissions from the baghouse are observed daily using procedures in accordance with 40 CFR 60, Appendix A, Method 22 and normal or abnormal emissions are recorded. In the event abnormal emissions are observed for greater than six (6) minutes in duration, the following shall occur:	
	<input type="checkbox"/> The baghouse shall be inspected	
	<input type="checkbox"/> Corrective actions, such as replacing or reseating bags, are initiated, when necessary	
	<input type="checkbox"/> The baghouse is inspected quarterly when vented to the atmosphere	
	<input type="checkbox"/> The owner or operator keeps the following records:	
	<input type="checkbox"/> Records documenting the date when the baghouse redirected indoors or to the atmosphere	
	<input type="checkbox"/> Quarterly inspection reports, when vented to the atmosphere	
	<input type="checkbox"/> Visible observation reports	
	<input type="checkbox"/> Records of corrective actions	
	47. Woodworking equipment controlled by a baghouse provided that the following criteria are met:	2-7-1(21)(G)(xxx)
	<input type="checkbox"/> The baghouse does not exhaust to the atmosphere greater than forty thousand (40,000) cubic feet per minute	
	<input type="checkbox"/> The baghouse does not emit particulate matter with a diameter less than ten (10) microns in excess of one-hundredth grains per dry standard cubic feet (0.01 gr/dscf) of outlet air	
	<input type="checkbox"/> Opacity from the baghouse does not exceed ten percent (10%)	
	<input type="checkbox"/> The baghouse is in operation at all times the woodworking equipment is in use	
	<input type="checkbox"/> Visible emissions from the baghouse are observed daily using procedures in accordance with 40 CFR 60, Appendix A, Method 22 and normal or abnormal emissions are recorded. In the event abnormal emissions are observed for greater than six (6) minutes in duration, the following shall occur:	
	<input type="checkbox"/> The baghouse shall be inspected	
	<input type="checkbox"/> Corrective actions, such as replacing or reseating bags, are initiated, when necessary	
	<input type="checkbox"/> The baghouse is inspected quarterly when vented to the atmosphere	
	<input type="checkbox"/> The owner or operator keeps the following records:	
	<input type="checkbox"/> Records documenting the date when the baghouse redirected indoors or to the atmosphere	
	<input type="checkbox"/> Quarterly inspection reports, when vented to the atmosphere	
	<input type="checkbox"/> Visible observation reports	
	<input type="checkbox"/> Records of corrective actions	

Part E: Insignificant Activities with HAP Emissions

Part D identifies all insignificant activities in operation at the source (as defined in 326 IAC 2-7-1(21)(C)) that have the potential to emit hazardous air pollutants (HAP). These activities may or may not be identified above in Parts A, B, or D. **Activities listed in Part C above, need not be listed in this section.** Indicate which type of "Insignificant HAP Activities" are present by checking the appropriate box, and provide a brief description.

52. Individual HAP Emissions:

Identify any emissions unit, not regulated by a NESHAP, emitting greater than 1 pound per day but less than 5 pounds per day or 1 ton per year of a single HAP.

Emissions Unit	HAP	Brief Description	Applicable Requirements

53. Combination HAP Emissions:

Identify any emissions unit, not regulated by a NESHAP, emitting greater than 1 pound per day but less than 12.5 pounds per day or 2.5 ton per year of a combination of HAPs.

Emissions Unit	HAPs	Brief Description	Applicable Requirements

DIANA SUGARS
BOX 64799
VIRGINIA ST.
RY, IN. 46401

Retail



46204

RDC 99

U.S. POSTAGE PAID
FCM LG ENV
GARY, IN 46401
JAN 11, 2024

\$2.79

R2304N117536-32

IDEM - OFFICE OF AIR QUALITY - PERMITS BRANCH
100 N SENATE AVENUE MC 61-53 ROOM 1603
INDIANAPOLIS, IN. 46204-2251

Received
State of Indiana
JAN 16 2024
Dept of Environmental Mgmt
Office of Air Quality

Received
State of Indiana
1 16 24
Dept of Environmental Mgmt
Office of Air Quality

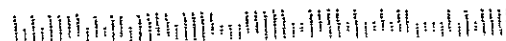

From: [Palyshniuk, Kateryna](mailto:Katyryna.Palyshniuk@idem.in.gov)
To: rexa@buysugars.com
Subject: IDEM OAQ Contact Information for Application No. 089-47394-00490 for Indiana Sugars, Inc.
Date: Tuesday, January 9, 2024 11:20:00 AM
Attachments: [image001.png](#)
[image002.png](#)
[image003.png](#)
[image004.png](#)
[image005.png](#)
[image006.png](#)
[image007.png](#)

Dear Rex Anderson,

I am the permit writer assigned to the current application No. 089-47394-00490 for Indiana Sugars, Inc. I would like to extend to you my contact information so that we may have continued communication until your new permit is issued. Please keep this information at hand. It is common for questions to arise, and oftentimes, further clarification is needed during the permit review process.

To expedite the review process, please e-mail me the **electronic copy of your calculations (preferably in excel format)** and other supporting documents used as part of your application.

Based on my preliminary review of the application, please indicate whether the company name is **Indiana Sugars** or **Indiana Sugars, Inc.**

IDEM, OAQ will notify you when a draft permit has been submitted for public notice and/or when a final permit has been issued. As part of the notification, IDEM, OAQ will provide information on how to access the draft and/or final permit electronically on IDEM's website. If Indiana Sugars, Inc. would prefer to receive paper copies of the entire draft and/or final permit, please let me know prior to the end of the applicant review period. If you prefer to receive paper copies of the entire permit, IDEM, OAQ will mail a paper copy of the draft permit and/or original signed final permit to the source contact. If you do not request to receive paper copies of the entire permit, IDEM, OAQ will only mail a paper copy of the original signed final permit signature page to the source contact.

Based on my preliminary review of the application, the permit approval that is required for this application will be subject to the public notice requirements of 326 IAC 2-1.1-6. As the permit applicant, you are required to place a copy of the permit application packet for public review at a public library in the county where the source is located (preferably at the local public library nearest to the source in the county where the source is located) within ten (10) days of the submission of the application. In the GSD-01 Form, Part H, **the date that the application packet was filed with the local library** was not provided. Please provide **the date that the application packet was filed with the local library** and confirm whether (or not) a copy of the application packet was placed at the local library.

Please feel free to contact me at any time if you have questions, concerns, or important information regarding your permit. For your convenience, my section chief Balogun, Josiah K may be contacted at 317-234-1203 or jbalogun@idem.IN.gov.

Thank you in advance for your time and assistance. I look forward to working with you.

Sincerely,

Kate

Indiana Department of
Environmental Management
Kateryna (Kate) Palyshniuk, Ph.D.
Environmental Manager
• (317) 234-0155 • KPalysn@idem.IN.gov

From: [Rex Anderson](#)
To: [Palyshniuk, Kateryna](#)
Subject: RE: IDEM OAQ Contact Information for Application No. 089-47394-00490 for Indiana Sugars, Inc.
Date: Wednesday, January 10, 2024 2:05:52 PM
Attachments: [image009.png](#)
[image010.png](#)
[image011.png](#)
[image012.png](#)
[image013.png](#)
[image014.png](#)
[image015.png](#)
[Air permit correction.pdf](#)

****** This is an EXTERNAL email. Exercise caution. DO NOT open attachments or click links from unknown senders or unexpected email. ******

Good afternoon Kate,

Please find attached copies of the air permit application with the correct company name of Indiana Sugars Inc.

Also please find the forms with the emissions data.

Rex Anderson
Indiana Sugars
Maintenance Manager
219-886-9151 ex:233
Cell: 219-290-6884
rexa@buysugars.com



From: Palyshniuk, Kateryna <KPalyshn@idem.IN.gov>
Sent: Tuesday, January 9, 2024 10:20 AM
To: Rex Anderson <rexa@buysugars.com>
Subject: IDEM OAQ Contact Information for Application No. 089-47394-00490 for Indiana Sugars, Inc.

CAUTION: This email originated from outside of Indiana Sugars. Do not click links or open attachments unless you recognize the sender. If you suspect this is spam, forward this email to spam@buysugars.com.

Dear Rex Anderson,

I am the permit writer assigned to the current application No. 089-47394-00490 for Indiana Sugars, Inc. I would like to extend to you my contact information so that we may have continued communication until your new permit is issued. Please keep this information at hand. It is common for questions to arise, and oftentimes, further clarification is needed during the permit review process.

To expedite the review process, please e-mail me the **electronic copy of your calculations (preferably in excel format)** and other supporting documents used as part of your application.

Based on my preliminary review of the application, please indicate whether the company name is **Indiana**

Sugars or Indiana Sugars, Inc.

IDEM, OAQ will notify you when a draft permit has been submitted for public notice and/or when a final permit has been issued. As part of the notification, IDEM, OAQ will provide information on how to access the draft and/or final permit electronically on IDEM's website. If Indiana Sugars, Inc. would prefer to receive paper copies of the entire draft and/or final permit, please let me know prior to the end of the applicant review period. If you prefer to receive paper copies of the entire permit, IDEM, OAQ will mail a paper copy of the draft permit and/or original signed final permit to the source contact. If you do not request to receive paper copies of the entire permit, IDEM, OAQ will only mail a paper copy of the original signed final permit signature page to the source contact.

Based on my preliminary review of the application, the permit approval that is required for this application will be subject to the public notice requirements of 326 IAC 2-1.1-6. As the permit applicant, you are required to place a copy of the permit application packet for public review at a public library in the county where the source is located (preferably at the local public library nearest to the source in the county where the source is located) within ten (10) days of the submission of the application. In the GSD-01 Form, Part H, **the date that the application packet was filed with the local library** was not provided. Please provide **the date that the application packet was filed with the local library** and confirm whether (or not) a copy of the application packet was placed at the local library.

Please feel free to contact me at any time if you have questions, concerns, or important information regarding your permit. For your convenience, my section chief Balogun, Josiah K may be contacted at 317-234-1203 or jbalogun@idem.IN.gov.

Thank you in advance for your time and assistance. I look forward to working with you.

Sincerely,

Kate



Indiana Department of
Environmental Management

Kateryna (Kate) Palyshniuk, Ph.D.
Environmental Manager

• (317) 234-0155 • KPalyshn@idem.IN.gov

Protecting Hoosiers and Our Environment

 | www.idem.IN.gov

Help us improve!

IDEM values your feedback





AIR PERMIT APPLICATION COVER SHEET
 State Form 50639 (R4 / 1-10)
INDIANA DEPARTMENT OF ENVIRONMENTAL MANAGEMENT

IDEM – Office of Air Quality – Permits Branch
 100 N. Senate Avenue, MC 61-53 Room 1003
 Indianapolis, IN 46204-2251
 Telephone: (317) 233-0178 or
 Toll Free: 1-800-451-6027 x30178 (within Indiana)
 Facsimile Number: (317) 232-6749
www.IN.gov/idem

NOTES:

- The purpose of this cover sheet is to obtain the core information needed to process the air permit application. This cover sheet is required for all air permit applications submitted to IDEM, OAQ. Place this cover sheet on top of all subsequent forms and attachments that encompass your air permit application packet.
- Submit the completed air permit application packet, including all forms and attachments, to **IDEM Air Permits Administration** using the address in the upper right hand corner of this page.
- IDEM will send a bill to collect the filing fee and any other applicable fees.
- Detailed instructions for this form are available on the Air Permit Application Forms website.

FOR OFFICE USE ONLY	
PERMIT NUMBER:	
DATE APPLICATION WAS RECEIVED:	

1. Tax ID Number: 35-0412510

PART A: Purpose of Application

Part A identifies the purpose of this air permit application. For the purposes of this form, the term "source" refers to the plant site as a whole and NOT to individual emissions units.

2. Source / Company Name: Indiana Sugars, Inc.	3. Plant ID: 089 – 0490	
4. Billing Address: 911 Virginia Street		
City: Gary	State: IN	ZIP Code: 46402 – 2705
5. Permit Level: <input type="checkbox"/> Exemption <input type="checkbox"/> Registration <input type="checkbox"/> SSOA <input checked="" type="checkbox"/> MSOP <input type="checkbox"/> FESOP <input type="checkbox"/> TVOP <input type="checkbox"/> PBR		
6. Application Summary: Check all that apply. Multiple permit numbers may be assigned as needed based on the choices selected below.		
<input type="checkbox"/> Initial Permit	<input checked="" type="checkbox"/> Renewal of Operating Permit	<input type="checkbox"/> Asphalt General Permit
<input type="checkbox"/> Review Request	<input type="checkbox"/> Revocation of Operating Permit	<input type="checkbox"/> Alternate Emission Factor Request
<input type="checkbox"/> Interim Approval	<input type="checkbox"/> Relocation of Portable Source	<input type="checkbox"/> Acid Deposition (Phase II)
<input type="checkbox"/> Site Closure	<input type="checkbox"/> Emission Reduction Credit Registry	
<input type="checkbox"/> Transition (between permit levels) From: To:		
<input checked="" type="checkbox"/> Administrative Amendment:	<input type="checkbox"/> Company Name Change	<input checked="" type="checkbox"/> Change of Responsible Official
	<input type="checkbox"/> Correction to Non-Technical Information	<input type="checkbox"/> Notice Only Change
	<input type="checkbox"/> Other (specify):	
<input type="checkbox"/> Modification:	<input type="checkbox"/> New Emission Unit or Control Device	<input type="checkbox"/> Modified Emission Unit or Control Device
	<input type="checkbox"/> New Applicable Permit Requirement	<input type="checkbox"/> Change to Applicability of a Permit Requirement
	<input type="checkbox"/> Prevention of Significant Deterioration	<input type="checkbox"/> Emission Offset <input type="checkbox"/> MACT Preconstruction Review
	<input type="checkbox"/> Minor Source Modification	<input type="checkbox"/> Significant Source Modification
	<input type="checkbox"/> Minor Permit Modification	<input type="checkbox"/> Significant Permit Modification
	<input type="checkbox"/> Other (specify):	
7. Is this an application for an initial construction and/or operating permit for a "Greenfield" Source? <input type="checkbox"/> Yes <input checked="" type="checkbox"/> No		
8. Is this an application for construction of a new emissions unit at an Existing Source? <input type="checkbox"/> Yes <input checked="" type="checkbox"/> No		

PART B: Pre-Application Meeting

Part B specifies whether a meeting was held or is being requested to discuss the permit application.

9. Was a meeting held between the company and IDEM prior to submitting this application to discuss the details of the project?

No Yes: *Date:*

10. Would you like to schedule a meeting with IDEM management and your permit writer to discuss the details of this project?

No Yes: *Proposed Date for Meeting:*

PART C: Confidential Business Information

Part C identifies permit applications that require special care to ensure that confidential business information is kept separate from the public file.

Claims of confidentiality must be made at the time the information is submitted to IDEM, and must follow the requirements set out in the Indiana Administrative Code (IAC). To ensure that your information remains confidential, refer to the IDEM, OAQ information regarding submittal of confidential business information. For more information on confidentiality for certain types of business information, please review IDEM's Nonrule Policy Document Air-031-NPD regarding Emission Data.

11. Is any of the information contained within this application being claimed as **Confidential Business Information**?

No Yes

PART D: Certification Of Truth, Accuracy, and Completeness

Part D is the official certification that the information contained within the air permit application packet is truthful, accurate, and complete. Any air permit application packet that we receive without a signed certification will be deemed incomplete and may result in denial of the permit.

For a Part 70 Operating Permit (TVOP) or a Source Specific Operating Agreement (SSOA), a "responsible official" as defined in 326 IAC 2-7-1(34) must certify the air permit application. For all other applicants, this person is an "authorized Individual" as defined in 326 IAC 2-1.1-1(1).

I certify under penalty of law that, based on information and belief formed after reasonable inquiry, the statements and information contained in this application are true, accurate, and complete.

Jeremy Renteria
Name (typed)

Director of Midwest Region Operations
Title

Jeremy Renteria
Signature

1/5/2024
Date



OAQ GENERAL SOURCE DATA APPLICATION
GSD-01: Basic Source Level Information
 State Form 50640 (R5 / 1-10)
 INDIANA DEPARTMENT OF ENVIRONMENTAL MANAGEMENT

IDEM – Office of Air Quality – Permits Branch
 100 N. Senate Avenue, MC 61-53 Room 1003
 Indianapolis, IN 46204-2251
 Telephone: (317) 233-0178 or
 Toll Free: 1-800-451-6027 x30178 (within Indiana)
 Facsimile Number: (317) 232-6749
www.IN.gov/idem

- NOTES:**
- The purpose of GSD-01 is to provide essential information about the entire source of air pollutant emissions. GSD-01 is a required form.
 - Detailed instructions for this form are available on the Air Permit Application Forms website.
 - All information submitted to IDEM will be made available to the public unless it is submitted under a claim of confidentiality. Claims of confidentiality must be made at the time the information is submitted to IDEM, and must follow the requirements set out in 326 IAC 17.1-4-1. Failure to follow these requirements exactly will result in your information becoming a public record, available for public inspection.

PART A: Source / Company Location Information

1. Source / Company Name: Indiana Sugars, Inc.		2. Plant ID: 089 – 0490	
3. Location Address: 911 Virginia			
City: Gary	State: IN	ZIP Code: 46402 – 2705	
4. County Name: Lake		5. Township Name:	
6. Geographic Coordinates:			
Latitude: 41.6002396		Longitude: -87.3314166	
7. Universal Transverse Mercator Coordinates (if known):			
Zone:	Horizontal:	Vertical:	
8. Adjacent States: Is the source located within 50 miles of an adjacent state?			
<input type="checkbox"/> No <input checked="" type="checkbox"/> Yes – Indicate Adjacent State(s): <input checked="" type="checkbox"/> Illinois (IL) <input checked="" type="checkbox"/> Michigan (MI) <input type="checkbox"/> Ohio (OH) <input type="checkbox"/> Kentucky (KY)			
9. Attainment Area Designation: Is the source located within a non-attainment area for any of the criteria air pollutants?			
<input checked="" type="checkbox"/> No <input type="checkbox"/> Yes – Indicate Nonattainment Pollutant(s): <input type="checkbox"/> CO <input type="checkbox"/> Pb <input type="checkbox"/> NO _x <input type="checkbox"/> O ₃ <input type="checkbox"/> PM <input type="checkbox"/> PM ₁₀ <input type="checkbox"/> PM _{2.5} <input type="checkbox"/> SO ₂			
10. Portable / Stationary: Is this a portable or stationary source?			
		<input type="checkbox"/> Portable	<input checked="" type="checkbox"/> Stationary

PART B: Source Summary

11. Company Internet Address (optional):	
12. Company Name History: Has this source operated under any other name(s)?	
<input checked="" type="checkbox"/> No <input type="checkbox"/> Yes – Provide information regarding past company names in Part I, Company Name History.	
13. Portable Source Location History: Will the location of the portable source be changing in the near future?	
<input checked="" type="checkbox"/> Not Applicable <input type="checkbox"/> No <input type="checkbox"/> Yes – Complete Part J, Portable Source Location History, and Part K, Request to Change Location of Portable Source.	
14. Existing Approvals: Have any exemptions, registrations, or permits been issued to this source?	
<input type="checkbox"/> No <input checked="" type="checkbox"/> Yes – List these permits and their corresponding emissions units in Part M, Existing Approvals.	
15. Unpermitted Emissions Units: Does this source have any unpermitted emissions units?	
<input checked="" type="checkbox"/> No <input type="checkbox"/> Yes – List all unpermitted emissions units in Part N, Unpermitted Emissions Units.	
16. New Source Review: Is this source proposing to construct or modify any emissions units?	
<input checked="" type="checkbox"/> No <input type="checkbox"/> Yes – List all proposed new construction in Part O, New or Modified Emissions Units.	
17. Risk Management Plan: Has this source submitted a Risk Management Plan?	
<input type="checkbox"/> Not Required <input checked="" type="checkbox"/> No <input type="checkbox"/> Yes → Date submitted: _____ EPA Facility Identifier: – –	

PART C: Source Contact Information

IDEM will send the original, signed permit decision to the person identified in this section. This person MUST be an employee of the permitted source.

18. Name of Source Contact Person: Rex Anderson

19. Title (optional): Maintenance Manager

20. Mailing Address: 911 Virginia Street

City: Gary

State: IN

ZIP Code: 46402 - 2705

21. Electronic Mail Address (optional): rexa@buysugars.com

22. Telephone Number: (219) 886 - 9151

23. Facsimile Number (optional): () -

PART D: Authorized Individual/Responsible Official Information

IDEM will send a copy of the permit decision to the person indicated in this section, if the Authorized Individual or Responsible Official is different from the Source Contact specified in Part C.

24. Name of Authorized Individual or Responsible Official: Jeremy Renteria

25. Title: Manager of Midwest Region Operations

26. Mailing Address: 911 Virginia Street

City: Gary

State: IN

ZIP Code: 46402 - 2705

27. Telephone Number: (219) 886 - 9151

28. Facsimile Number (optional): () -

29. Request to Change the Authorized Individual or Responsible Official: Is the source officially requesting to change the person designated as the Authorized Individual or Responsible Official in the official documents issued by IDEM, OAQ? *The permit may list the title of the Authorized Individual or Responsible Official in lieu of a specific name.*

No Yes - **Change Responsible Official to:**

PART E: Owner Information

30. Company Name of Owner: Ron Yonover

31. Name of Owner Contact Person:

32. Mailing Address: 911 Virginia Street

City: Gary

State: IN

ZIP Code: 46402 - 2705

33. Telephone Number: (219) 886 - 9151

34. Facsimile Number (optional): () -

34. Operator: Does the "Owner" company also operate the source to which this application applies?

No - Proceed to Part F below. Yes - Enter "SAME AS OWNER" on line 35 and proceed to Part G below.

PART F: Operator Information

35. Company Name of Operator:

36. Name of Operator Contact Person:

37. Mailing Address:

City:

State:

ZIP Code: -

38. Telephone Number: () -

39. Facsimile Number (optional): () -

PART G: Agent Information		
40. Company Name of Agent:		
41. Type of Agent: <input type="checkbox"/> Environmental Consultant <input type="checkbox"/> Attorney <input type="checkbox"/> Other (specify):		
42. Name of Agent Contact Person:		
43. Mailing Address:		
City:	State:	ZIP Code: -
44. Electronic Mail Address (optional):		
45. Telephone Number: () -	46. Facsimile Number (optional): () -	
47. Request for Follow-up: Does the "Agent" wish to receive a copy of the preliminary findings during the public notice period (if applicable) and a copy of the final determination? <input type="checkbox"/> No <input type="checkbox"/> Yes		

PART H: Local Library Information		
48. Date application packet was filed with the local library: 1/10/2024		
49. Name of Library: Gary Public Library		
50. Name of Librarian (optional):		
51. Mailing Address: 220 W. 5th AVE.		
City: GARY	State: IN	ZIP Code: 46402 -
52. Internet Address (optional):		
53. Electronic Mail Address (optional):		
54. Telephone Number: (219) 886 - 2484	55. Facsimile Number (optional): () -	

PART I: Company Name History (if applicable)	
Complete this section only if the source has previously operated under a legal name that is different from the name listed above in Section A.	
56. Legal Name of Company	57. Dates of Use
	to
	to
	to
	to
	to
	to
	to
	to
	to
	to
58. Company Name Change Request: Is the source officially requesting to change the legal name that will be printed on all official documents issued by IDEM, OAQ? <input type="checkbox"/> No <input type="checkbox"/> Yes - Change Company Name to:	

PART L: Source Process Description

Complete this section to summarize the main processes at the source.

64. Process Description	65. Products	66. SIC Code	67. NAICS Code
Cane Sugar Refining	Confectioner's Sugar, Color Sugar, Brown sugar, Liquid sugar	2062	311314
Beet Sugar Refining	Confectioner's Sugar, Color Sugar, Brown Sugar, Liquid Sugar	2063	311313

PART M: Existing Approvals (if applicable)

Complete this section to summarize the approvals issued to the source since issuance of the main operating permit.

68. Permit ID	69. Emissions Unit IDs	70. Expiration Date
M089-41863-00490	Unit 1, Unit 1A Unit 2, Unit 2A, Unit 5, Unit 6, Unit 7, Unit 8, Unit 9, Unit 10,Unit 11,Unit 12, Unit 13	May,7, 2024
M089-34016-00490	Unit 1, Unit 1A, Unit 2, Unit 2A, Unit 5, Unit 6, Unit 7,Unit 8, Unit 9,Unit 10, Unit 11, Unit 12	May,7, 2024
M089-27251-00490	Unit 1, Unit 1A, Unit 2, Unit 2A, Unit 5, Unit 6, Unit 7,Unit 8, Unit 9,Unit 10, Unit 11, Unit 12	May,19, 2014

PART N: Unpermitted Emissions Units (if applicable)

Complete this section only if the source has emission units that are not listed in any permit issued by IDEM, OAQ.

71. Emissions Unit ID	72. Type of Emissions Unit	73. Actual Dates		
		Began Construction	Completed Construction	Began Operation

PART O: New or Modified Emissions Units (if applicable)

Complete this section only if the source is proposing to add new emission units or modify existing emission units.

74. Emissions Unit ID	75. NEW	76. MOD	77. Type of Emissions Unit	78. Estimated Dates		
				Begin Construction	Complete Construction	Begin Operation



OAQ GENERAL SOURCE DATA APPLICATION
GSD-04: Stack / Vent Information
 State Form 51606 (R3 / 1-10)
 INDIANA DEPARTMENT OF ENVIRONMENTAL MANAGEMENT

IDEM – Office of Air Quality – Permits Branch
 100 N. Senate Avenue, MC 61-53 Room 1003
 Indianapolis, IN 46204-2251
 Telephone: (317) 233-0178 or
 Toll Free: 1-800-451-6027 x30178 (within Indiana)
 Facsimile Number: (317) 232-6749
www.IN.gov/idem

NOTES:

- The purpose of this form is to provide basic information about each stack or vent that has the potential to emit air pollutants. If you do not provide enough information to adequately describe each process vent and/or stack, the application process may be stopped. This form is required for all air permit applications.
- Detailed instructions for this form are available online on the Air Permit Application Forms website.
- All information submitted to IDEM will be made available to the public unless it is submitted under a claim of confidentiality. Claims of confidentiality must be made at the time the information is submitted to IDEM, and must follow the requirements set out in 326 IAC 17.1-4-1. Failure to follow these requirements exactly will result in your information becoming a public record, available for public inspection.

Stack / Vent Information							
This table provides detailed information about each stack or vent through which air pollutants could be released into the atmosphere. If an air stream is vented inside a building, the vent does not need to be listed on this form. If additional space is needed, you may make a copy of this form.							
1. Stack / Vent ID	2. Type (V H W O)	3. Shape (C R O)	4. Outlet Dimensions (feet)	5. Height (feet)	6. Maximum Outlet Flow Rate (acfm)	7. Outlet Gas Temperature (Degrees F)	8. Related Stacks / Vents (B P O)
Stack 1	V	C	.8	38	4500	158	Stack 2 (P)
Stack 1A	W	C	.33	5	380	145	Stack 2A (P)
Stack 2	V	C	.8	38	3500	134	Stack 1 (P)
Stack 2A	W	C	.33	5	380	145	Stack 1A (P)
Stack 5	W	C	.75 X 1.17	20	2112	100	
Stack 6	W	C	.33	64	1000	95	
Stack 7	H	R	.33	64	1000	95	
Stack 8	V	R	1.5 X 2.25	8	15000	95	
Stack 9	V	C	.92	47	3200	90	
Stack 11	V	C	.67	30	1000	94	
Stack B1	V	C	1.16	20	4500	450	Stack B2 (P)
Stack B2	V	C	1.16	20	4500	450	Stack B1 (P)



OAQ GENERAL SOURCE DATA APPLICATION

GSD-05: Emissions Unit Information

State Form 51610 (R3 / 1-10)

INDIANA DEPARTMENT OF ENVIRONMENTAL MANAGEMENT

IDEM – Office of Air Quality – Permits Branch
 100 N. Senate Avenue, MC 61-53 Room 1003
 Indianapolis, IN 46204-2251
 Telephone: (317) 233-0178 or
 Toll Free: 1-800-451-6027 x30178 (within Indiana)
 Facsimile Number: (317) 232-6749
www.IN.gov/idem

NOTES:

- The purpose of this form is to provide basic information about each emissions unit that has the potential to emit air pollutants. This form is required for all air permit applications.
- Detailed instructions for this form are available online on the Air Permit Application Forms website.
- All information submitted to IDEM will be made available to the public unless it is submitted under a claim of confidentiality. Claims of confidentiality must be made at the time the information is submitted to IDEM, and must follow the requirements set out in 326 IAC 17.1-4-1. Failure to follow these requirements exactly will result in your information becoming a public record, available for public inspection.

Emissions Unit Information							
This table provides detailed information about each emissions unit that has the potential to emit air pollutants to the atmosphere. Accurate information is needed to determine the total potential to emit. If you do not provide enough information to adequately describe each emissions unit, the application process may be stopped. If additional space is needed, you may make a copy of this form.							
1. Unit ID	2. Model Number	3. Serial Number	4. Description	5. Manufacturer	6. Installation Date	7. Maximum Capacity	8. Stack / Vent ID
1	144-TRW-8		#1 SUGAR MILL	MIKRO-PULSAIRE	1982	7,500 lb/hr	1
1A	58AV14		#1 BULK TRANSPORT	SCHICK	1982	7,500 lb/hr	1A
2	42-6-1000	810 45H1	#2 SUGAR MILL	MIKRO-PULSAIRE	1982	7,500 lb/hr	2
2A	58AV14		#2 BULK TRANSPORT	SCHICK	1982	7,500 lb/hr	2A
5	85-6-50	80 H5304	Bagging Nuisance	MICRO-PULSAIRE	1992	15,000 lb/hr	5
6	72AVSC36:60S		Granulated Sugar Operation	USS BIN VENT	2002	40,000 lb/hr	6
7	84-BF-016-C	6051	Truck Unload	C.P.E FILTERS INC.	2004	50,000 lb/hr	7
8	144LST144 STY III	134260-001-1	Bagging and Reclaim	MAC	2009	15,000 lb/hr	8
9	CAT		Melt Tanks	AT INDUSTRIAL PRODUCTS	2009	32,400 lb/batch	9
10	MP-10	62287	Panning Dust collector	SCIENTIFIC	2004	15,000 lb/hr	
11	TD 486	3071077	Bulk Loadout	DONALDSON TORIT	2008	50,000 lb/hr	11
12	SPJ-30-X4B8	62814	Boxing Nuisance	SCIENTIFIC	2004	15,000 lb/hr	
B1	H3S-100-G	R 4194	Boiler 1	KEWANEE	1982	4135 MBH/hr	B1
B2	H3S-100-G	R 4192	Boiler 2	KEWANEE	1982	4135 MBH/hr	B2



OAQ GENERAL SOURCE DATA APPLICATION
GSD-06: Particulate Emissions Summary
 State Form 51612 (R3 / 1-10)
 INDIANA DEPARTMENT OF ENVIRONMENTAL MANAGEMENT

IDEM – Office of Air Quality – Permits Branch
 100 N. Senate Avenue, MC 61-53 Room 1003
 Indianapolis, IN 46204-2251
 Telephone: (317) 233-0178 or
 Toll Free: 1-800-451-6027 x30178 (within Indiana)
 Facsimile Number: (317) 232-6749
www.IN.gov/idem

NOTES:

- The purpose of this form is to provide basic information about each source of particulate emissions. This form is required for all air permit applications.
- Detailed instructions for this form are available on the Air Permit Application Forms website.
- All information submitted to IDEM will be made available to the public unless it is submitted under a claim of confidentiality. Claims of confidentiality must be made at the time the information is submitted to IDEM, and must follow the requirements set out in 326 IAC 17.1-4-1. Failure to follow these requirements exactly will result in your information becoming a public record, available for public inspection.

Part A: Particulate Matter Emissions								
Part A provides a summary of the type and amount of particulate emissions at the source. The state rules on particulate emissions are found in Title 326 of the Indiana Administrative Code, Article 6, Particulate Rules. If you do not provide enough information to adequately describe each source of particulate emissions, the application process may be stopped. If additional space is needed, you may make a copy of this table.								
Emissions Point		Potential To Emit (tons per year)						
1. ID	2. Description	3. PM	4. PM-10	5. PM-2.5	6. TSP	7. Fugitive Dust	8. Fugitive PM	9. HAP PM
UNIT 1	SUGAR MILL	337.9	337.9	337.9				
UNIT 1A	POWDER SUGAR TRANSPORT	28.5	28.5	28.5				
UNIT 2	SUGAR MILL	262.8	262.8	262.8				
UNIT 2A	POWDER SUGAR TRANSPORT	28.5	28.5	28.5				
UNIT 5	BAGGING NUISANCE COLLECTION	158.6	158.6	158.6				
UNIT 6	SUGAR TRANSPORT	75.1	75.1	75.1				
UNIT 7	SILO FILL	52.6	52.6	52.6				
UNIT 8	RECLAIM FROM POWDER BAGGERS	469.3	469.3	469.3				
UNIT 9	SUGAR MELT TANKS	30.3	30.3	30.3				
UNIT 10	COLOR SUGAR PANNING	12.3	12.3	12.3				
UNIT 11	DRY BULK TRUCK LOADING	75.1	75.1	75.1				
UNIT12	BOXING NUISANCE COLLECTION	158.6	158.6	158.6				
B 1	BOILER	.027	.113	.113				.027
B2	BOILER	.027	.113	.113				.027
H1	HEAT EXCHANGER	.027	.113	.113				.027

Part B: Control of Particulate Emissions

Part C gathers information about how each source of particulate emissions is controlled. If you do not provide enough information to adequately describe how each source of particulate emissions is controlled, the application process may be stopped. If additional space is needed, you may make a copy of this table.

10. Emissions Point ID	11. Control Measure	12. Control Measure Description	13. Control Plan
UNIT 9	<input type="checkbox"/> No Control <input checked="" type="checkbox"/> Dust Suppression <input type="checkbox"/> Other: _____	FABRIC FILTER DUST COLLECTOR	<input type="checkbox"/> Yes <input type="checkbox"/> No Date Submitted: _____
UNIT 10	<input type="checkbox"/> No Control <input checked="" type="checkbox"/> Dust Suppression <input type="checkbox"/> Other: _____	FABRIC FILTER DUST COLLECTOR	<input type="checkbox"/> Yes <input type="checkbox"/> No Date Submitted: _____
UNIT 11	<input type="checkbox"/> No Control <input checked="" type="checkbox"/> Dust Suppression <input type="checkbox"/> Other: _____	FABRIC FILTER DUST COLLECTOR	<input type="checkbox"/> Yes <input type="checkbox"/> No Date Submitted: _____
UNIT 12	<input type="checkbox"/> No Control <input checked="" type="checkbox"/> Dust Suppression <input type="checkbox"/> Other: _____	FABRIC FILTER DUST COLLECTOR	<input type="checkbox"/> Yes <input type="checkbox"/> No Date Submitted: _____
	<input type="checkbox"/> No Control <input type="checkbox"/> Dust Suppression <input type="checkbox"/> Other: _____		<input type="checkbox"/> Yes <input type="checkbox"/> No Date Submitted: _____
	<input type="checkbox"/> No Control <input type="checkbox"/> Dust Suppression <input type="checkbox"/> Other: _____		<input type="checkbox"/> Yes <input type="checkbox"/> No Date Submitted: _____
	<input type="checkbox"/> No Control <input type="checkbox"/> Dust Suppression <input type="checkbox"/> Other: _____		<input type="checkbox"/> Yes <input type="checkbox"/> No Date Submitted: _____
	<input type="checkbox"/> No Control <input type="checkbox"/> Dust Suppression <input type="checkbox"/> Other: _____		<input type="checkbox"/> Yes <input type="checkbox"/> No Date Submitted: _____



OAQ GENERAL SOURCE DATA APPLICATION
GSD-07: Criteria Pollutant Emissions Summary
 State Form 51602 (R3 / 1-10)
 INDIANA DEPARTMENT OF ENVIRONMENTAL MANAGEMENT

IDEM – Office of Air Quality – Permits Branch
 100 N. Senate Avenue, MC 61-53 Room 1003
 Indianapolis, IN 46204-2251
 Telephone: (317) 233-0178 or
 Toll Free: 1-800-451-6027 x30178 (within Indiana)
 Facsimile Number: (317) 232-6749
www.IN.gov/idem

NOTES:

- The purpose of this form is to provide the actual and potential emissions of each criteria pollutant emitted from the source. This form is required for all air permit applications.
- Detailed instructions for this form are available on the Air Permit Application Forms website.
- All information submitted to IDEM will be made available to the public unless it is submitted under a claim of confidentiality. Claims of confidentiality must be made at the time the information is submitted to IDEM, and must follow the requirements set out in 326 IAC 17.1-4-1. Failure to follow these requirements exactly will result in your information becoming a public record, available for public inspection.

Part A: Unit Emissions Summary

Part A provides the actual and potential emissions of each criteria pollutant emitted from each emissions unit. If you do not provide enough information to adequately describe the emissions from each emissions unit, the application process may be stopped.

1. Unit ID	2. Stack / Vent ID	3. Criteria Pollutant	4. Actual Emissions		5. Potential To Emit	
			Standard Units	Tons Per Year	Standard Units	Tons Per Year
B1	B1	CO2	lb/MMCF	.01	lb/MMCF	.01
B1	B1	NOx	lb/MMCF	1.48	lb/MMCF	1.48
B1	B1	VOC	lb/MMCF	.08	lb/MMCF	.08
B1	B1	CO2e	lb/MMCF	1,790	lb/MMCF	1,790
B1	B1	HAP	lb/MMCF	.027	lb/MMCF	.027
B2	B2	CO2	lb/MMCF	.01	lb/MMCF	.01
B2	B2	NOx	lb/MMCF	1.48	lb/MMCF	1.48
B2	B2	VOC	lb/MMCF	.08	lb/MMCF	.08
B2	B2	CO2e	lb/MMCF	1,790	lb/MMCF	1,790
B2	B2	HAP	lb/MMCF	.027	lb/MMCF	.027
H1	H1	CO2	lb/MMCF	.01	lb/MMCF	.01
H1	H1	NOx	lb/MMCF	1.48	lb/MMCF	1.48
H1	H1	VOC	lb/MMCF	.08	lb/MMCF	.08
H1	H1	CO2e	lb/MMCF	1,790	lb/MMCF	1,790
H1	H1	HAP	lb/MMCF	.027	lb/MMCF	.027

Part B: Pollutant Emissions Summary

Part B provides the total actual and potential emissions of each criteria pollutant emitted from the source (including all emissions units and fugitive emissions at the source). If you do not provide enough information to adequately describe the total source emissions, the application process may be stopped.

6. Criteria Pollutant	7. Actual Emissions		8. Potential To Emit	
	Standard Units	Tons Per Year	Standard Units	Tons Per Year
Carbon Monoxide (CO)	lb/MMCF	11.22	lb/MMCF	11.22
Lead (Pb)	lb/MMCF	5.00E-04	lb/MMCF	5.00E-04
Nitrogen Oxides (NO _x)	lb/MMCF	13.35	lb/MMCF	13.35
Particulate Matter (PM)	lb/MMCF	.24	lb/MMCF	.24
Particulate Matter less than 10µm (PM ₁₀)	lb/MMCF	1.02	lb/MMCF	1.02
Particulate Matter less than 2.5µm (PM _{2.5})	lb/MMCF	1.02	lb/MMCF	1.02
Sulfur Dioxide (SO ₂)	lb/MMCF	.09	lb/MMCF	.09
Volatile Organic Compounds (VOC)	lb/MMCF	.72	lb/MMCF	.72
Other (specify):				

Part C: Fugitive VOC Emissions (if applicable)

Part C summarizes the sources of fugitive VOC emissions at the source and estimates VOC emissions from these emission points. Complete this table if you are required to provide fugitive emissions data pursuant to 326 IAC 2-2 or 326 IAC 2-3.

9. Fugitive Emissions Source	10. Emission Factor (lb/hr)	11. Number Leaking	12. Uncontrolled Potential To Emit	
			Pounds Per Hour	Tons Per Year
Compressor Seals				
Flanges				
Open-Ended Lines				
Pressure Relief Seals				
Pump Seals				
Sampling Connections				
Valves				
Other (specify):				

From: [Palyshniuk, Kateryna](#)
To: [Rex Anderson](#)
Subject: RE: IDEM OAQ Contact Information for Application No. 089-47394-00490 for Indiana Sugars, Inc.
Date: Tuesday, February 13, 2024 10:30:00 AM
Attachments: [image002.png](#)
[image003.png](#)
[image004.png](#)
[image005.png](#)
[image006.png](#)
[image007.png](#)
[image008.png](#)

Hello Rex,

While working on your application, I noticed that in the additional information that you've sent me, there are three emission units (Unit 10, 11, 12) that I couldn't find in your previous calcs and permit. Are these new emission units? Do you want me to add them to the permit?

There is Unit 13, which I do not see in your forms with the emissions data, but it is included in the current permit and calcs. Do you want me to remove it from the permit?

Also, please specify information if you have any emergency generator on-site?

Best regards,
Kate

From: Rex Anderson <rexa@buysugars.com>
Sent: Wednesday, January 10, 2024 2:05 PM
To: Palyshniuk, Kateryna <KPalyshn@idem.IN.gov>
Subject: RE: IDEM OAQ Contact Information for Application No. 089-47394-00490 for Indiana Sugars, Inc.

****** This is an EXTERNAL email. Exercise caution. DO NOT open attachments or click links from unknown senders or unexpected email. ******

Good afternoon Kate,

Please find attached copies of the air permit application with the correct company name of Indiana Sugars Inc.

Also please find the forms with the emissions data.

Rex Anderson
Indiana Sugars
Maintenance Manager
219-886-9151 ex:233
Cell: 219-290-6884
rexa@buysugars.com



From: Palyshniuk, Kateryna <KPalyshn@idem.IN.gov>
Sent: Tuesday, January 9, 2024 10:20 AM
To: Rex Anderson <rexa@buysugars.com>
Subject: IDEM OAQ Contact Information for Application No. 089-47394-00490 for Indiana Sugars, Inc.

CAUTION: This email originated from outside of Indiana Sugars. Do not click links or open attachments unless you recognize the sender. If you suspect this is spam, forward this email to spam@buysugars.com.

Dear Rex Anderson,

I am the permit writer assigned to the current application No. 089-47394-00490 for Indiana Sugars, Inc. I would like to extend to you my contact information so that we may have continued communication until your new permit is issued. Please keep this information at hand. It is common for questions to arise, and oftentimes, further clarification is needed during the permit review process.

To expedite the review process, please e-mail me the **electronic copy of your calculations (preferably in excel format)** and other supporting documents used as part of your application.

Based on my preliminary review of the application, please indicate whether the company name is **Indiana Sugars** or **Indiana Sugars, Inc.**

IDEM, OAQ will notify you when a draft permit has been submitted for public notice and/or when a final permit has been issued. As part of the notification, IDEM, OAQ will provide information on how to access the draft and/or final permit electronically on IDEM's website. If Indiana Sugars, Inc. would prefer to receive paper copies of the entire draft and/or final permit, please let me know prior to the end of the applicant review period. If you prefer to receive paper copies of the entire permit, IDEM, OAQ will mail a paper copy of the draft permit and/or original signed final permit to the source contact. If you do not request to receive paper copies of the entire permit, IDEM, OAQ will only mail a paper copy of the original signed final permit signature page to the source contact.

Based on my preliminary review of the application, the permit approval that is required for this application will be subject to the public notice requirements of 326 IAC 2-1.1-6. As the permit applicant, you are required to place a copy of the permit application packet for public review at a public library in the county where the source is located (preferably at the local public library nearest to the source in the county where the source is located) within ten (10) days of the submission of the application. In the GSD-01 Form, Part H, **the date that the application packet was filed with the local library** was not provided. Please provide **the date that the application packet was filed with the local library** and confirm whether (or not) a copy of the application packet was placed at the local library.

Please feel free to contact me at any time if you have questions, concerns, or important information regarding your permit. For your convenience, my section chief Balogun, Josiah K may be contacted at 317-234-1203 or jbalogun@idem.IN.gov.

Thank you in advance for your time and assistance. I look forward to working with you.

Sincerely,

Kate

From: [Palyshniuk, Kateryna](#)
To: [Rex Anderson](#)
Subject: RE: IDEM OAQ Contact Information for Application No. 089-47394-00490 for Indiana Sugars, Inc.
Date: Thursday, February 15, 2024 1:21:00 PM
Attachments: [image002.png](#)
[image003.png](#)
[image004.png](#)
[image005.png](#)
[image006.png](#)
[image007.png](#)
[image008.png](#)

Good afternoon Rex,

Thank you for sending additional information. Regarding the emergence generator, provide the following information, please:

1. Is your office located on-site?
2. Is it a stationary generator?
3. What year was Generac 110 HP Natural Gas generator manufactured and constructed?
4. What is the maximum capacity?
5. Does it exhaust outdoor or indoor?
6. Any control equipment related to the Generac 110 HP Natural Gas generator?

Thank you,
Kate



Indiana Department of
Environmental Management

Kateryna (Kate) Palyshniuk, Ph.D.
Environmental Manager

• (317) 234-0155 • KPalysn@idem.IN.gov

Protecting Hoosiers and Our Environment



www.idem.IN.gov

Help us improve!

IDEM values your feedback



From: Rex Anderson <rexa@buysugars.com>

Sent: Wednesday, February 14, 2024 12:44 PM

To: Palyshniuk, Kateryna <KPalysn@idem.IN.gov>

Subject: RE: IDEM OAQ Contact Information for Application No. 089-47394-00490 for Indiana Sugars, Inc.

**** This is an EXTERNAL email. Exercise caution. DO NOT open attachments or click links from unknown senders or unexpected email. ****

Good afternoon Kateryna,

Please find attached the form for Unit #13.

We do have a Generac 110 HP Natural Gas generator for our office.

I am not sure which forms I need to fill out for this.

Thanks,

Rex Anderson
Indiana Sugars
Maintenance Manager
219-886-9151 ex:233
Cell: 219-290-6884
rexa@buysugars.com



From: Palyshniuk, Kateryna <KPalyshn@idem.IN.gov>

Sent: Tuesday, February 13, 2024 10:37 AM

To: Rex Anderson <rexa@buysugars.com>

Subject: RE: IDEM OAQ Contact Information for Application No. 089-47394-00490 for Indiana Sugars, Inc.

CAUTION: This email originated from outside of Indiana Sugars. Do not click links or open attachments unless you recognize the sender. If you suspect this is spam, forward this email to spam@buysugars.com.

Dear Rex,

My apologies for the units 10, 11, 12. I found them in the permit.

There is Unit 13, which I do not see in your forms with the emissions data, but it is included in the current permit and calcs. Do you want me to remove it from the permit?

Also, please specify information if you have any emergency generator on-site?

Thank you,
Kate

From: Palyshniuk, Kateryna

Sent: Tuesday, February 13, 2024 10:30 AM

To: Rex Anderson <rexa@buysugars.com>

Subject: RE: IDEM OAQ Contact Information for Application No. 089-47394-00490 for Indiana

Sugars, Inc.

Hello Rex,

While working on your application, I noticed that in the additional information that you've sent me, there are three emission units (Unit 10, 11, 12) that I couldn't find in your previous calcs and permit. Are these new emission units? Do you want me to add them to the permit?

There is Unit 13, which I do not see in your forms with the emissions data, but it is included in the current permit and calcs. Do you want me to remove it from the permit?

Also, please specify information if you have any emergency generator on-site?

Best regards,
Kate

From: Rex Anderson <rexa@buysugars.com>
Sent: Wednesday, January 10, 2024 2:05 PM
To: Palyshniuk, Kateryna <KPalyshn@idem.IN.gov>
Subject: RE: IDEM OAQ Contact Information for Application No. 089-47394-00490 for Indiana Sugars, Inc.

****** This is an EXTERNAL email. Exercise caution. DO NOT open attachments or click links from unknown senders or unexpected email. ******

Good afternoon Kate,

Please find attached copies of the air permit application with the correct company name of Indiana Sugars Inc.

Also please find the forms with the emissions data.

Rex Anderson
Indiana Sugars
Maintenance Manager
219-886-9151 ex:233
Cell: 219-290-6884
rexa@buysugars.com



From: Palyshniuk, Kateryna <KPalyshn@idem.IN.gov>
Sent: Tuesday, January 9, 2024 10:20 AM
To: Rex Anderson <rexa@buysugars.com>
Subject: IDEM OAQ Contact Information for Application No. 089-47394-00490 for Indiana Sugars,

Inc.

CAUTION: This email originated from outside of Indiana Sugars. Do not click links or open attachments unless you recognize the sender. If you suspect this is spam, forward this email to spam@buysugars.com.

Dear Rex Anderson,

I am the permit writer assigned to the current application No. 089-47394-00490 for Indiana Sugars, Inc. I would like to extend to you my contact information so that we may have continued communication until your new permit is issued. Please keep this information at hand. It is common for questions to arise, and oftentimes, further clarification is needed during the permit review process.

To expedite the review process, please e-mail me the **electronic copy of your calculations (preferably in excel format)** and other supporting documents used as part of your application.

Based on my preliminary review of the application, please indicate whether the company name is **Indiana Sugars** or **Indiana Sugars, Inc.**

IDEM, OAQ will notify you when a draft permit has been submitted for public notice and/or when a final permit has been issued. As part of the notification, IDEM, OAQ will provide information on how to access the draft and/or final permit electronically on IDEM's website. If Indiana Sugars, Inc. would prefer to receive paper copies of the entire draft and/or final permit, please let me know prior to the end of the applicant review period. If you prefer to receive paper copies of the entire permit, IDEM, OAQ will mail a paper copy of the draft permit and/or original signed final permit to the source contact. If you do not request to receive paper copies of the entire permit, IDEM, OAQ will only mail a paper copy of the original signed final permit signature page to the source contact.

Based on my preliminary review of the application, the permit approval that is required for this application will be subject to the public notice requirements of 326 IAC 2-1.1-6. As the permit applicant, you are required to place a copy of the permit application packet for public review at a public library in the county where the source is located (preferably at the local public library nearest to the source in the county where the source is located) within ten (10) days of the submission of the application. In the GSD-01 Form, Part H, **the date that the application packet was filed with the local library** was not provided. Please provide **the date that the application packet was filed with the local library** and confirm whether (or not) a copy of the application packet was placed at the local library.

Please feel free to contact me at any time if you have questions, concerns, or important information regarding your permit. For your convenience, my section chief Balogun, Josiah K may be contacted at 317-234-1203 or jbalogun@idem.IN.gov.

Thank you in advance for your time and assistance. I look forward to working with you.

Sincerely,

Kate



Indiana Department of
Environmental Management

Kateryna (Kate) Palyshniuk, Ph.D.
Environmental Manager

• (317) 234-0155 • KPalyshn@idem.IN.gov

Protecting Hoosiers and Our Environment

From: [Rex Anderson](#)
To: [Palyshniuk, Kateryna](#)
Subject: RE: IDEM OAQ Contact Information for Application No. 089-47394-00490 for Indiana Sugars, Inc.
Date: Friday, February 16, 2024 1:13:51 PM
Attachments: [image002.png](#)
[image003.png](#)
[image004.png](#)
[image005.png](#)
[image006.png](#)
[image007.png](#)
[image008.png](#)

****** This is an EXTERNAL email. Exercise caution. DO NOT open attachments or click links from unknown senders or unexpected email. ******

Good afternoon Kateryna,

1. Yes, it is on site
2. Yes, it is stationary
3. The generator was manufactured and installed in 2014
4. Maximum capacity is 70 kW
5. It exhausts outdoors
6. It has a Two line tri-lingual digital nexus controller and an automatic transfer switch

Rex Anderson
Indiana Sugars
Maintenance Manager
219-886-9151 ex:233
Cell: 219-290-6884
rexa@buysugars.com



From: Palyshniuk, Kateryna <KPalyshn@idem.IN.gov>
Sent: Thursday, February 15, 2024 12:21 PM
To: Rex Anderson <rexa@buysugars.com>
Subject: RE: IDEM OAQ Contact Information for Application No. 089-47394-00490 for Indiana Sugars, Inc.

CAUTION: This email originated from outside of Indiana Sugars. Do not click links or open attachments unless you recognize the sender. If you suspect this is spam, forward this email to spam@buysugars.com.

Good afternoon Rex,

Thank you for sending additional information. Regarding the emergence generator, provide the following information, please:

1. Is your office located on-site?

2. Is it a stationary generator?
3. What year was Generac 110 HP Natural Gas generator manufactured and constructed?
4. What is the maximum capacity?
5. Does it exhaust outdoor or indoor?
6. Any control equipment related to the Generac 110 HP Natural Gas generator?

Thank you,
Kate



Indiana Department of
Environmental Management

Kateryna (Kate) Palyshniuk, Ph.D.
Environmental Manager

• (317) 234-0155 • KPalysn@idem.IN.gov

Protecting Hoosiers and Our Environment

 |  |  |  |  | www.idem.IN.gov

Help us improve!

IDEM values your feedback



From: Rex Anderson <rexa@buysugars.com>

Sent: Wednesday, February 14, 2024 12:44 PM

To: Palyshniuk, Kateryna <KPalysn@idem.IN.gov>

Subject: RE: IDEM OAQ Contact Information for Application No. 089-47394-00490 for Indiana Sugars, Inc.

****** This is an EXTERNAL email. Exercise caution. DO NOT open attachments or click links from unknown senders or unexpected email. ******

Good afternoon Kateryna,

Please find attached the form for Unit #13.

We do have a Generac 110 HP Natural Gas generator for our office.

I am not sure which forms I need to fill out for this.

Thanks,

Rex Anderson
Indiana Sugars
Maintenance Manager

219-886-9151 ex:233

Cell: 219-290-6884

rexa@buysugars.com



From: Palyshniuk, Kateryna <KPalyshn@idem.IN.gov>

Sent: Tuesday, February 13, 2024 10:37 AM

To: Rex Anderson <rexa@buysugars.com>

Subject: RE: IDEM OAQ Contact Information for Application No. 089-47394-00490 for Indiana Sugars, Inc.

CAUTION: This email originated from outside of Indiana Sugars. Do not click links or open attachments unless you recognize the sender. If you suspect this is spam, forward this email to spam@buysugars.com.

Dear Rex,

My apologies for the units 10, 11, 12. I found them in the permit.

There is Unit 13, which I do not see in your forms with the emissions data, but it is included in the current permit and calcs. Do you want me to remove it from the permit?

Also, please specify information if you have any emergency generator on-site?

Thank you,
Kate

From: Palyshniuk, Kateryna

Sent: Tuesday, February 13, 2024 10:30 AM

To: Rex Anderson <rexa@buysugars.com>

Subject: RE: IDEM OAQ Contact Information for Application No. 089-47394-00490 for Indiana Sugars, Inc.

Hello Rex,

While working on your application, I noticed that in the additional information that you've sent me, there are three emission units (Unit 10, 11, 12) that I couldn't find in your previous calcs and permit. Are these new emission units? Do you want me to add them to the permit?

There is Unit 13, which I do not see in your forms with the emissions data, but it is included in the current permit and calcs. Do you want me to remove it from the permit?

Also, please specify information if you have any emergency generator on-site?

Best regards,

Kate

From: Rex Anderson <rexa@buysugars.com>
Sent: Wednesday, January 10, 2024 2:05 PM
To: Palyshniuk, Kateryna <KPalysn@idem.IN.gov>
Subject: RE: IDEM OAQ Contact Information for Application No. 089-47394-00490 for Indiana Sugars, Inc.

****** This is an EXTERNAL email. Exercise caution. DO NOT open attachments or click links from unknown senders or unexpected email. ******

Good afternoon Kate,

Please find attached copies of the air permit application with the correct company name of Indiana Sugars Inc.

Also please find the forms with the emissions data.

Rex Anderson
Indiana Sugars
Maintenance Manager
219-886-9151 ex:233
Cell: 219-290-6884
rexa@buysugars.com



From: Palyshniuk, Kateryna <KPalysn@idem.IN.gov>
Sent: Tuesday, January 9, 2024 10:20 AM
To: Rex Anderson <rexa@buysugars.com>
Subject: IDEM OAQ Contact Information for Application No. 089-47394-00490 for Indiana Sugars, Inc.

CAUTION: This email originated from outside of Indiana Sugars. Do not click links or open attachments unless you recognize the sender. If you suspect this is spam, forward this email to spam@buysugars.com.

Dear Rex Anderson,

I am the permit writer assigned to the current application No. 089-47394-00490 for Indiana Sugars, Inc. I would like to extend to you my contact information so that we may have continued communication until your new permit is issued. Please keep this information at hand. It is common for questions to arise, and oftentimes, further clarification is needed during the permit review process.

To expedite the review process, please e-mail me the **electronic copy of your calculations (preferably in excel format)** and other supporting documents used as part of your application.

Based on my preliminary review of the application, please indicate whether the company name is **Indiana**

Sugars or Indiana Sugars, Inc.

IDEM, OAQ will notify you when a draft permit has been submitted for public notice and/or when a final permit has been issued. As part of the notification, IDEM, OAQ will provide information on how to access the draft and/or final permit electronically on IDEM's website. If Indiana Sugars, Inc. would prefer to receive paper copies of the entire draft and/or final permit, please let me know prior to the end of the applicant review period. If you prefer to receive paper copies of the entire permit, IDEM, OAQ will mail a paper copy of the draft permit and/or original signed final permit to the source contact. If you do not request to receive paper copies of the entire permit, IDEM, OAQ will only mail a paper copy of the original signed final permit signature page to the source contact.

Based on my preliminary review of the application, the permit approval that is required for this application will be subject to the public notice requirements of 326 IAC 2-1.1-6. As the permit applicant, you are required to place a copy of the permit application packet for public review at a public library in the county where the source is located (preferably at the local public library nearest to the source in the county where the source is located) within ten (10) days of the submission of the application. In the GSD-01 Form, Part H, **the date that the application packet was filed with the local library** was not provided. Please provide **the date that the application packet was filed with the local library** and confirm whether (or not) a copy of the application packet was placed at the local library.

Please feel free to contact me at any time if you have questions, concerns, or important information regarding your permit. For your convenience, my section chief Balogun, Josiah K may be contacted at 317-234-1203 or jbalogun@idem.IN.gov.

Thank you in advance for your time and assistance. I look forward to working with you.

Sincerely,

Kate



Indiana Department of
Environmental Management

Kateryna (Kate) Palyshniuk, Ph.D.
Environmental Manager

• (317) 234-0155 • KPalyshn@idem.IN.gov

Protecting Hoosiers and Our Environment

 | www.idem.IN.gov

Help us improve!

IDEM values your feedback



From: [Palyshniuk, Kateryna](#)
To: [Rex Anderson](#)
Subject: RE: IDEM OAQ Contact Information for Application No. 089-47394-00490 for Indiana Sugars, Inc.
Date: Monday, February 19, 2024 3:12:00 PM
Attachments: [image002.png](#)
[image003.png](#)
[image004.png](#)
[image005.png](#)
[image006.png](#)
[image007.png](#)
[image008.png](#)
[FED-01.doc](#)

Good afternoon Rex,

Thank you for your quick reply.

Please find attached FED-01 form to this letter. Please provide information on the NSPS and/or NESHAP standards that apply to the Generac 110 HP Natural Gas generator, if any.

Let me know if you have any questions.

Best Regards,
Kate



Indiana Department of
Environmental Management

Kateryna (Kate) Palyshniuk, Ph.D.
Environmental Manager

• (317) 234-0155 • KPalysn@idem.IN.gov

Protecting Hoosiers and Our Environment

 |  |  |  |  | www.idem.IN.gov

Help us improve!

IDEM values your feedback



From: Rex Anderson <rexa@buysugars.com>

Sent: Friday, February 16, 2024 1:13 PM

To: Palyshniuk, Kateryna <KPalysn@idem.IN.gov>

Subject: RE: IDEM OAQ Contact Information for Application No. 089-47394-00490 for Indiana Sugars, Inc.

**** This is an EXTERNAL email. Exercise caution. DO NOT open attachments or click links from unknown senders or unexpected email. ****

Good afternoon Kateryna,

1. Yes, it is on site
2. Yes, it is stationary
3. The generator was manufactured and installed in 2014
4. Maximum capacity is 70 kW
5. It exhausts outdoors
6. It has a Two line tri-lingual digital nexus controller and an automatic transfer switch

Rex Anderson
Indiana Sugars
Maintenance Manager
219-886-9151 ex:233
Cell: 219-290-6884
rexa@buysugars.com



From: Palyshniuk, Kateryna <KPalyshn@idem.IN.gov>
Sent: Thursday, February 15, 2024 12:21 PM
To: Rex Anderson <rexa@buysugars.com>
Subject: RE: IDEM OAQ Contact Information for Application No. 089-47394-00490 for Indiana Sugars, Inc.

CAUTION: This email originated from outside of Indiana Sugars. Do not click links or open attachments unless you recognize the sender. If you suspect this is spam, forward this email to spam@buysugars.com.

Good afternoon Rex,

Thank you for sending additional information. Regarding the emergence generator, provide the following information, please:

1. Is your office located on-site?
2. Is it a stationary generator?
3. What year was Generac 110 HP Natural Gas generator manufactured and constructed?
4. What is the maximum capacity?
5. Does it exhaust outdoor or indoor?
6. Any control equipment related to the Generac 110 HP Natural Gas generator?

Thank you,
Kate

Indiana Department of
Environmental Management
Kateryna (Kate) Palyshniuk, Ph.D.
Environmental Manager
• (317) 234-0155 • KPalyshn@idem.IN.gov

Protecting Hoosiers and Our Environment



www.idem.IN.gov

Help us improve!

IDEM values your feedback



From: Rex Anderson <rexa@buysugars.com>

Sent: Wednesday, February 14, 2024 12:44 PM

To: Palyshniuk, Kateryna <KPalyshn@idem.IN.gov>

Subject: RE: IDEM OAQ Contact Information for Application No. 089-47394-00490 for Indiana Sugars, Inc.

****** This is an EXTERNAL email. Exercise caution. DO NOT open attachments or click links from unknown senders or unexpected email. ******

Good afternoon Kateryna,

Please find attached the form for Unit #13.

We do have a Generac 110 HP Natural Gas generator for our office.

I am not sure which forms I need to fill out for this.

Thanks,

Rex Anderson
Indiana Sugars
Maintenance Manager
219-886-9151 ex:233
Cell: 219-290-6884
rexa@buysugars.com



From: Palyshniuk, Kateryna <KPalyshn@idem.IN.gov>

Sent: Tuesday, February 13, 2024 10:37 AM

To: Rex Anderson <rexa@buysugars.com>

Subject: RE: IDEM OAQ Contact Information for Application No. 089-47394-00490 for Indiana Sugars, Inc.

CAUTION: This email originated from outside of Indiana Sugars. Do not click links or open attachments unless you recognize the sender. If you suspect this is spam, forward this email to spam@buysugars.com.

Dear Rex,

My apologies for the units 10, 11, 12. I found them in the permit.

There is Unit 13, which I do not see in your forms with the emissions data, but it is included in the current permit and calcs. Do you want me to remove it from the permit?

Also, please specify information if you have any emergency generator on-site?

Thank you,

Kate

From: Palyshniuk, Kateryna

Sent: Tuesday, February 13, 2024 10:30 AM

To: Rex Anderson <rexa@buysugars.com>

Subject: RE: IDEM OAQ Contact Information for Application No. 089-47394-00490 for Indiana Sugars, Inc.

Hello Rex,

While working on your application, I noticed that in the additional information that you've sent me, there are three emission units (Unit 10, 11, 12) that I couldn't find in your previous calcs and permit. Are these new emission units? Do you want me to add them to the permit?

There is Unit 13, which I do not see in your forms with the emissions data, but it is included in the current permit and calcs. Do you want me to remove it from the permit?

Also, please specify information if you have any emergency generator on-site?

Best regards,

Kate

From: Rex Anderson <rexa@buysugars.com>

Sent: Wednesday, January 10, 2024 2:05 PM

To: Palyshniuk, Kateryna <KPalysnhn@idem.IN.gov>

Subject: RE: IDEM OAQ Contact Information for Application No. 089-47394-00490 for Indiana

Sugars, Inc.

**** This is an EXTERNAL email. Exercise caution. DO NOT open attachments or click links from unknown senders or unexpected email. ****

Good afternoon Kate,

Please find attached copies of the air permit application with the correct company name of Indiana Sugars Inc.

Also please find the forms with the emissions data.

Rex Anderson
Indiana Sugars
Maintenance Manager
219-886-9151 ex:233
Cell: 219-290-6884
rexa@buysugars.com



From: Palyshniuk, Kateryna <KPalyshn@idem.IN.gov>

Sent: Tuesday, January 9, 2024 10:20 AM

To: Rex Anderson <rexa@buysugars.com>

Subject: IDEM OAQ Contact Information for Application No. 089-47394-00490 for Indiana Sugars, Inc.

CAUTION: This email originated from outside of Indiana Sugars. Do not click links or open attachments unless you recognize the sender. If you suspect this is spam, forward this email to spam@buysugars.com.

Dear Rex Anderson,

I am the permit writer assigned to the current application No. 089-47394-00490 for Indiana Sugars, Inc. I would like to extend to you my contact information so that we may have continued communication until your new permit is issued. Please keep this information at hand. It is common for questions to arise, and oftentimes, further clarification is needed during the permit review process.

To expedite the review process, please e-mail me the **electronic copy of your calculations (preferably in excel format)** and other supporting documents used as part of your application.

Based on my preliminary review of the application, please indicate whether the company name is **Indiana Sugars** or **Indiana Sugars, Inc.**

IDEM, OAQ will notify you when a draft permit has been submitted for public notice and/or when a final permit has been issued. As part of the notification, IDEM, OAQ will provide information on how to access the draft and/or final permit electronically on IDEM's website. If Indiana Sugars, Inc. would prefer to receive paper copies of the entire draft and/or final permit, please let me know prior to the end of the applicant review period. If you prefer to receive paper copies of the entire permit, IDEM, OAQ will mail a paper copy of the draft permit and/or original signed final permit to the source contact. If you do not request to receive paper copies of the entire permit, IDEM, OAQ will only mail a paper copy of the original

signed final permit signature page to the source contact.

Based on my preliminary review of the application, the permit approval that is required for this application will be subject to the public notice requirements of 326 IAC 2-1.1-6. As the permit applicant, you are required to place a copy of the permit application packet for public review at a public library in the county where the source is located (preferably at the local public library nearest to the source in the county where the source is located) within ten (10) days of the submission of the application. In the GSD-01 Form, Part H, **the date that the application packet was filed with the local library** was not provided. Please provide **the date that the application packet was filed with the local library** and confirm whether (or not) a copy of the application packet was placed at the local library.

Please feel free to contact me at any time if you have questions, concerns, or important information regarding your permit. For your convenience, my section chief Balogun, Josiah K may be contacted at 317-234-1203 or jbalogun@idem.IN.gov.

Thank you in advance for your time and assistance. I look forward to working with you.

Sincerely,

Kate



Indiana Department of
Environmental Management

Kateryna (Kate) Palyshniuk, Ph.D.
Environmental Manager

• (317) 234-0155 • KPalyshn@idem.IN.gov

Protecting Hoosiers and Our Environment



www.idem.IN.gov

Help us improve!

IDEM values your feedback



Part C: Performance Testing Requirements

Part C identifies the performance testing requirements that are applicable to the process or emission unit.

6. Performance Testing:

7. Date of Initial Performance Test:

8. Test Methods:

9. Was the initial performance test approved by IDEM? Yes: *Date approved:* _____ No

10. Did the initial performance test show compliance with the rule? Yes No: *Date of next performance test:* _____

Part D: Important Dates

Part D identifies specific dates associated with the federal standard that are applicable to the process or emission unit.

11. Date Initial Notification was Submitted:

12. Initial Compliance Date: Startup: _____ Other: _____

13. Other Dates

Description: _____	Date: _____
Description: _____	Date: _____
Description: _____	Date: _____

Part E: Other Information

Part E identifies any additional information pertaining to the applicable federal rule. Attach additional information using form GSD-09 as necessary.

Empty box for additional information.

From: [Palyshniuk, Kateryna](#)
To: [Rex Anderson](#)
Subject: RE: IDEM OAQ Contact Information for Application No. 089-47394-00490 for Indiana Sugars, Inc.
Date: Monday, February 19, 2024 3:12:00 PM
Attachments: [image002.png](#)
[image003.png](#)
[image004.png](#)
[image005.png](#)
[image006.png](#)
[image007.png](#)
[image008.png](#)
[FED-01.doc](#)

Good afternoon Rex,

Thank you for your quick reply.

Please find attached FED-01 form to this letter. Please provide information on the NSPS and/or NESHAP standards that apply to the Generac 110 HP Natural Gas generator, if any.

Let me know if you have any questions.

Best Regards,
Kate



Indiana Department of
Environmental Management

Kateryna (Kate) Palyshniuk, Ph.D.
Environmental Manager

• (317) 234-0155 • KPalysn@idem.IN.gov

Protecting Hoosiers and Our Environment



www.idem.IN.gov

Help us improve!

IDEM values your feedback



From: Rex Anderson <rexa@buysugars.com>

Sent: Friday, February 16, 2024 1:13 PM

To: Palyshniuk, Kateryna <KPalysn@idem.IN.gov>

Subject: RE: IDEM OAQ Contact Information for Application No. 089-47394-00490 for Indiana Sugars, Inc.

**** This is an EXTERNAL email. Exercise caution. DO NOT open attachments or click links from unknown senders or unexpected email. ****

Good afternoon Kateryna,

1. Yes, it is on site
2. Yes, it is stationary
3. The generator was manufactured and installed in 2014
4. Maximum capacity is 70 kW
5. It exhausts outdoors
6. It has a Two line tri-lingual digital nexus controller and an automatic transfer switch

Rex Anderson
Indiana Sugars
Maintenance Manager
219-886-9151 ex:233
Cell: 219-290-6884
rexa@buysugars.com



From: Palyshniuk, Kateryna <KPalysahn@idem.IN.gov>
Sent: Thursday, February 15, 2024 12:21 PM
To: Rex Anderson <rexa@buysugars.com>
Subject: RE: IDEM OAQ Contact Information for Application No. 089-47394-00490 for Indiana Sugars, Inc.

CAUTION: This email originated from outside of Indiana Sugars. Do not click links or open attachments unless you recognize the sender. If you suspect this is spam, forward this email to spam@buysugars.com.

Good afternoon Rex,

Thank you for sending additional information. Regarding the emergence generator, provide the following information, please:

1. Is your office located on-site?
2. Is it a stationary generator?
3. What year was Generac 110 HP Natural Gas generator manufactured and constructed?
4. What is the maximum capacity?
5. Does it exhaust outdoor or indoor?
6. Any control equipment related to the Generac 110 HP Natural Gas generator?

Thank you,
Kate

Indiana Department of
Environmental Management
Kateryna (Kate) Palyshniuk, Ph.D.
Environmental Manager
• (317) 234-0155 • KPalysahn@idem.IN.gov

Protecting Hoosiers and Our Environment



www.idem.IN.gov

Help us improve!

IDEM values your feedback



From: Rex Anderson <rexa@buysugars.com>

Sent: Wednesday, February 14, 2024 12:44 PM

To: Palyshniuk, Kateryna <KPalyshn@idem.IN.gov>

Subject: RE: IDEM OAQ Contact Information for Application No. 089-47394-00490 for Indiana Sugars, Inc.

****** This is an EXTERNAL email. Exercise caution. DO NOT open attachments or click links from unknown senders or unexpected email. ******

Good afternoon Kateryna,

Please find attached the form for Unit #13.

We do have a Generac 110 HP Natural Gas generator for our office.

I am not sure which forms I need to fill out for this.

Thanks,

Rex Anderson
Indiana Sugars
Maintenance Manager
219-886-9151 ex:233
Cell: 219-290-6884
rexa@buysugars.com



From: Palyshniuk, Kateryna <KPalyshn@idem.IN.gov>

Sent: Tuesday, February 13, 2024 10:37 AM

To: Rex Anderson <rexa@buysugars.com>

Subject: RE: IDEM OAQ Contact Information for Application No. 089-47394-00490 for Indiana Sugars, Inc.

CAUTION: This email originated from outside of Indiana Sugars. Do not click links or open attachments unless you recognize the sender. If you suspect this is spam, forward this email to spam@buysugars.com.

Dear Rex,

My apologies for the units 10, 11, 12. I found them in the permit.

There is Unit 13, which I do not see in your forms with the emissions data, but it is included in the current permit and calcs. Do you want me to remove it from the permit?

Also, please specify information if you have any emergency generator on-site?

Thank you,

Kate

From: Palyshniuk, Kateryna

Sent: Tuesday, February 13, 2024 10:30 AM

To: Rex Anderson <rexa@buysugars.com>

Subject: RE: IDEM OAQ Contact Information for Application No. 089-47394-00490 for Indiana Sugars, Inc.

Hello Rex,

While working on your application, I noticed that in the additional information that you've sent me, there are three emission units (Unit 10, 11, 12) that I couldn't find in your previous calcs and permit. Are these new emission units? Do you want me to add them to the permit?

There is Unit 13, which I do not see in your forms with the emissions data, but it is included in the current permit and calcs. Do you want me to remove it from the permit?

Also, please specify information if you have any emergency generator on-site?

Best regards,

Kate

From: Rex Anderson <rexa@buysugars.com>

Sent: Wednesday, January 10, 2024 2:05 PM

To: Palyshniuk, Kateryna <KPalysn@idem.IN.gov>

Subject: RE: IDEM OAQ Contact Information for Application No. 089-47394-00490 for Indiana

Sugars, Inc.

**** This is an EXTERNAL email. Exercise caution. DO NOT open attachments or click links from unknown senders or unexpected email. ****

Good afternoon Kate,

Please find attached copies of the air permit application with the correct company name of Indiana Sugars Inc.

Also please find the forms with the emissions data.

Rex Anderson
Indiana Sugars
Maintenance Manager
219-886-9151 ex:233
Cell: 219-290-6884
rexa@buysugars.com



From: Palyshniuk, Kateryna <KPalyshn@idem.IN.gov>

Sent: Tuesday, January 9, 2024 10:20 AM

To: Rex Anderson <rexa@buysugars.com>

Subject: IDEM OAQ Contact Information for Application No. 089-47394-00490 for Indiana Sugars, Inc.

CAUTION: This email originated from outside of Indiana Sugars. Do not click links or open attachments unless you recognize the sender. If you suspect this is spam, forward this email to spam@buysugars.com.

Dear Rex Anderson,

I am the permit writer assigned to the current application No. 089-47394-00490 for Indiana Sugars, Inc. I would like to extend to you my contact information so that we may have continued communication until your new permit is issued. Please keep this information at hand. It is common for questions to arise, and oftentimes, further clarification is needed during the permit review process.

To expedite the review process, please e-mail me the **electronic copy of your calculations (preferably in excel format)** and other supporting documents used as part of your application.

Based on my preliminary review of the application, please indicate whether the company name is **Indiana Sugars** or **Indiana Sugars, Inc.**

IDEM, OAQ will notify you when a draft permit has been submitted for public notice and/or when a final permit has been issued. As part of the notification, IDEM, OAQ will provide information on how to access the draft and/or final permit electronically on IDEM's website. If Indiana Sugars, Inc. would prefer to receive paper copies of the entire draft and/or final permit, please let me know prior to the end of the applicant review period. If you prefer to receive paper copies of the entire permit, IDEM, OAQ will mail a paper copy of the draft permit and/or original signed final permit to the source contact. If you do not request to receive paper copies of the entire permit, IDEM, OAQ will only mail a paper copy of the original

signed final permit signature page to the source contact.

Based on my preliminary review of the application, the permit approval that is required for this application will be subject to the public notice requirements of 326 IAC 2-1.1-6. As the permit applicant, you are required to place a copy of the permit application packet for public review at a public library in the county where the source is located (preferably at the local public library nearest to the source in the county where the source is located) within ten (10) days of the submission of the application. In the GSD-01 Form, Part H, **the date that the application packet was filed with the local library** was not provided. Please provide **the date that the application packet was filed with the local library** and confirm whether (or not) a copy of the application packet was placed at the local library.

Please feel free to contact me at any time if you have questions, concerns, or important information regarding your permit. For your convenience, my section chief Balogun, Josiah K may be contacted at 317-234-1203 or jbalogun@idem.IN.gov.

Thank you in advance for your time and assistance. I look forward to working with you.

Sincerely,

Kate



Indiana Department of
Environmental Management

Kateryna (Kate) Palyshniuk, Ph.D.
Environmental Manager

• (317) 234-0155 • KPalyshn@idem.IN.gov

Protecting Hoosiers and Our Environment



www.idem.IN.gov

Help us improve!

IDEM values your feedback





**OAQ FEDERAL RULE INCORPORATION APPLICATION
FED-01: Summary of Federal Requirements – NSPS & NESHAP**

State Form 53512 (R / 1-10)

INDIANA DEPARTMENT OF ENVIRONMENTAL MANAGEMENT

IDEM – Office of Air Quality – Permits Branch
100 N. Senate Avenue, MC 61-53, Room 1003
Indianapolis, IN 46204-2251
Telephone: (317) 233-0178 or
Toll Free: 1-800-451-6027 x30178 (within Indiana)
Facsimile Number: (317) 232-6749
www.in.gov/idem

- NOTES:**
- The purpose of this form is to provide a standardized way for sources to identify the NSPS or NESHAP requirements that are applicable to the regulated source. Complete one (1) form for each federal rule that applies to the source. This is a required form.
 - Detailed instructions for this form are available on the Air Permit Application Forms website.
 - All information submitted to IDEM will be made available to the public unless it is submitted under a claim of confidentiality. Claims of confidentiality must be made at the time the information is submitted to IDEM, and must follow the requirements set out in 326 IAC 17.1-4-1. Failure to follow these requirements exactly will result in your information becoming a public record.

Part A: Identification of Applicable Standard

Part A identifies the applicable standard and affected source.

1. Type of Standard:	<input type="checkbox"/> Part 60 NSPS	<input type="checkbox"/> Part 61 NESHAP	<input type="checkbox"/> Part 63 NESHAP (MACT)
2. Subpart Letter:			
3. Source Category Name:			
4. Affected Source <i>(Include all applicable emission unit IDs):</i>			

Part B: Applicable Requirements

Part B specifies the specific requirements of the federal rule that are applicable to the process or emission unit.

5. Applicable Requirements: *Identify the section of the federal standard that is applicable at the lowest subsection level. For example, if all of 40 CFR 63.342(c) is applicable, "40 CFR 63.342(c)" is the appropriate citation. If only paragraph 2 of 40 CFR 63.342(c) is applicable, then the appropriate citation is 40 CFR 63.342(c)(2).*

•	•	•
•	•	•
•	•	•
•	•	•
•	•	•
•	•	•
•	•	•
•	•	•
•	•	•
•	•	•
•	•	•
•	•	•
•	•	•
•	•	•
•	•	•
•	•	•
•	•	•
•	•	•
•	•	•
•	•	•
•	•	•
•	•	•
•	•	•
•	•	•

Part C: Performance Testing Requirements

Part C identifies the performance testing requirements that are applicable to the process or emission unit.

6. Performance Testing:

7. Date of Initial Performance Test:

8. Test Methods:

9. Was the initial performance test approved by IDEM? Yes: *Date approved:* _____ No

10. Did the initial performance test show compliance with the rule? Yes No: *Date of next performance test:* _____

Part D: Important Dates

Part D identifies specific dates associated with the federal standard that are applicable to the process or emission unit.

11. Date Initial Notification was Submitted:

12. Initial Compliance Date: Startup: _____ Other: _____

13. Other Dates

Description: _____	Date: _____
Description: _____	Date: _____
Description: _____	Date: _____

Part E: Other Information

Part E identifies any additional information pertaining to the applicable federal rule. Attach additional information using form GSD-09 as necessary.

Large empty rectangular box for providing additional information.

From: [Rex Anderson](#)
To: [Palyshniuk, Kateryna](#)
Subject: RE: Applicant Review for MSOP Renewal No. 089-47394-00490 for Indiana Sugars, Inc.
Date: Wednesday, June 26, 2024 11:36:50 AM
Attachments: [image009.png](#)
[image010.png](#)
[image011.png](#)
[image012.png](#)
[image013.png](#)
[image014.png](#)
[image015.png](#)

**** This is an EXTERNAL email. Exercise caution. DO NOT open attachments or click links from unknown senders or unexpected email. ****

Good morning Kateryna,

I have reviewed the permit and do not have any comments at this time.

Thanks,

Rex Anderson
Indiana Sugars
Maintenance Manager
219-886-9151 ex:233
Cell: 219-290-6884
rexa@buysugars.com



From: Palyshniuk, Kateryna <KPalyshn@idem.IN.gov>
Sent: Wednesday, June 12, 2024 3:18 PM
To: Rex Anderson <rexa@buysugars.com>
Subject: RE: Applicant Review for MSOP Renewal No. 089-47394-00490 for Indiana Sugars, Inc.

CAUTION: CAUTION: This email originated from outside of Indiana Sugars. Do not click links or open attachments unless you recognize the sender. If you suspect this is spam, forward this email to spam@buysugars.com.

Hello Rex Anderson,

I am sorry, I forgot to include review for NSPS and NESHAP. Pursuant to 326 IAC 2-1.1-7, the fee for this permitting action is expected to be \$1,100, which is based on the following:

\$1,100	MSOP Renewal (review for an applicable NSPS and NESHAP)
---------	---

Best,
Kate

From: Palyshniuk, Kateryna

Sent: Wednesday, June 12, 2024 4:09 PM

To: Rex Anderson <rexa@buysugars.com>

Subject: Applicant Review for MSOP Renewal No. 089-47394-00490 for Indiana Sugars, Inc.

Importance: High

Dear Rex Anderson:

Attached is the draft MSOP Renewal and supporting documents for review. As a courtesy, this draft is being provided to you for an opportunity to review and provide comments prior to posting the public notice on IDEM's website. This supplemental step of providing you the draft permit does not take away your legal right to provide comments during the thirty (30) day comment period.

The time clock for MSOP Renewal No.: 089-47394-00490 will be stopped during your review until you either provide comments or indicate that you do not have any comments. Due to permit accountability and IDEM's intention to public notice the permit in a timely manner, you are being allotted two (2) weeks from today to provide comments in writing, email is sufficient. If you have any conflicts or special circumstances that would impede your review process during the time allotted, please notify me directly at the email address or phone number listed below as soon as possible. If you have not responded on or before **June 27, 2024**, IDEM will assume that you have no comments pertaining to this draft and all files will be forwarded for public notice.

During this review period, I will be available to address your concerns, answer any questions that you may have, or make necessary revisions to this draft.

Please send a reply email to me immediately confirming that you have received this draft version of the permit for review and that you are able to access these files in their current format.

The following documents are not included in this review but will be included during the public notice period:

Attachment A: 40 CFR 60, Subpart JJJJ

Attachment B: 40 CFR 63, Subpart ZZZZ

Pursuant to 326 IAC 2-1.1-7, the fee for this permitting action is expected to be \$100, which is based on the following:

\$100	MSOP Renewal
-------	--------------

Please note: This is not a bill. This represents the anticipated fee and is subject to change if additional review is required or the permit level changes for some reason (e.g. an additional NESHAP review is required). You will receive a final bill from the OAQ Permits Administration and Support Section.

Sincerely,

Kate



Indiana Department of
Environmental Management

Kateryna (Kate) Palyshniuk, Ph.D.
Environmental Manager

• (317) 234-0155 • KPalysn@idem.IN.gov

Protecting Hoosiers and Our Environment