



INDIANA DEPARTMENT OF ENVIRONMENTAL MANAGEMENT

We Protect Hoosiers and Our Environment.

100 N. Senate Avenue • Indianapolis, IN 46204
(800) 451-6027 • (317) 232-8603 • www.idem.IN.gov

Eric J. Holcomb
Governor

Brian C. Rockensuess
Commissioner

July 1, 2024

VIA EMAIL

Ms. Emma TerBeek
Engineer
Racer Trust Surface Impoundment
500 Woodward Ave, Ste. 1510
Detroit, Mi 48226

Re: Violation Letter
Racer Trust Surface Impoundment
INR000021436
Indianapolis, Marion County

Dear Ms. TerBeek:

On 6/25/2024, a representative of the Indiana Department of Environmental Management, Office of Land Quality, conducted an inspection of Racer Trust Surface Impoundment, located at 2701 W Raymond St, Indianapolis, IN. This inspection was conducted pursuant to IC 13-14-2-2. For your information, and in accordance with IC 13-14-5, a summary of the inspection is provided below:

Type of Inspection: Compliance Evaluation Inspection

Results of Inspection: Violations were discovered and require a submittal.

Within thirty (30) days of receipt of this letter, a written detailed explanation, documenting compliance with each of the requirements listed in the inspection report, must be submitted to this office. Failure to respond adequately to this Violation Letter may result in a referral to the OLQ Enforcement Section. Please direct any response to this letter and any questions to Matthew Peterschmidt at (219) 771-1011 or mpetersc@idem.in.gov. Thank you for your attention to this matter.

Sincerely,

for

Susan Lowry
Section Chief
Hazardous Waste Compliance Section
Compliance Branch

Enclosure

cc: Marion County Health Department



**HAZARDOUS WASTE
INSPECTION REPORT**
INDIANA DEPARTMENT OF
ENVIRONMENTAL MANAGEMENT

Inspector's Name:	Matthew Peterschmidt
Others Present	
Date:	Tuesday, June 25, 2024
Time In:	7:55 AM
Time Out:	9:05 AM
Inspection Type	Compliance Evaluation Inspection

General Information

Facility Information

Facility Name	Racer Trust Surface Impoundment
Facility Location	2701 W Raymond St Indianapolis, IN 46241 Marion County
Facility Mailing Information	500 Woodward Ave, Ste. 1510 Detroit, MI 48226
Facility Contact	Same as Primary Facility Contact
Primary Facility Contact During Inspection	Emma TerBeek Engineer (616) 914-4361 emma.terbeek@arcadis.com
Other Facility Contact(s) During Inspection	

Facility ID

EPA ID Number	INR000021436	NAICS Code	52592
---------------	--------------	------------	-------

Facility Status

File Status	Very Small Quantity Generator	Other Activities	
-------------	-------------------------------	------------------	--

Outstanding Issues

Last Inspection Date	7/1/2022
Previous Violations	<input type="radio"/> Yes <input checked="" type="radio"/> No
Details	

Inspection Narrative

RACER Trust is a closed hazardous waste surface impoundment that through closure was converted to a landfill. The site is currently managed by Arcadis and is in the southwestern portion of Indianapolis inside the boundaries of the Rolls-Royce Corporation Plant 5. Rolls-Royce Corporation Plant 5 is in a heavily industrialized area and is primarily engaged in the manufacture and testing of gas turbine engines and diesel engine components.

The former plant #5 surface impoundment site covers approximately ten acres. The surface impoundment previously received water from several sources prior to discharging to Eagle Creek under a NPDES permit (IN0001813). Influent to the surface impoundment during its 40 years of operation include run-off, boiler blowdown water, water softener rinse water, ash quenching water, non-contact cooling water, and effluent from the WWTP. IDEM determined the surface impoundment was used to treat F007 and F009 waste resulting in the impoundment being classified as a hazardous waste surface impoundment.

A Closure Plan was approved by IDEM in 1992. A Certification of Closure Report was submitted to IDEM in 1995, amended in 1996 and was accepted by IDEM and considered completed with the 30-year post-closure care period beginning June 4, 1996. Nine groundwater extraction wells are located inside the perimeter of the cap area. Sixteen hydraulic head monitoring wells are in pairs inside and outside of the cut-off wall. Additionally, three monitoring wells were installed outside of the containment area into the lower aquifer. The groundwater extraction system, hydraulic monitoring

Matthew Peterschmidt

Page 1 of 6 Racer Trust Surface Impoundment/Tuesday, June 25, 2024

systems, and cut off wall substitute for the leachate collection system. For more information about this system, please see Attachment C of the Post Closure Permit. A storm sewer is located around the perimeter of the cap area. A drainage ditch is located around the perimeter of the cap to collect storm water from both the cap area and from outside the perimeter that drains to the ditch. Any storm water that percolates through the vegetative cover and topsoil to the PVC liner will drain toward the edge of the cap to be collected by drainage piping which rests on top of the geonet and below the geotextile. The drainage piping connects to the perimeter drainage ditch on all edges of the cap. The drainage ditch connects to the storm sewer in the northeast and southwest corner of the cap.

The inspection conducted at the surface impoundment on 6/25/2024 included walking the cap to look for signs of erosion, settlement, differential settlement, slopes, subsidence and displacement. Permanent benchmarks, run-off control system, the condition of the grass, security fence, signage, integrity of the run-off/run-on control system, extraction well system, and gas venting system were also observed. Additionally, I reviewed the facility's inspections logs. See photos 15 and 16. Financial Assurance and Annual Reports are reviewed by others in IDEM's Permit Section.

Occasionally, mowers scalp small sections of the cap. Once observed, these sections are re-seeded to cover bare spots. See photos 2, 4, and 8. Vegetative growth was observed along the west side perimeter fence line. This growth comes from Rolls Royce property and has not impacted the fence integrity at the time of inspection. The site does spray to control vegetative growth along the perimeter fence. See photo #5.

The facility has a contract with a professional exterminator who provides pest control services at the site. The exterminator has multiple traps set throughout the facility for voles and groundhogs. Groundhogs occasionally create holes in the fence surrounding the site so the fence around the facility is maintained regularly and, in several places, had been patched prior to my inspection. A recent, un-repaired hole in the perimeter fence was observed in the northwest corner of the site, though this hole appears to have been man-made. See photo #1. The exterminator has also placed several vole traps around the cap near the observed vole activity. During my inspection I observed some vole networks that had vole traps in the vicinity and several groundhog holes that were equipped with traps. See photos 6,7, and 9 through 14. Animal activity has decreased year over year and the site is actively maintaining mitigation efforts.

A violation was observed and requires a submittal to this office within 30 days of receipt of this report.

Regulatory Status			
Observed Activity	Very Small Quantity Generator	Other Activities	Hazardous Waste Surface Impoundment
Documents Reviewed	Inspection Logs		
Comments			

Waste Management	
Comments:	
Waste Stream(s) Information	
Waste Streams	<input type="radio"/> Yes <input type="radio"/> No <input type="radio"/> Not Inspected <input checked="" type="radio"/> Not Applicable
List waste stream(s) information that varies from the most recent Annual Report (Example: additional waste streams, waste streams no longer generated, significant increase/decrease in generation rate, etc.)	
Exempted/Excluded	<input type="radio"/> Yes <input type="radio"/> No <input type="radio"/> Not Inspected <input checked="" type="radio"/> Not Applicable
Explanation	
Waste Management Areas	
Container Management Area(s)	<input type="radio"/> Yes <input type="radio"/> No <input type="radio"/> Not inspected <input checked="" type="radio"/> Not applicable
Satellite Area(s)	<input type="radio"/> Yes <input type="radio"/> No <input type="radio"/> Not inspected <input checked="" type="radio"/> Not applicable
Tanks, Restricted Waste Sites, and Other Regulated Units	

<p>Ignition/Reaction: "No Smoking" signs</p> <ul style="list-style-type: none"> <input type="checkbox"/> Conditions for Accumulation of Incompatible Wastes <input type="checkbox"/> Container Labeled "Hazardous Waste" <input type="checkbox"/> Container Marked with Indication of Hazards <input type="checkbox"/> Containers Marked with Accumulation Start Date <input type="checkbox"/> Tank Integrity Assessment <input type="checkbox"/> Tank Containment and Detection of Releases <input type="checkbox"/> Tank General Operating Requirements <input type="checkbox"/> Tank Inspections <input type="checkbox"/> Tank Subpart BB - Monthly Pump and Valve Monitoring <input type="checkbox"/> Tank Subpart CC - Annual Inspection/Monitoring <input type="checkbox"/> Tank Labeled "Hazardous Waste" <input type="checkbox"/> Tank Marked with Indication of Hazards <input type="checkbox"/> Tank Documentation for 90-Day Accumulation <input type="checkbox"/> Maintenance and Operation of Facility <input type="checkbox"/> Required Equipment <input type="checkbox"/> Testing and Maintenance of Equipment <input type="checkbox"/> Aisle Space <input type="checkbox"/> Arrangements with Local Authorities <input type="checkbox"/> Arrangements with Local Authorities - Documentation <input type="checkbox"/> Contingency Plan Developed <input type="checkbox"/> Content of Contingency Plan <input type="checkbox"/> Copies of Contingency Plan <input type="checkbox"/> Contingency Plan Quick Reference Guide <input type="checkbox"/> Emergency Coordinator <input type="checkbox"/> Personnel Training Program <input type="checkbox"/> Personnel Training - Complete Within Six Months <input type="checkbox"/> Personnel Training Annual Review <input type="checkbox"/> Personnel Training Documentation <input type="checkbox"/> Personnel Training Record Retention <input type="checkbox"/> Notification for Closure <input type="checkbox"/> Land Disposal Restrictions <input type="checkbox"/> Large Quantity Generator - Other Violations 	<ul style="list-style-type: none"> <input type="checkbox"/> Container Marked with Indication of Hazards <input type="checkbox"/> Container Marked with Accumulation Start Date <input type="checkbox"/> Tank Operating Conditions <input type="checkbox"/> Tank Inspections <input type="checkbox"/> Tank Labeled "Hazardous Waste" <input type="checkbox"/> Tank Marked with Indication of Hazardous <input type="checkbox"/> Tank Documentation for 180-Day Accumulation <input type="checkbox"/> Land Disposal Restrictions <input type="checkbox"/> Maintenance and Operation of Facility <input type="checkbox"/> Required Equipment <input type="checkbox"/> Testing and Maintenance of Equipment <input type="checkbox"/> Access to Communications or Alarm System <input type="checkbox"/> Aisle Space <input type="checkbox"/> Arrangements with Local Authorities <input type="checkbox"/> Arrangements with Local Authorities - Documentation <input type="checkbox"/> Emergency Coordinator <input type="checkbox"/> Emergency Information Posted <input type="checkbox"/> Employee Training <input type="checkbox"/> Other Small Quantity Generator Standards <p>VSQG Standards</p> <ul style="list-style-type: none"> <input type="checkbox"/> Hazardous Waste Generation Limit <input type="checkbox"/> Hazardous Waste Accumulation Limit <input type="checkbox"/> Hazardous Waste Determination <input type="checkbox"/> Proper Disposal <input type="checkbox"/> Prohibited Disposal of Liquids in Landfills
---	---

<p>Satellite Accumulation – SQG and LQG</p> <ul style="list-style-type: none"> <input type="checkbox"/> Quantity Limits, Point of Generation, Under Control of Operator 	<p>Manifest and Recordkeeping - LQG and SQG</p> <ul style="list-style-type: none"> <input type="checkbox"/> Manifest General Requirements <input type="checkbox"/> Use of the Manifest
---	---

<input type="checkbox"/> Container Condition <input type="checkbox"/> Compatibility with Container <input type="checkbox"/> Incompatible Wastes <input type="checkbox"/> Containers Closed <input type="checkbox"/> Container Labeled "Hazardous Waste" <input type="checkbox"/> Container Marked with Indication of Hazards <input type="checkbox"/> Preparedness and Prevention <input type="checkbox"/> Excess Generation	
---	--

Episodic Generation <input type="checkbox"/> Notification <input type="checkbox"/> EPA ID Number <input type="checkbox"/> Accumulate for 60 Days or Less <input type="checkbox"/> Accumulation Prohibitions <input type="checkbox"/> Container Labeling <input type="checkbox"/> Tank Labeling and Recordkeeping <input type="checkbox"/> Recordkeeping <input type="checkbox"/> Preparedness and Prevention <input type="checkbox"/> Other Violation	Hazardous Secondary Materials <input type="checkbox"/> Reclaimed Under Control of the Generator <input type="checkbox"/> Contained <input type="checkbox"/> Speculative Accumulation <input type="checkbox"/> Notice <input type="checkbox"/> Documentation of Legitimacy Determination <input type="checkbox"/> Emergency Preparedness and Response <input type="checkbox"/> Emergency Procedures (Accumulates 6,000 kg or Less) <input type="checkbox"/> Emergency Procedures (Accumulates Greater than 6,000 kg) <input type="checkbox"/> Other Violation
---	--

Solvent-Contaminated Wipes – Disposal <input type="checkbox"/> Container Management (Non-leaking containers) <input type="checkbox"/> Closed Containers <input type="checkbox"/> Labeling <input type="checkbox"/> Accumulation Time <input type="checkbox"/> No Free Liquids <input type="checkbox"/> Free Liquids Management <input type="checkbox"/> Documentation <input type="checkbox"/> Final Disposition	Solvent-Contaminated Wipes - Laundered or Dry Cleaned <input type="checkbox"/> Container Management (Non-leaking containers) <input type="checkbox"/> Closed Containers <input type="checkbox"/> Labeling <input type="checkbox"/> Accumulation Time <input type="checkbox"/> No Free Liquids <input type="checkbox"/> Free Liquids Management <input type="checkbox"/> Documentation <input type="checkbox"/> Clean Water Act
---	---

Universal Waste – All Facilities <input type="checkbox"/> Universal Waste Labeling <input type="checkbox"/> Containers - Closed, Good Condition, No Evidence of Leaks <input type="checkbox"/> Universal Waste - Bulb Crushing Prohibition	Used Oil – All Facilities <input type="checkbox"/> Rebuttable Presumption Applies <input type="checkbox"/> Containers and Tanks in Good Condition <input type="checkbox"/> Containers/Tank Labeling <input type="checkbox"/> Release Clean Up and Containment <input type="checkbox"/> Burning Restrictions - Generated On-site or DIY, .5M BTU
--	---

Description of Violation(s)

TSDF PERMIT REQUIREMENTS

TSDF PERMIT REQUIREMENTS

CITATION:

329 IAC 3.1-9 and 40 CFR 264.14(b) and (c): The Permittee shall comply with the security provisions described in the Post-Closure Plan, Attachment C.

DETAILS:

A hole was observed in the northwest corner of the perimeter fence by a overhead electrical pole and transformer. See photo #1.

REQUIRED ACTION:

Repair hole in security fence and submit evidence of repair to this office within 30 days of receipt of this report.

Inspection Documentation

Photographs	<input checked="" type="radio"/> Yes <input type="radio"/> No	
Map	<input checked="" type="radio"/> Maps	
GPS Location Collected	<input type="radio"/> Yes <input checked="" type="radio"/> No	
Analytical Screening Conducted	<input type="radio"/> Yes <input checked="" type="radio"/> No	
Lab Sample	<input type="radio"/> Yes <input checked="" type="radio"/> No	

Inspection Results/Actions

Comments:	
Inspection Results	
Violations were discovered and require a submittal.	
Multi-Media Concerns	
No concerns noted	

Finalize Inspection

Written Summary of Inspection		
Inspector Information	Printed/Typed Name	Matthew Peterschmidt
	Phone Number:	(219) 771-1011
	Email Address:	mpetersc@idem.in.gov
	Signature:	Obtained on the Inspection Verification/Findings Form
Facility Representative Signature	Printed/Typed Name:	Emma TerBeek
	Signature:	Obtained on the Inspection Verification/Findings Form

Photo Table: Racer Trust Surface Impoundment

	Number	1
	Description	Hole in northwest corner of perimeter fence by overhead electrical pole and transformer.
	Photographer	Matthew Peterschmidt
	Facility Name	Racer Trust Surface Impoundment
	Photo Date	06/25/2024
	Others	Emma TerBeek Arcadis U.S., Inc.

	Number	2
	Description	Reseeded area northwest corner on cap.
	Photographer	Matthew Peterschmidt
	Facility Name	Racer Trust Surface Impoundment
	Photo Date	06/25/2024
	Others	Emma TerBeek Arcadis U.S., Inc.



Number	3
Description	Extraction well 210 power box
Photographer	Matthew Peterschmidt
Facility Name	Racer Trust Surface Impoundment
Photo Date	06/25/2024
Others	Emma TerBeek Arcadis U.S., Inc.



Number	4
Description	Reseeded area west side on cap.
Photographer	Matthew Peterschmidt
Facility Name	Racer Trust Surface Impoundment
Photo Date	06/25/2024
Others	Emma TerBeek Arcadis U.S., Inc.



Number	5
Description	Vegetation on west side perimeter fence
Photographer	Matthew Peterschmidt
Facility Name	Racer Trust Surface Impoundment
Photo Date	06/25/2024
Others	Emma TerBeek Arcadis U.S., Inc.



Number	6
Description	Monitoring well 205A with vole bait container
Photographer	Matthew Peterschmidt
Facility Name	Racer Trust Surface Impoundment
Photo Date	06/25/2024
Others	Emma TerBeek Arcadis U.S., Inc.

	Number	7
	Description	Vole network south end midway between monitoring wells 205A and 204A
	Photographer	Matthew Peterschmidt
	Facility Name	Racer Trust Surface Impoundment
	Photo Date	06/25/2024
	Others	Emma TerBeek Arcadis U.S., Inc.

	Number	8
	Description	Bare spot on south cap south of monitoring well 204A
	Photographer	Matthew Peterschmidt
	Facility Name	Racer Trust Surface Impoundment
	Photo Date	06/25/2024
	Others	Emma TerBeek Arcadis U.S., Inc.



Number	9
Description	Settlement monument M8
Photographer	Matthew Peterschmidt
Facility Name	Racer Trust Surface Impoundment
Photo Date	06/25/2024
Others	Emma TerBeek Arcadis U.S., Inc.



Number	10
Description	Groundhog hole and trap, also vole holes on east side cap
Photographer	Matthew Peterschmidt
Facility Name	Racer Trust Surface Impoundment
Photo Date	06/25/2024
Others	Emma TerBeek Arcadis U.S., Inc.



Number	11
Description	Ground hog hole and trap, vole holes on east side cap west of extraction well 203
Photographer	Matthew Peterschmidt
Facility Name	Racer Trust Surface Impoundment
Photo Date	06/25/2024
Others	Emma TerBeek Arcadis U.S., Inc.



Number	12
Description	Ground hog hole and trap in drain middle of east side
Photographer	Matthew Peterschmidt
Facility Name	Racer Trust Surface Impoundment
Photo Date	06/25/2024
Others	Emma TerBeek Arcadis U.S., Inc.



Number	13
Description	Ground hog holes in need of bentonite refilling east side cap west of monitoring well 202 A
Photographer	Matthew Peterschmidt
Facility Name	Racer Trust Surface Impoundment
Photo Date	06/25/2024
Others	Emma TerBeek Arcadis U.S., Inc.



Number	14
Description	East side gas vent near middle of cap
Photographer	Matthew Peterschmidt
Facility Name	Racer Trust Surface Impoundment
Photo Date	06/25/2024
Others	Emma TerBeek Arcadis U.S., Inc.

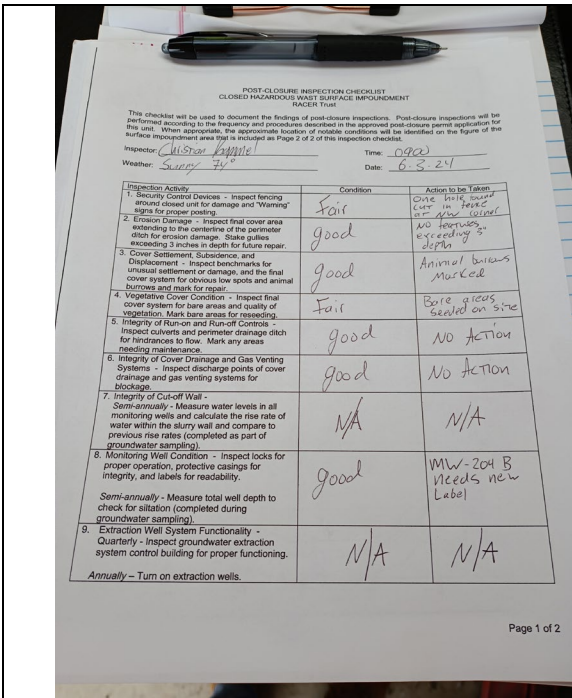

Number	15
Description	June 3, 2024 Inspection Log page 1
Photographer	Matthew Peterschmidt
Facility Name	Racer Trust Surface Impoundment
Photo Date	06/25/2024
Others	Emma TerBeek Arcadis U.S., Inc.

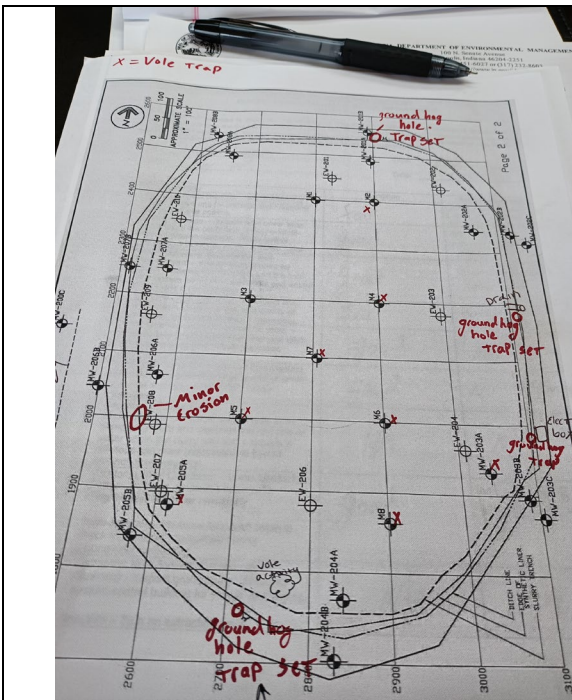

Number	16
Description	June 3, 2024 Inspection Log page 2
Photographer	Matthew Peterschmidt
Facility Name	Racer Trust Surface Impoundment
Photo Date	06/25/2024
Others	Emma TerBeek Arcadis U.S., Inc.

POST-CLOSURE INSPECTION CHECKLIST
CLOSED HAZARDOUS WASTE SURFACE IMPOUNDMENT
RACER TRUST

This checklist will be used to document the findings of post-closure inspections. Post-closure inspections will be performed according to the frequency and procedures described in the approved post-closure permit application for this unit. When appropriate, the approximate location of notable conditions will be identified on the figure of the surface impoundment area that is included as Page 2 of 2 of this inspection checklist.

Inspector: C. Maxime Time: 1000
Weather: Sunny 145°F Date: 3/28/24

Inspection Activity	Condition	Action to be Taken
1. Security Control Devices - Inspect fencing around closed unit for damage and "Warning" signs for proper posting.	clear	clear
2. Erosion Damage - Inspect final cover area extending to the centerline of the perimeter ditch for erosion damage. Stake gullies exceeding 2 inches in depth for future repair.	1 location found	restore erosion
3. Cover Settlement, Subsidence, and Displacement - Inspect benchmarks for unusual settlement or damage, and the final cover system for obvious low spots and animal burrows and mark for repair.	multiple voids - Filled 2 new Gambay holes - set traps	filled on site set traps
4. Vegetative Cover Condition - Inspect final cover system for bare areas and quality of vegetation. Mark bare areas for reseeding.	clear	clear
5. Integrity of Run-on and Run-off Controls - Inspect culverts and perimeter drainage ditch for hindrances to flow. Mark any areas needing maintenance.	clear	clear
6. Integrity of Cover Drainage and Gas Venting Systems - Inspect discharge points of cover drainage and gas venting systems for blockage.	clear	clear
7. Integrity of Cut-off Wall - Semi-annually - Measure water levels in all monitoring wells and calculate the rise rate of water within the slurry wall and compare to previous rise rates (completed as part of groundwater sampling).	/	/
8. Monitoring Well Condition - Inspect locks for proper operation, protective casings for integrity, and labels for readability. Semi-annually - Measure total well depth to check for siltation (completed during groundwater sampling). Extraction Well System Functionality - Quarterly - Inspect groundwater extraction system control building for proper functioning. Annually - Turn on extraction wells.	204 B, needs new label	/

Page 1 of 1

Number	17
Description	March 28, 2024 Inspection Log page 1
Photographer	Matthew Peterschmidt
Facility Name	Racer Trust Surface Impoundment
Photo Date	06/25/2024
Others	Emma TerBeek Arcadis U.S., Inc.

POST-CLOSURE INSPECTION CHECKLIST
CLOSED HAZARDOUS WASTE SURFACE IMPOUNDMENT
RACER TRUST

This checklist will be used to document the findings of post-closure inspections. Post-closure inspections will be performed according to the frequency and procedures described in the approved post-closure permit application for this unit. When appropriate, the approximate location of notable conditions will be identified on the figure of the surface impoundment area that is included as Page 2 of 2 of this inspection checklist.

Inspector: C. Maxime Time: 1000
Weather: Sunny 145°F Date: 3/28/24

Inspection Activity	Condition	Action to be Taken
1. Security Control Devices - Inspect fencing around closed unit for damage and "Warning" signs for proper posting.	clear	clear
2. Erosion Damage - Inspect final cover area extending to the centerline of the perimeter ditch for erosion damage. Stake gullies exceeding 2 inches in depth for future repair.	1 location found	restore erosion
3. Cover Settlement, Subsidence, and Displacement - Inspect benchmarks for unusual settlement or damage, and the final cover system for obvious low spots and animal burrows and mark for repair.	multiple voids - Filled 2 new Gambay holes - set traps	filled on site set traps
4. Vegetative Cover Condition - Inspect final cover system for bare areas and quality of vegetation. Mark bare areas for reseeding.	clear	clear
5. Integrity of Run-on and Run-off Controls - Inspect culverts and perimeter drainage ditch for hindrances to flow. Mark any areas needing maintenance.	clear	clear
6. Integrity of Cover Drainage and Gas Venting Systems - Inspect discharge points of cover drainage and gas venting systems for blockage.	clear	clear
7. Integrity of Cut-off Wall - Semi-annually - Measure water levels in all monitoring wells and calculate the rise rate of water within the slurry wall and compare to previous rise rates (completed as part of groundwater sampling).	/	/
8. Monitoring Well Condition - Inspect locks for proper operation, protective casings for integrity, and labels for readability. Semi-annually - Measure total well depth to check for siltation (completed during groundwater sampling). Extraction Well System Functionality - Quarterly - Inspect groundwater extraction system control building for proper functioning. Annually - Turn on extraction wells.	204 B, needs new label	/

Page 1 of 1

Number	18
Description	March 28, 2024 Inspection Log page 2
Photographer	Matthew Peterschmidt
Facility Name	Racer Trust Surface Impoundment
Photo Date	06/25/2024
Others	Emma TerBeek Arcadis U.S., Inc.

CITY\indiana\DIV\GROUP\SSR_DB\KGL_PML\Caprow_TAC\04\0
 C:\Users\kgastine@arcadis.com\Documents\Surface Impoundment Site_170213.dwg LAYOUT:1 SAVE:2:214:2017 2:31 AM AG:DWG:15:15 (LMS TECH) PAGESETUP: PLOTSTYLETABLE: PLOTSTYLETABLE: PLOTTED:214:2017 2:31 AM BR:GASTINE@LYONS.HEATHER

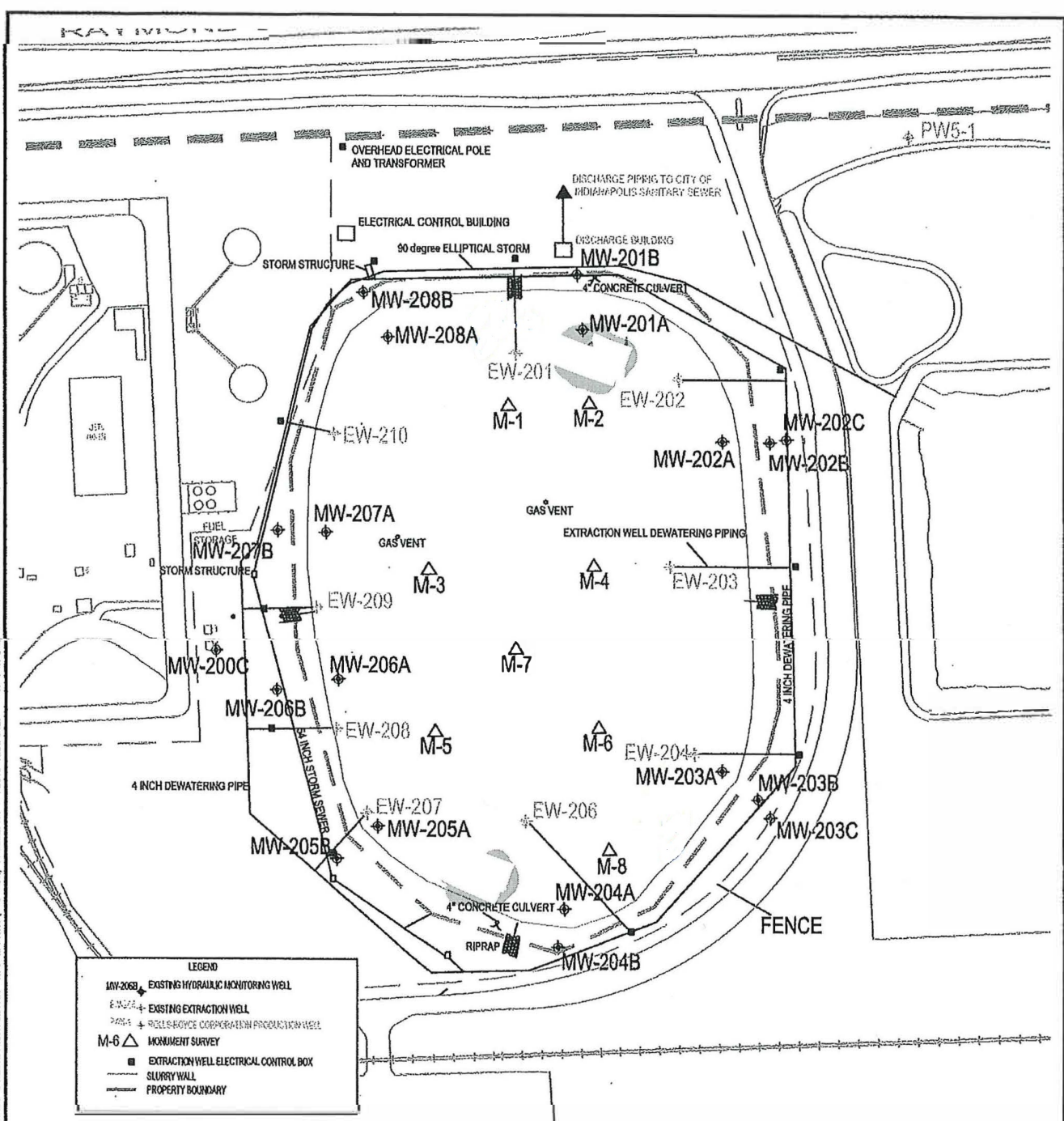

LEGEND

- MW-203A EXISTING HYDRAULIC MONITORING WELL
- EW-201 EXISTING EXTRACTION WELL
- MW-204A RACER TRUST COOPERATION PRODUCTION WELL
- M-6 MONUMENT SURVEY
- EXTRACTION WELL ELECTRICAL CONTROL BOX
- SURVEY WALL
- PROPERTY BOUNDARY

NOTE: PIPING AND BUILDING LOCATIONS ARE APPROXIMATE.

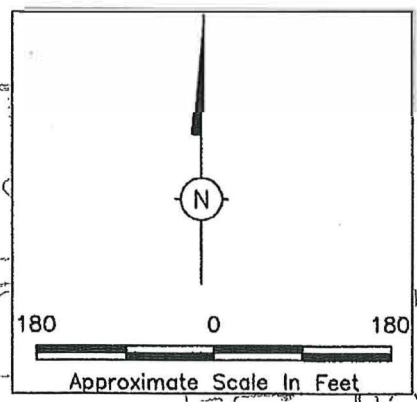

RACER TRUST
 INDIANAPOLIS, INDIANA

SITE MAP

ARCADIS Design & Consultancy
 for natural and built assets

FIGURE
1



INSPECTION VERIFICATION/FINDINGS

INDIANA DEPARTMENT OF ENVIRONMENTAL MANAGEMENT

100 N. Senate Avenue
Indianapolis, Indiana 46204-2251
Telephone: (800) 451-6027 or (317) 232-8603
Web Page: http://www.in.gov/idem/

On 6/25/2024 an inspection of RACER TRUST was conducted by the undersigned representative of the Indiana Department of Environmental Management (IDEM), Office of Land Quality.

Type of Inspection (may include more than one):

- Checkboxes for Routine Compliance Evaluation, Follow Up Inspection, Compliance Assistance Inspection, Complaint, Multi-Media Screening Evaluation, and Other.

Inspection Findings:

These findings are considered preliminary and identify specific compliance issues discovered during the above-noted inspection that the designated agent of IDEM believes may be a violation of a statute(s), rule(s) or permit(s) issued by IDEM.

- Checkboxes for No violations were discovered, Violations were discovered but corrected, Violations were discovered and require a submittal, Violations were discovered and may subject you to an appropriate enforcement response, Additional information/review is required, and Other/Comments.

Confidential Information

In accordance with 329 IAC 6.1 (http://www.in.gov/legislative/iac/T03290/A00061.PDF) a person submitting information to the department for which confidential treatment is requested shall make a written claim of confidentiality at the time of submittal of the information.

Notice of Oral Report

In accordance with IC 13-14-5 an oral report of the inspection was provided to the undersigned Owner/Agent at the conclusion of the inspection. The oral report includes any specific matters discovered during the inspection that the IDEM representative believes may be a violation of a law or of a permit issued by the department.

IDEM Representative:

Signature block for Matthew Peter Schmidt, including printed name, signature, phone number, email, and date/time in/out.

Owner/Representative:

Signature block for Emma TerBeck, including printed name, signature, phone number, email, and date.

IDEM prefers to email your report. Please check this box to indicate you prefer to receive a copy of the inspection report via U.S. mail: []